

advanced FLOW engineering

Turbo Inlet Pipes

Instruction Manual P/N: 55-20001 (Black) / 55-20001-R (Red)

Make: TOYOTA	Model: TUNDRA	Year: 2022-2024	Engine: V6-3.4L(tt)
Make: TOYOTA	Model: SEQUOIA	Year: 2023-2024	Engine: V6-3.4L(tt)
Make: TOYOTA	Model: LAND CRUISER (J300)*	Year: 2022-2024	Engine: V6-3.4L(tt)
Make: LEXUS	Model: LX600	Year: 2022-2024	Engine: V6-3.4L(tt)
Make: LEXUS	Model: GX550	Year: 2024-2025	Engine: V6-3.4L(tt)

* Non-US Model

(This part will only fit with aFe POWER Air Intake System)



- Please read the entire instruction manual before proceeding.
- Ensure all components listed are present.
- If you are missing any of the components, call customer support at 951-493-7185.
- Ensure you have all necessary tools before proceeding.
- Do not attempt to work on your vehicle when the engine is hot.
- Retain factory parts for future use.

Label	Qty.	Description	Part Number
A	1	Turbo Inlet Pipe (Driver Side), Black (For 55-20001)	05-5920010B1
A	1	Turbo Inlet Pipe (Driver Side), Red (For 55-20001-R)	05-5920010R1
B	1	Turbo Inlet Pipe (Passenger Side) , Black (For 55-20001)	05-5920010B2
B	1	Turbo Inlet Pipe (Passenger Side) , Red (For 55-20001-R)	05-5920010R2
C	2	Clamp, SmartSeal, #044	03-50656
D	2	Clamp, SmartSeal, #052	03-50786
E	2	Isolation Mount, 1/2" H	03-50664
F	4	Aluminum Spacer: 1/4" ID x 1/4" L	05-01722

Installation will require the following tools:

8mm and 10mm Nut Drivers or Ratchet and Sockets, Pliers

Warranty Information available at: <https://afepower.com/contact#warranty>

Emissions Disclaimer: This product is not currently CARB exempt and is not available for purchase in California or for use on any vehicle registered with the California Department of Motor Vehicles.

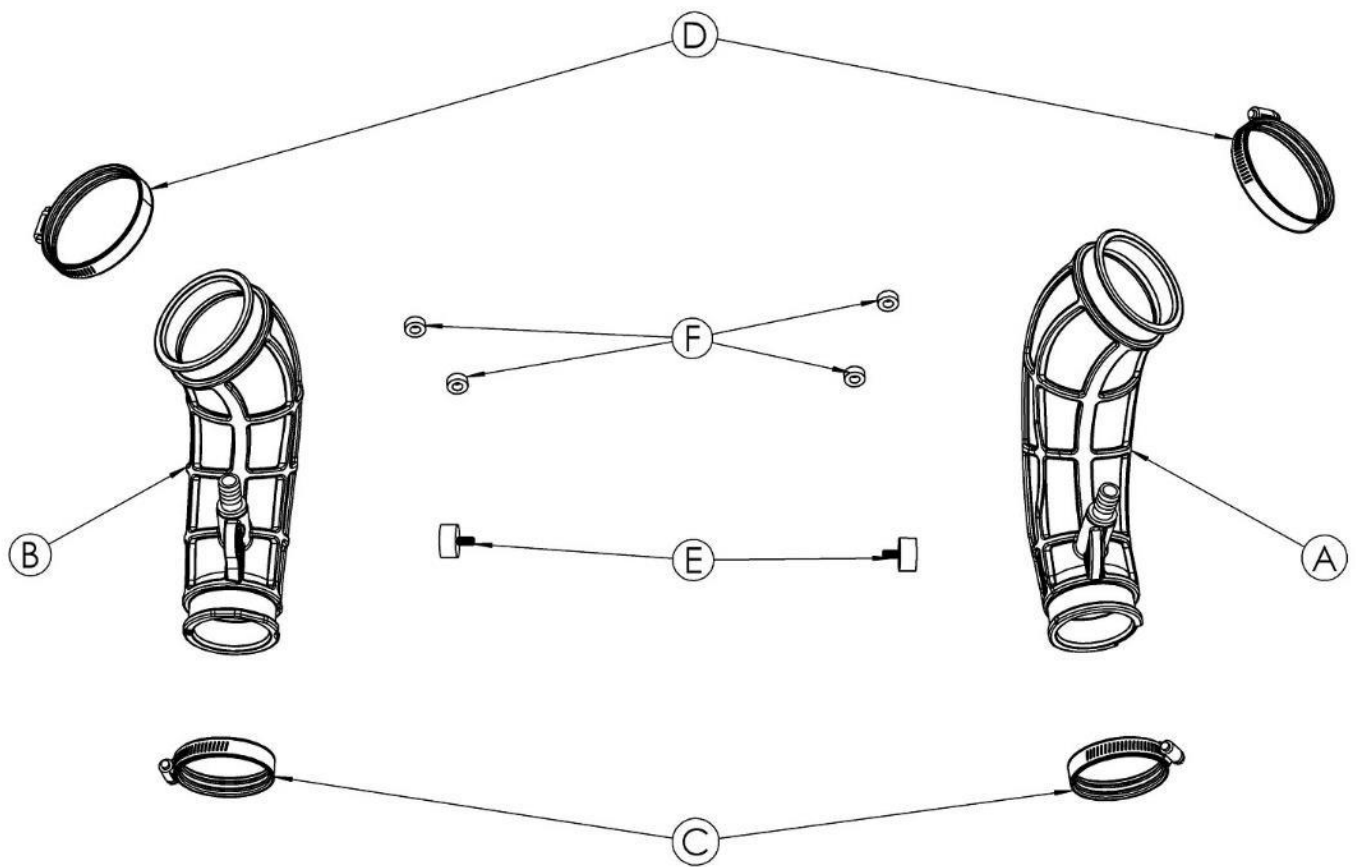



Refer to Figure A for Steps 1-3

(Toyota Tundra shown in the pictures, other applications will be similar)

Step 1: Remove the engine cover.

Step 2: Disconnect the passenger side Mass Air Flow (MAF) sensor.

Step 3: Loosen the clamps securing the intake tube from the filter and the coupling, using an 8mm socket or nut driver. Then remove the intake tube.

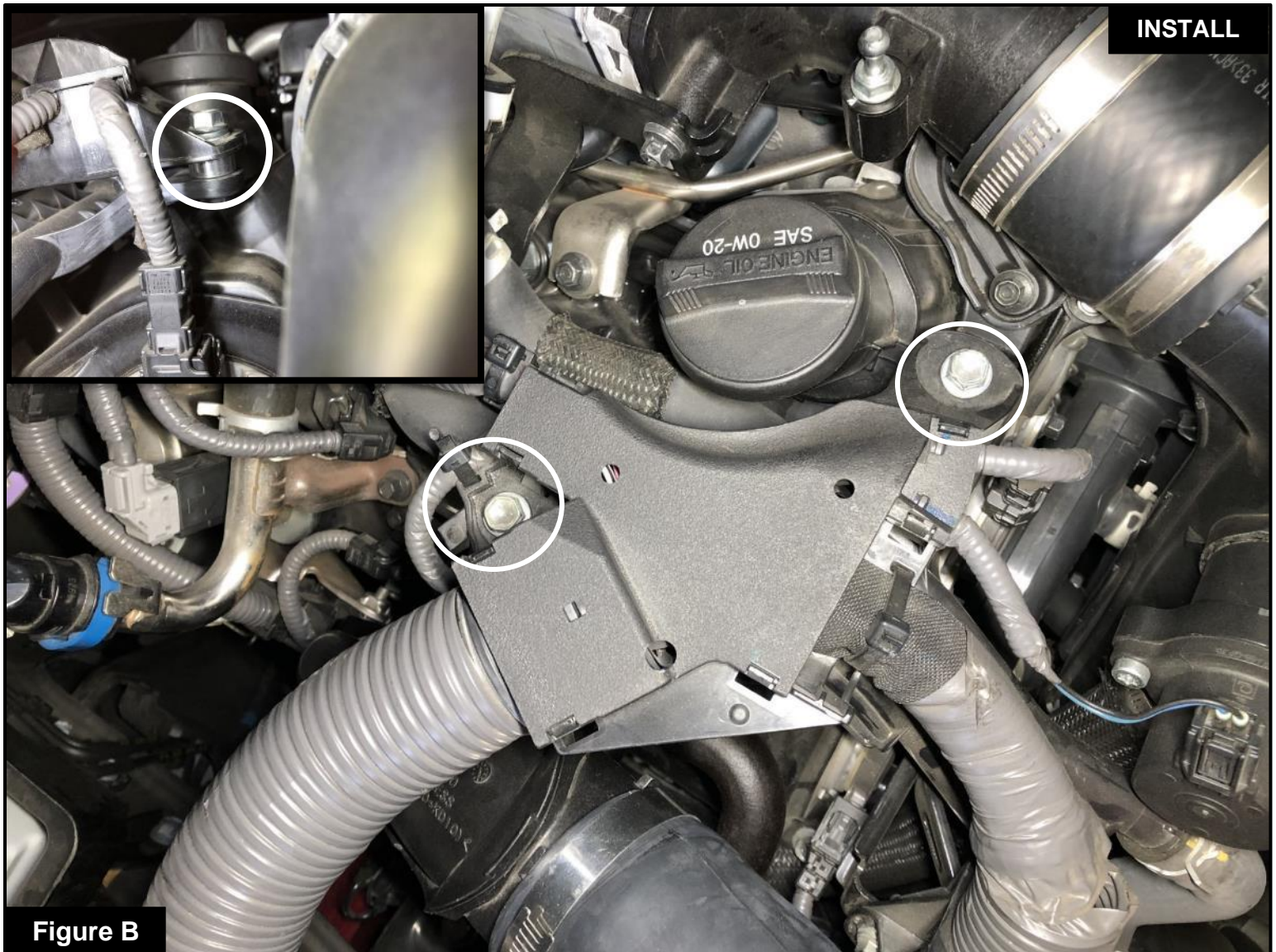

Refer to Figure B for Steps 4-5

Step 4: Remove the two bolts securing the harness to the engine using a 10mm nut driver or socket.

Step 5: Add the two spacers in between the harness bracket and re-install the factory bolts to secure it back down.



Figure C

Refer to Figure C for Steps 6-9

Step 6: Loosen the factory turbo inlet pipe clamp using a 10mm nut driver/socket.

Step 7: Remove the bolt securing the factory turbo inlet pipe to the engine. This bolt will be re-used.

Step 8: Using pliers, squeeze the hose clamp and remove the hose from the turbo inlet pipe. This clamp will be re-used.

Step 9: Carefully remove factory turbo inlet pipe from the vehicle.

INSTALL



Figure D

Refer to Figure D for Step 10

Step 10: : Install the passenger side isolation mount onto factory turbo inlet pipe mounting point. Refer to **step 7** for placement.

Figure E

Refer to Figure E for Step 11-15

Step 11: Locate the passenger side aFe POWER turbo inlet (05-5920010B2) and place the small clamp on the turbo inlet side and the bigger clamp on the intake tube side. Do not tighten at this time.

Step 12: Install aFe POWER turbo inlet pipe over the turbo inlet.

Step 13: Orient the turbo inlet pipe correctly then secure it to the engine using the factory bolt (removed at step 7) using a 10mm nut driver/socket.

Step 14: Re-connect the factory hose to the turbo inlet pipe fitting. Use factory clamp to secure hose.

Step 15: Re-install the aFe POWER intake tube and tighten all clamps. Including the one securing the aFe POWER turbo inlet pipe to the turbo inlet on the engine. Make sure to re-connect the MAF sensor.

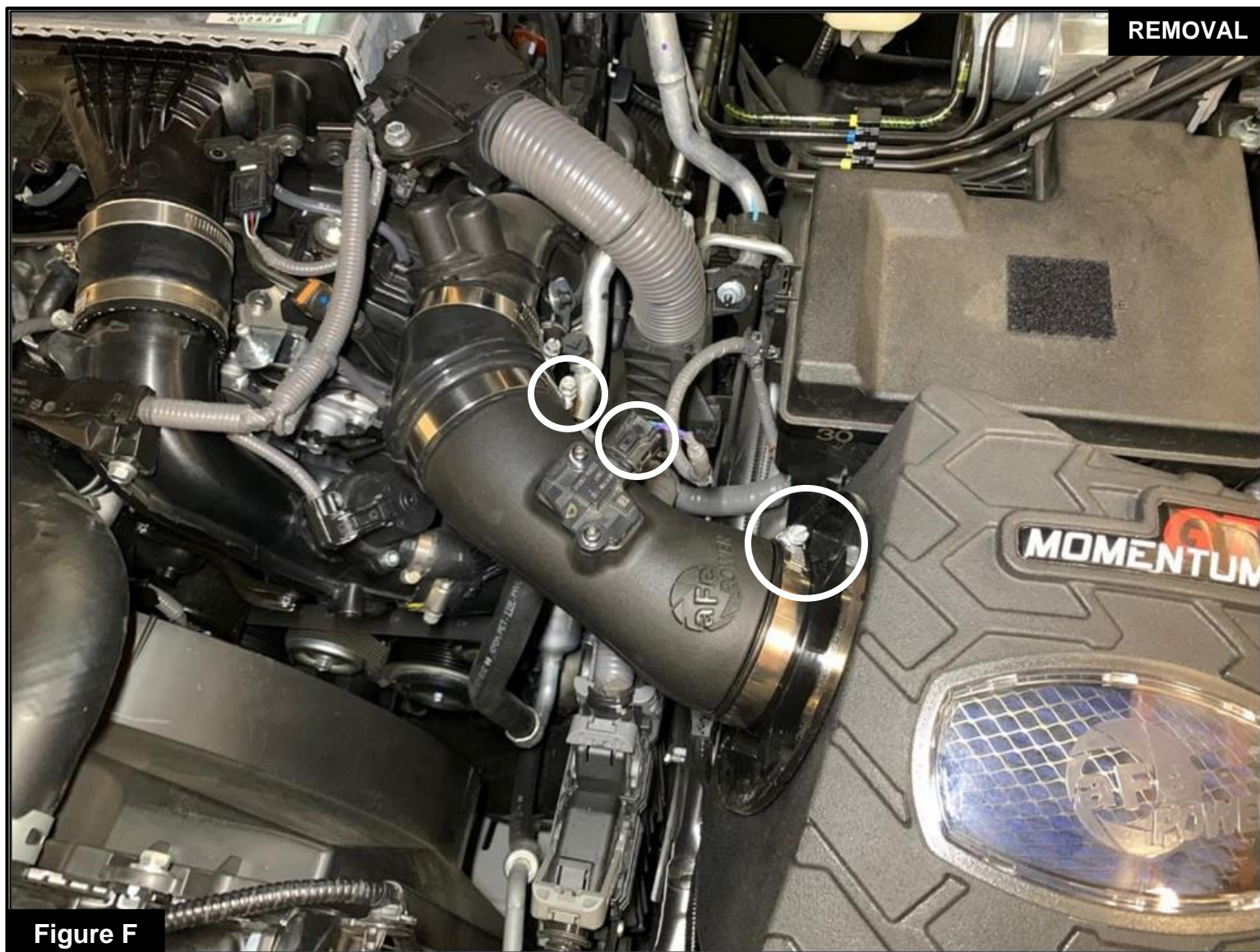

Figure F

Refer to Figure F for Step 16

(Toyota Tundra shown in the pictures, other applications will be similar)

Step 16: Refer to steps 1-3 to remove intake tube on the driver's side.



Figure G

Refer to Figure G for Steps 17-18

Step 17: Remove the two bolts securing the engine harness using a 10mm nut driver or socket.

Step 18: Add the two spacers between the harness bracket and re-install the factory bolts to secure it back down.



Figure H

Refer to Figure H for Steps 19-21

Step 19: Loosen the clamp using a 10mm nut driver/socket.

Step 20: Detach hose from plastic clip.

Step 21: Using pliers, squeeze the hose clamp and remove it from the turbo inlet pipe. This clamp will be re-used.



Figure I

Refer to Figure I for Step 22-24

Step 22: Detach hose from the second plastic clip.

Step 23: Remove the bolt securing the turbo inlet bracket using an 8mm socket. This bolt will be re-used, and the bracket will not be re-installed with the aFe POWER turbo inlet (Save the bracket with your factory turbo inlet parts).

Step 24: Remove factory turbo inlet pipe from vehicle.



Figure J

Refer to Figure J for Step 25-29

Step 25: Install the driver side isolation mount onto factory turbo inlet pipe mounting point.

Step 26: Locate the Driver side aFe POWER turbo inlet (05-5920010B1) and place one of the small clamp on the turbo inlet side and the big clamp on the aFe POWER tube end. Do not tighten at this time.

Step 27: Install aFe POWER turbo inlet pipe over the turbo inlet. Orient the turbo inlet pipe correctly then secure it to the engine using the factory bolt (removed at step 23) using an 8 mm nut driver/socket.

Step 28: Re-connect the factory hose to the turbo inlet pipe fitting. Use factory clamp to secure hose.

Step 29: Re-install the intake tube and tighten all clamps. Including the one securing the aFe POWER turbo inlet pipe to the turbo inlet on the engine. Make sure to re-connect the MAF sensor.



Figure K

Refer to Figure K for Steps 30-31

(Toyota Tundra shown in the pictures, other applications will be similar)

Step 30: Re-install the engine cover.

Step 31: Make sure all clamps and connections are secured. Your installation is now complete. Thank you for choosing aFe POWER!



Page left blank intentionally



advanced FLOW engineering, Inc.

Corona, CA 92879

<https://afepower.com/contact>