



VERTEX Coilover Adjusting Wrenches

Thank you for choosing Rough Country for all your vehicle needs.

Please read instructions before beginning installation. Check the kit hardware against the kit contents shown below. Be sure you have all needed parts and know where they go.

If question exist, please call us @1-800-222-7023. We will be happy to answer any questions concerning this product.

Check all fasteners for proper torque. Check to ensure for adequate clearance between all components.

Check and retighten wheels at 50 miles and again at 500 miles. Periodically check all hardware for tightness.

⚠ WARNING To prevent damage to the shock or bodily harm, All of the load must be removed from the coil spring seat before the jam nut is loosened.

KIT CONTENTS:
1-COILOVER ADJUSTING WRENCH

TOOLS NEEDED:
FLOOR JACK
JACK STANDS
OUTER COIL COMPERSOR
OR A
WALL MOUNTED STRUT
COMPRESSOR
WHEEL CHOCKS



Torque Specs:

Size	Grade 5	Grade 8	Size	Class 8.8	Class 10.9
5/16"	15 ft/lbs	20ft/lbs	6MM	5ft/lbs	9ft/lbs
3/8"	30 ft/lbs	35ft/lbs	8MM	18ft/lbs	23ft/lbs
7/16"	45 ft/lbs	60ft/lbs	10MM	32ft/lbs	45ft/lbs
1/2"	65 ft/lbs	90ft/lbs	12MM	55ft/lbs	75ft/lbs
9/16"	95 ft/lbs	130ft/lbs	14MM	85ft/lbs	120ft/lbs
5/8"	135ft/lbs	175ft/lbs	16MM	130ft/lbs	165ft/lbs
3/4"	185ft/lbs	280ft/lbs	18MM	170ft/lbs	240ft/lbs



1. Prior to adjusting the coilover, with the vehicle on the ground, measure the heights of your vehicle. This measurement can be recorded from the center of the wheel straight up to the top of the inner fender lip. Record the measurements.

LF: _____ ,RF: _____ ,

LR: _____ ,RR: _____

2. Place vehicle in park and chock the rear wheels. Raise the front of the vehicle with a jack and secure a jack stand beneath each frame rail behind the front control arms. Ease the frame down onto the stands.
3. This adjustment needs to be at full droop with an outside mounted coil spring compressor attached to the coil or removed from the vehicle and compressed in a wall mounted coil spring compressor as shown in the photos below.
4. Before you start your adjustment, identify the jam nut and the coil spring seat. **Photo 1.**
5. Compress the coil to relieve the load from the coil spring seat. This was performed in a in a wall mounted coil spring compressor. **See Photo 2.**

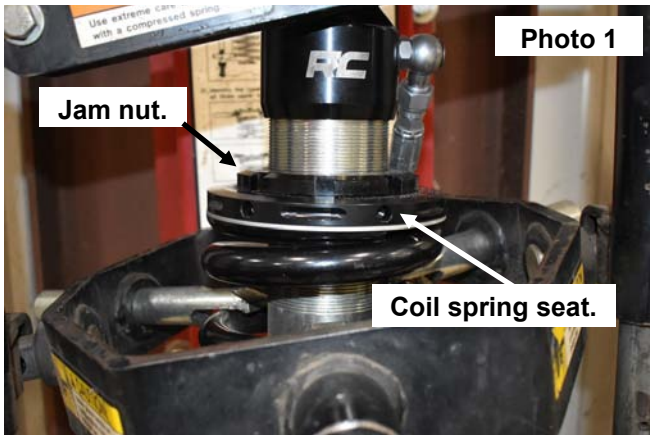

6. Once the load has been relieved from the coil spring seat, loosen the jam nut, using the supplied adjusting wrench. **See Photo 3.**
7. Lock the supplied adjusting wrench into the hole on the coil spring seat, turn the coil spring seat to achieve the desired ride height. **See Photo 4.**
8. Once your ride height has been achieved, check the CV shafts before driving. With the vehicle off of the ground rotate the driver and passengers wheels to assure the CV shaft is not bound up at full droop.
9. Once the ride height has been set, tighten the jam nut, using the supplied adjusting wrench.

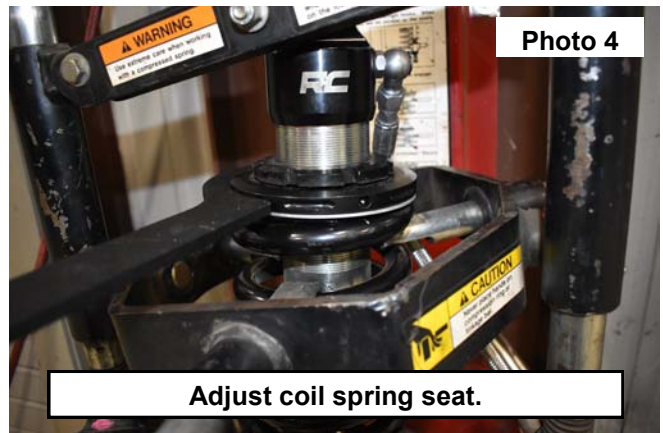

By purchasing any item sold by Rough Country, LLC, the buyer expressly warrants that he/she is in compliance with all applicable , State, and Local laws and regulations regarding the purchase, ownership, and use of the item. It shall be the buyers responsibility to comply with all Federal, State and Local laws governing the sales of any items listed, illustrated or sold. The buyer expressly agrees to indemnify and hold harmless Rough Country, LLC for all claims resulting directly or indirectly from the purchase, ownership, or use of the items.



ROUGH COUNTRY

SUSPENSION SYSTEMS®

TOYOTA 2022-23 Tundra Front Vertex Strut

Thank you for choosing Rough Country for all your vehicle needs.

Please read instructions before beginning installation. Check the kit hardware against the kit contents shown below. Be sure you have all needed parts and know where they go.

If question exist, please call us @1-800-222-7023. We will be happy to answer any questions concerning this product. Check all fasteners for proper torque. Check to ensure for adequate clearance between all components. Periodically check all hardware for tightness.

KIT CONTENTS:

Driver Side Vertex Shock x1
 Pass Side Vertex Shock x1
 Driver Side Mounting Bracket x1
 Pass Side Mounting Bracket x1
 Driver Side Reservoir Bracket x1
 Pass Side Reservoir Bracket x1
 Clamps x4

HARDWARE INCLUDED:

10mm-1.5 Hex Head Bolts x8
 10mm Lock Washers x8
 10mm Flat Washers x8
 8mm Clips x4
 8-1.25 x 20mm Bolts x4
 8mm Washer x4

TOOLS NEEDED:

Jack
 Jack Stands
 10mm Wrench
 12mm Wrench
 17mm Wrench
 19mm Wrench
 22mm Wrench and Socket
 24mm Wrench
 Hammer
 Ratchet



Torque Specs:

Size	Grade 5	Grade 8	Size	Class 8.8	Class 10.9
5/16"	15 ft/lbs	20ft/lbs	6MM	5ft/lbs	9ft/lbs
3/8"	30 ft/lbs	35ft/lbs	8MM	18ft/lbs	23ft/lbs
7/16"	45 ft/lbs	60ft/lbs	10MM	32ft/lbs	45ft/lbs
1/2"	65 ft/lbs	90ft/lbs	12MM	55ft/lbs	75ft/lbs
9/16"	95 ft/lbs	130ft/lbs	14MM	85ft/lbs	120ft/lbs
5/8"	135ft/lbs	175ft/lbs	16MM	130ft/lbs	165ft/lbs
3/4"	185ft/lbs	280ft/lbs	18MM	170ft/lbs	240ft/lbs



INSTALLATION INSTRUCTONS

1. Raise the front of the vehicle up using a jack and place jack stands under the frame rail. Lower the vehicle onto the jack stands.
2. Remove the wheels and tires from the vehicle.
3. Take ABS wire loose from upper control arm using a 10mm wrench & ABS/ brake line on the knuckle using a 12mm wrench. Retain the stock hardware.
4. Remove the pin from the tie rod end. **See Photo 1.**
5. Using a 24mm wrench loosen the tie rod end. **See Photo 2.**

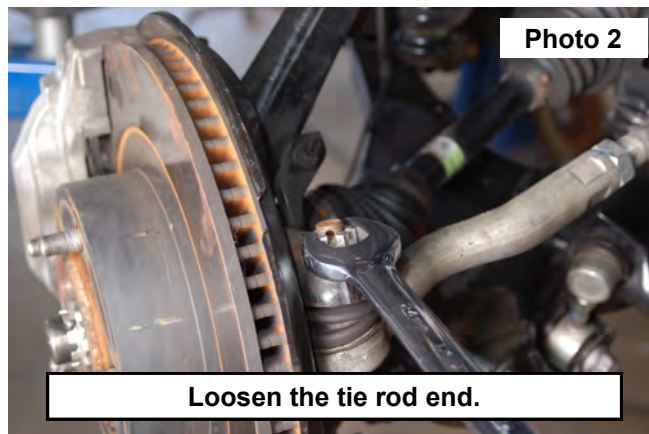
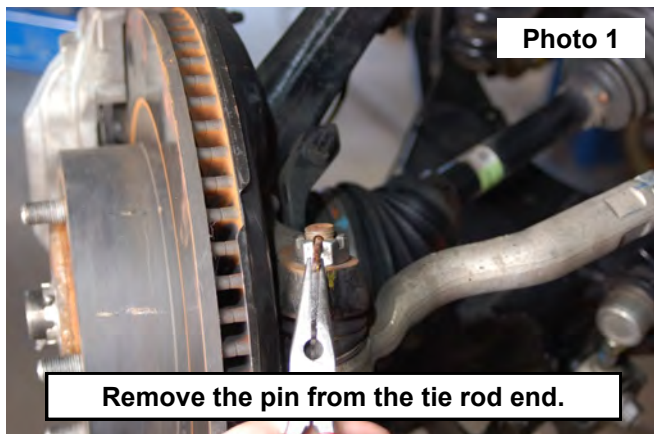

6. Use a hammer to unseat the tie rod end from the knuckle. Then remove the nut and the tie rod end from the knuckle. Retain hardware. **See Photo 3.**
7. Remove the pin from the upper ball joint. **See Photo 4.**

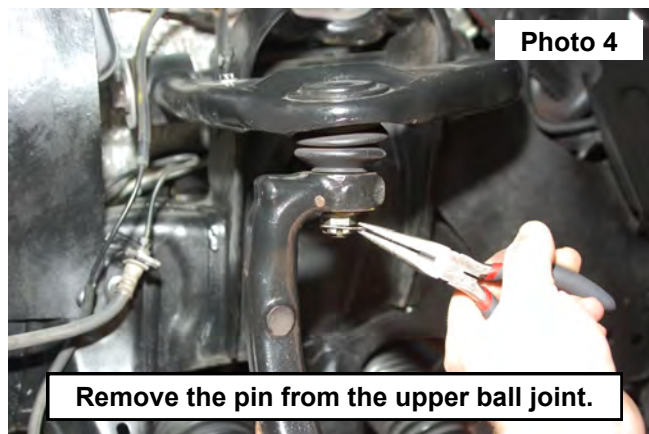
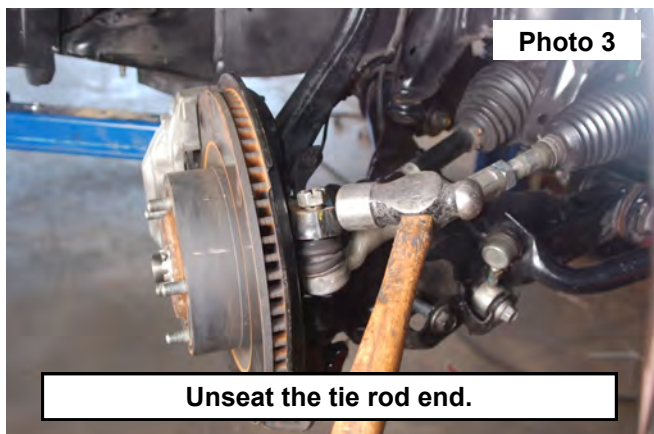

8. Using a 19mm wrench loosen the upper ball joint. **See Photo 5.**
9. Use a hammer to unseat the upper ball joint from the knuckle. Then remove the nut and the upper ball joint from the knuckle. Retain hardware. **See Photo 6.**

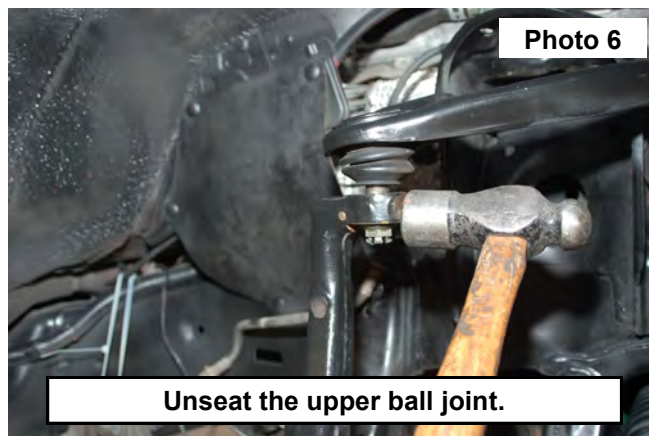
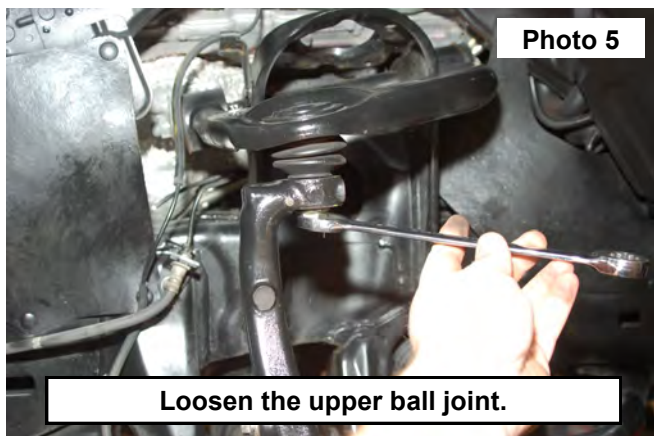

10. Remove the bolt and nut from the lower control arm strut mount using a 22mm wrench and socket. **See Photo 7.**
11. Remove the 4 nuts from the top of the strut using a 14mm wrench. **See Photo 8.**
12. Remove the strut from the vehicle.



13. Install the vertex strut in to the upper frame mount using the supplied 10mm hardware. Tighten using a 17mm wrench. **See Photos 9 and 10.**

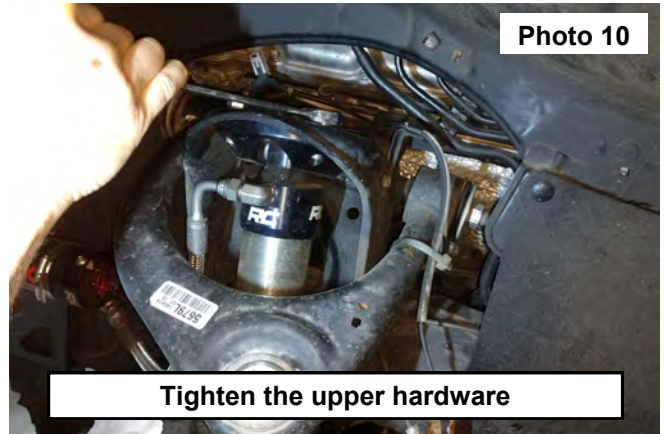

14. Install the lower strut in to the lower control arm mount. Tighten using a 22mm wrench and socket. **See Photo 11.**
15. Connect the upper ball joint to the knuckle and tighten using a 19mm wrench. Reinstall the retained pin. **See Photo 12.**

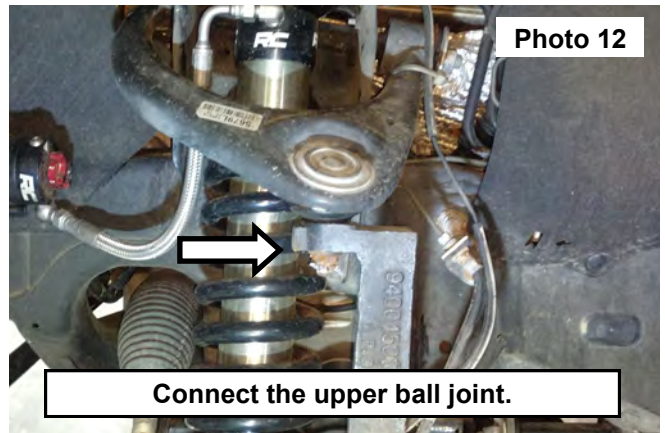
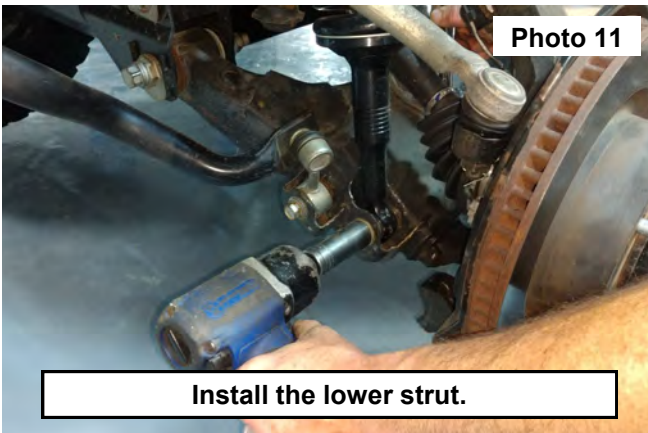

16. Connect the tie rod end to the knuckle. Tighten using a 24mm wrench. Then reinstall the pin. **See Photo 13.**
17. Install the ABS wire onto the upper control arm using a 10mm wrench and the ABS/ brake line on the knuckle using a 12mm wrench.
18. Remove the plug from the frame and the (2) push pins from the dust shield using straight end plyers. **See Photo 14.**

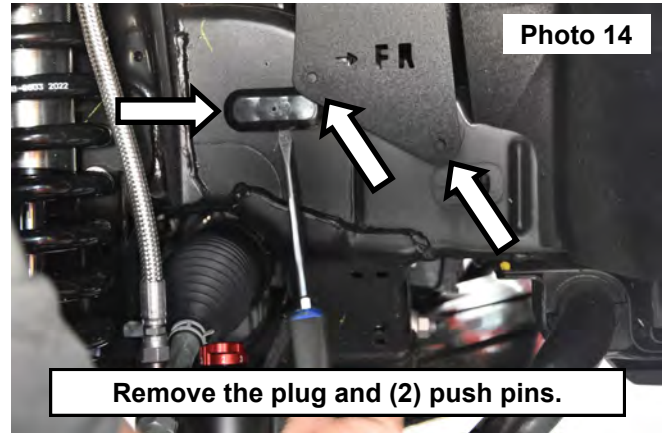
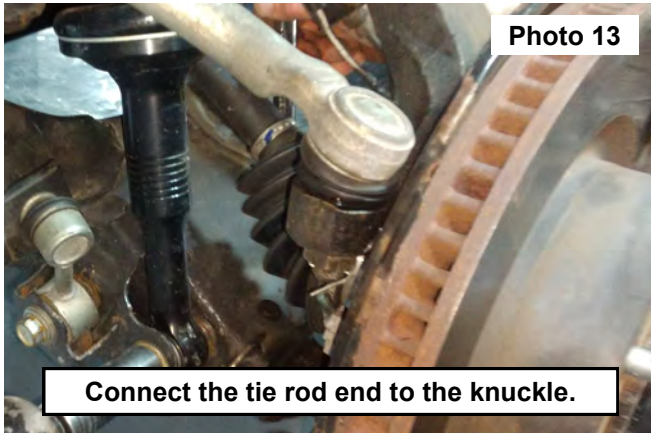

19. Install the (2) clips onto the mounting plate. **See Photo 15.**
20. Install the mounting plate into the frame, then place the dust shield and the reservoir bracket onto the frame and secure using the (2) supplied bolts and lock washers. **See Photos 16 and 17.**



21. Place the clamps into the bracket and install the reservoir into the clamps. Then secure the reservoir into place, tightening the clamps. (Passenger side shown.) **See Photo 18.**
22. Install the wheels and tires.
23. Use a jack to raise the vehicle up and remove the jack stands. Lower onto the ground.

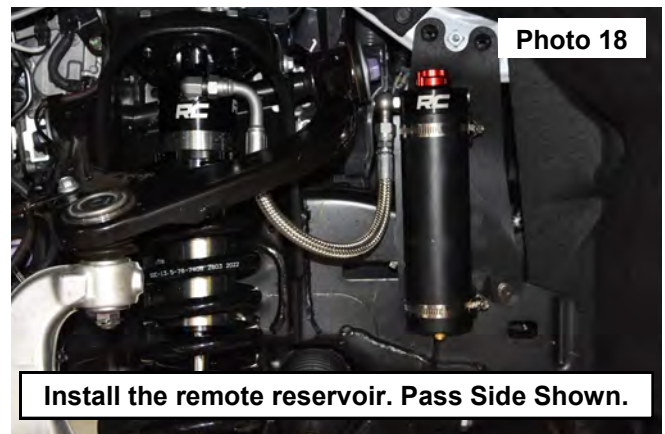
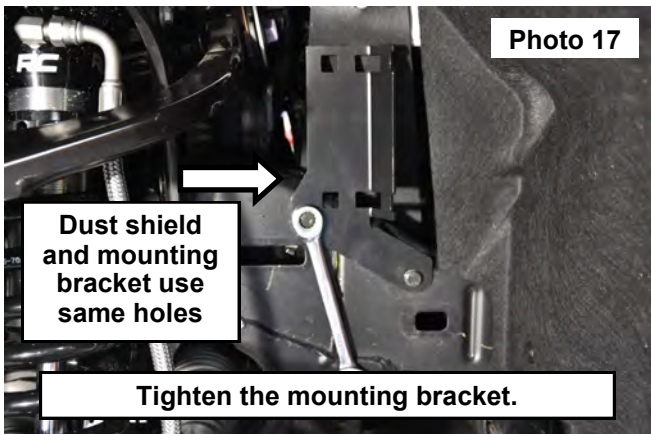

By purchasing any item sold by Rough Country, LLC, the buyer expressly warrants that he/she is in compliance with all applicable, State, and Local laws and regulations regarding the purchase, ownership, and use of the item. It shall be the buyers responsibility to comply with all Federal, State and Local laws governing the sales of any items listed, illustrated or sold. The buyer expressly agrees to indemnify and hold harmless Rough Country, LLC for all claims resulting directly or indirectly from the purchase, ownership, or use of the items.

