



---

# SOFT BED TOPPER

---

## INSTALLATION INSTRUCTIONS

### CONTENTS

---

- (1) Topper Canvas Assembly  
w/ Front Window
- (1) Rear Window Panel
- (1) LH Side Wall
- (1) RH Side Wall
- (1) LH Bow Assembly
- (1) RH Bow Assembly
- (1) LH Side Rail
- (1) RH Side Rail
- (1) Front Window Rail
- (1) Rear Window Rail
- (1) Bulkhead Seal
- (1) Tailgate Seal
- (4) Coupler Tubes
- (4) Side Rail Clamp Assemblies
- (4) M6x1.00 x 16mm Allen Bolts
- (4) M6 Flat Washers
- (4) M6x1.00 x 12mm Tapered Allen Bolts
- (4) M6 Lock Nuts
- (1) 5mm Allen Key
- (1) 8mm Allen Key

### TOOLS REQUIRED

---

- 10mm Wrench
- Rubber Hammer
- Isopropyl Alcohol
- Microfiber Cloth



### STEP 1

Begin by unpacking and assembling the side rails. The front and rear of each side rail are packaged together. Connect the side rails by sliding the male portion onto the top of the other side rail, and secure into place using the (2) M6 x 12mm Tapered Allen bolts and (2) M6 lock nuts.



### STEP 2

Secure, but do not fully tighten each side rail to the vehicle bed rails using the included (2) clamp assemblies per side. The 90° bend will fit to the rear of the vehicle. Installing the side rails loosely is important for adjustments later.

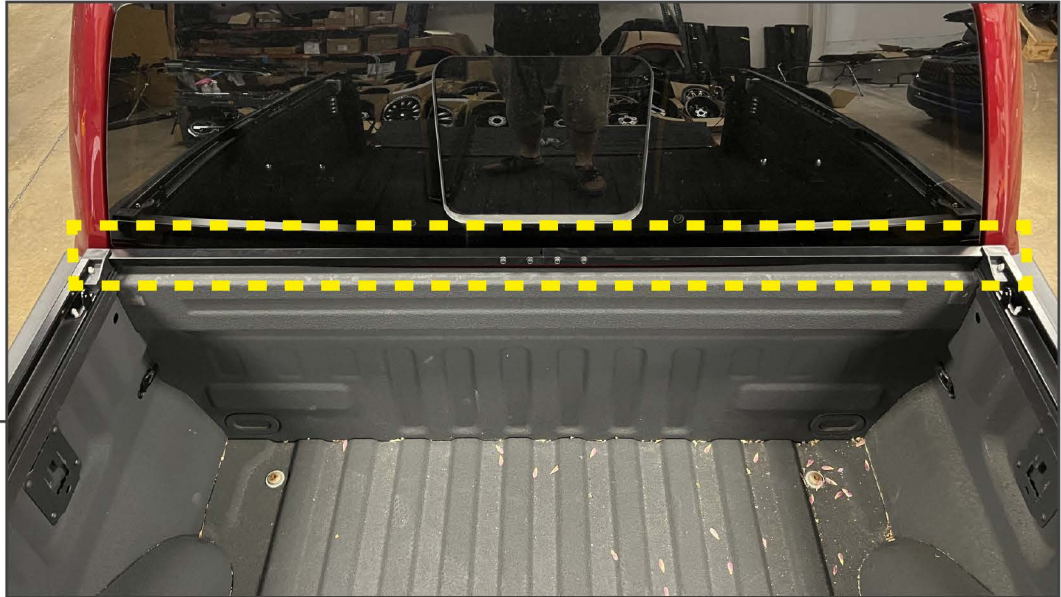

**STEP 3**

Assemble the front window rail using the included (4) M6 x 16mm Allen bolts and (4) M6 flat washers. Then, test fit the rail to the front of the side rails to familiarize the installation method.

Once familiar with fitment, remove the rail and set aside. This rail will be fitted into the front window on the topper canvas later.



**STEP 4**

Fit the included (1) bulkhead seal to the front window rail by pressing the metal-lined portion of the seal onto the front window rail lip.

At this time, slide the window rail onto the front window (attached to the canvas) utilizing the round slot in the rail.



### STEP 5

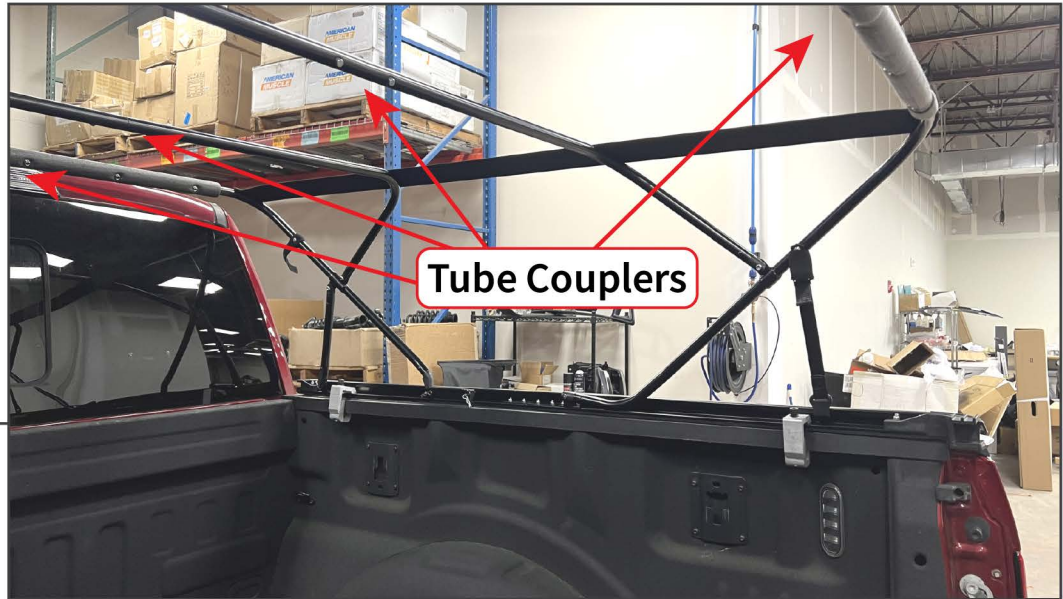

Join the bow assemblies together using the included (4) tube couplers in the center straight tubes. Ensure the couplers are fully pressed into each tube.

### STEP 6

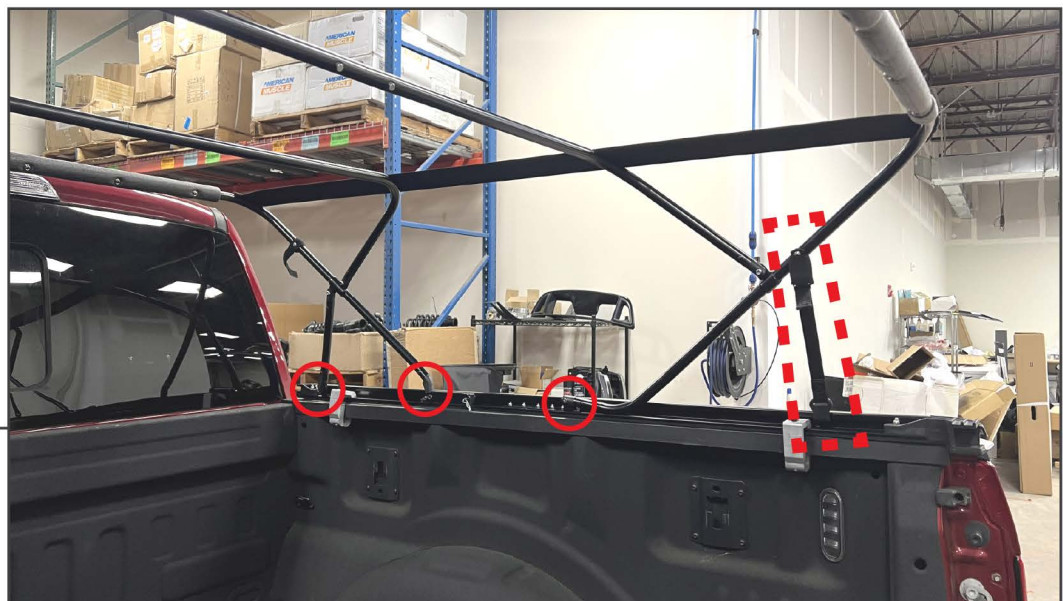

Install the bow assemblies to the previously mounted side rails. Each side rail has mounting points for the bow assembly latches/pins to fit.

The tension strap w/ hook with fit towards the rear of the vehicle, and the hook will latch onto the side rail. Tighten when the hook is in place.



## STEP 7

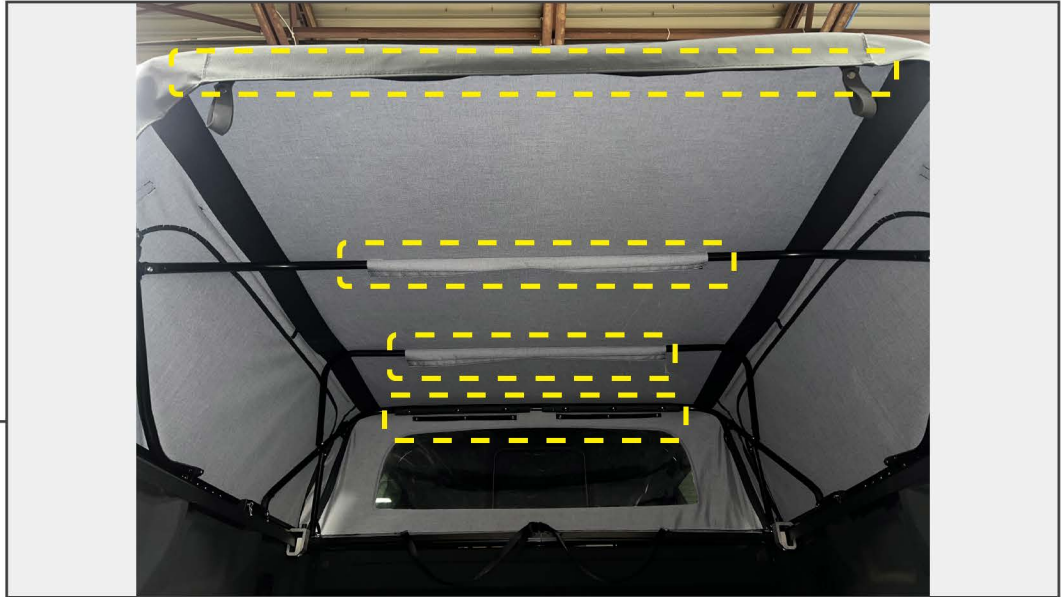

Fit the canvas with the front window over the top of the bow assemblies. Fit the front window rail between the side rails.

Secure the canvas to the upper bars of the bow assemblies using the pre-installed buttons/Velcro strips.

**Note:** Due to the construction of the canvas material, moderate stretching/pulling may be necessary to align each component to the canvas. It is recommended to place the canvas in the sun during installation to allow for easier manipulation.

## STEP 8



Fit each side wall panel using the attached zippers. Each wall is side specific and can be identified by the starting point of the zippers compared to the topper canvas zipper.

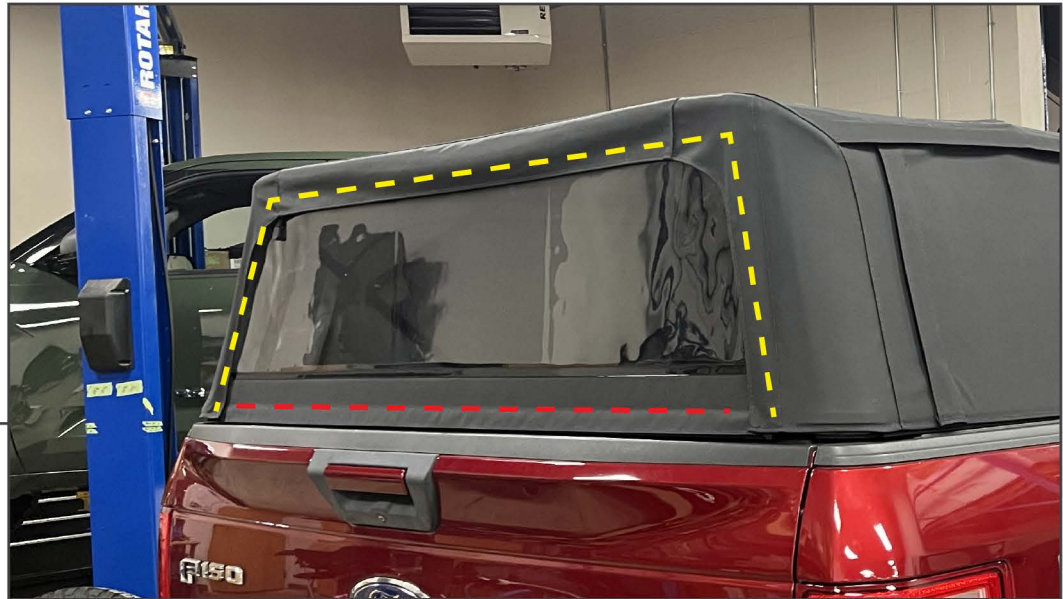

---

**STEP 9**

Slide the rear window onto the rear window rail utilizing the round slot in the rail. Then, secure the rear window to the canvas using the zippers.



---

**STEP 10**

Clean the bottom of the rear window rail using isopropyl alcohol and a microfiber cloth. Then, test fit the included tailgate seal to the bottom of the rail before removing the red tape backing to familiarize fitment. Once familiar, peel the tape backing and adhere the tailgate seal to the rear window rail. Trim excess seal material, if necessary.

Fit the rear window rail into the side rail mounts.



## STEP 11

Adjust the topper to best fit the vehicle bed, and then tighten the (4) bed rail clamps. To ensure best fit to the bed rails, ensure the clamps are placed closest to the bed corners as possible.

Fold the canvas corners and side wall lower lips under the side rails, using a rubber hammer may be necessary initially.

See next page for Retracting & Cleaning the topper on the vehicle.

Installation is now complete.

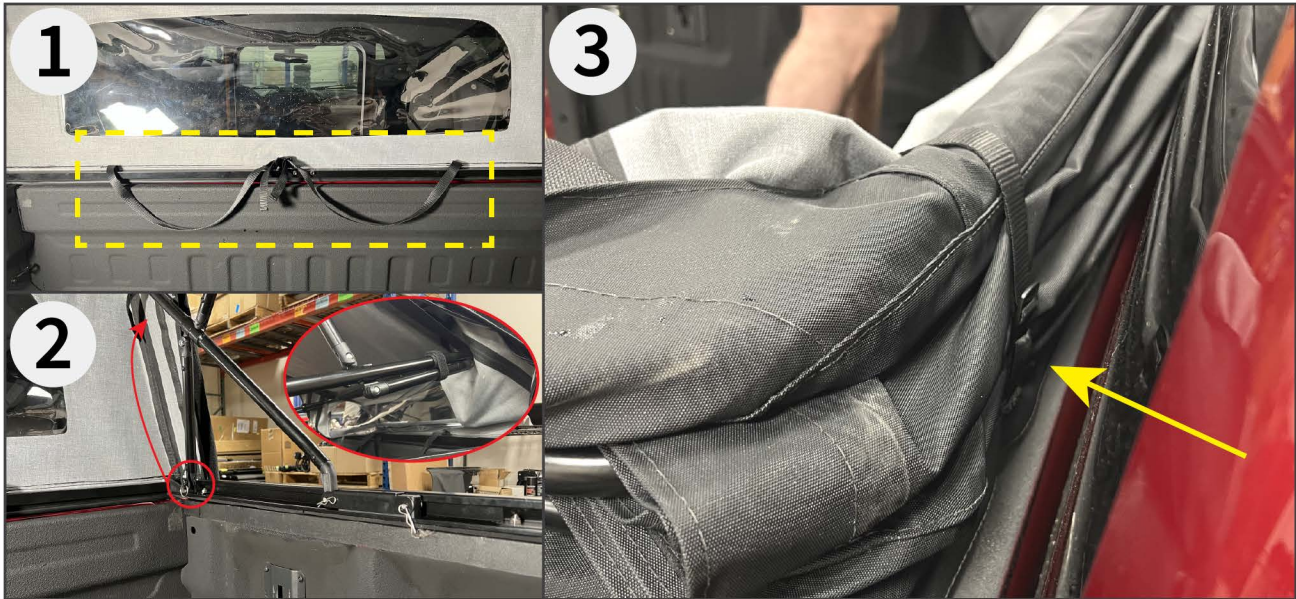

### **Retracting The Topper**

**1:** Ensure the (2) straps under the front window are loose, these straps will secure the topper in the retract position. Loosen the tension strap at the rear of the topper on each side.

**2:** Remove the rear window and side walls from the topper. Then, pull the front-most pin securing the bow assembly rail to the side rail. Secure the removed bow assembly rail to the rail above using the pre-installed Velcro strap.

**3:** Lift and fold the topper towards the front of the vehicle. Tuck the topper material in while folding as necessary. Secure the topper using the (2) straps into the sewn in hooks on the outside of the front window.

To utilize the truck bed without removing the topper, the rear window can be secured to the top of the topper using the sewn in elastic straps.

### **Cleaning the Topper**

The canvas can be cleaned using automotive grade soap and water. The windows can only be cleaned using a clean microfiber cloth and water/plastic window cleaner. Using abrasive towels and some cleaners can damage the material.