

# Installation Instructions

I - Sheet Number INS-HS98 Rev.C



## Hood Shield

**For proper installation and best possible fit, please read all instructions BEFORE you begin.  
For technical assistance or to obtain missing parts, please call Customer Relations at 1-800-344-8759.**

### Important Safety Information



- CAUTION - Before driving, ensure that the hood shield is properly secured to vehicle.
- Do not use automatic "brush-style" car washes.
- Do not use cleaning solvents of any kind.
- Periodically check all components for tightness.

### Contents

**NOTE:** Actual product may vary from illustration.



Hood shield



Bump Ons x4



Hood Insert x4  
(39-4150)



Washer x4  
(98022)



Fasteners x2  
(98059)



Screws x4  
(98023)

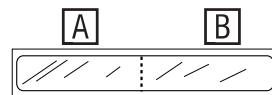

Protective Film (Long)

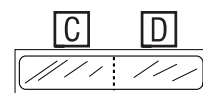

Protective Film (Short)

### Tools Required



Car Wash Supplies



Clean Towel

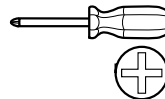

Phillips Screwdriver



Tape

### Preparation Before Painting / Installation

- A trial fit is recommended to ensure proper positioning and fit.
- Check fit of parts before painting as we will not accept the return of modified or painted parts.
- Wash and dry your vehicle to remove any debris and/or dirt from the installation area.

### Installation Steps

**NOTE:** Actual application may vary slightly from illustrations.

Open hood.

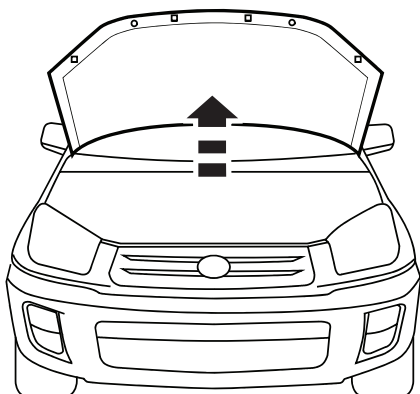

1

Locate (4) square holes and (2) round holes on underside of hood.

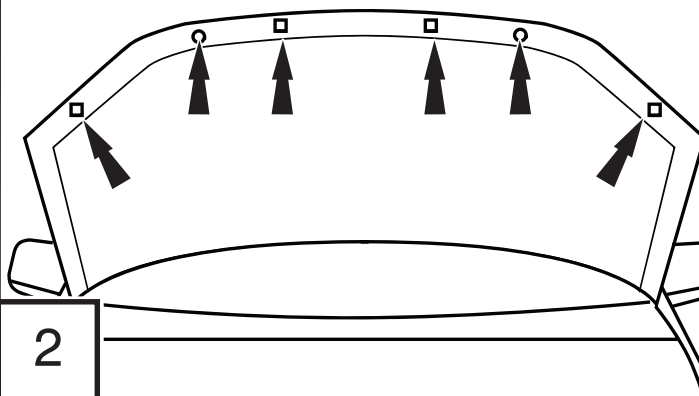

2

# Installation Steps

**NOTE:** Actual application may vary slightly from illustrations.

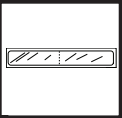

Center one (1) long strip of protective film along the leading edge of the hood. **Wrap** the protective film along the hood edge. **DO NOT COVER HOLES.**

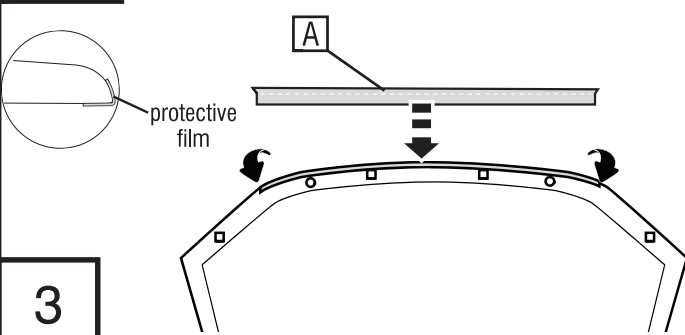

3

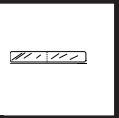

**Wrap** two (2) short pieces of protective film around the leading edge of the hood closest to the headlights

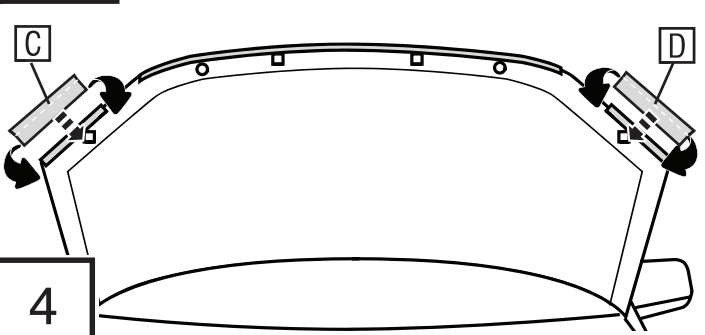

4

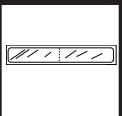

Center one (1) long strip of protective film along the leading edge of the outer grille housing. Place the protective film along the **TOP** of the housing.

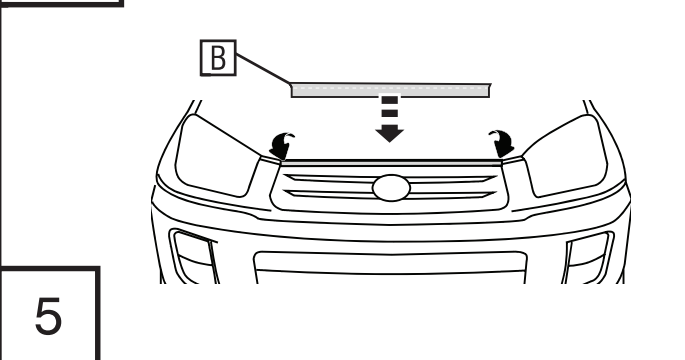

5

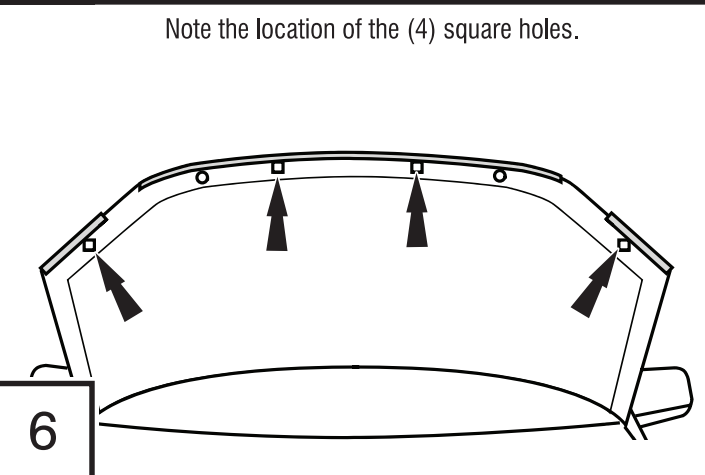

6

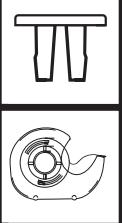

Press (4) hood inserts into the (4) square holes. If necessary use tape to hold them firmly in place.

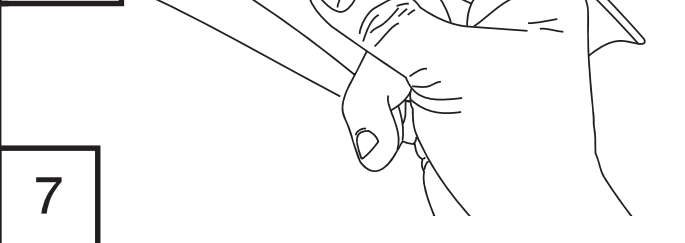

7

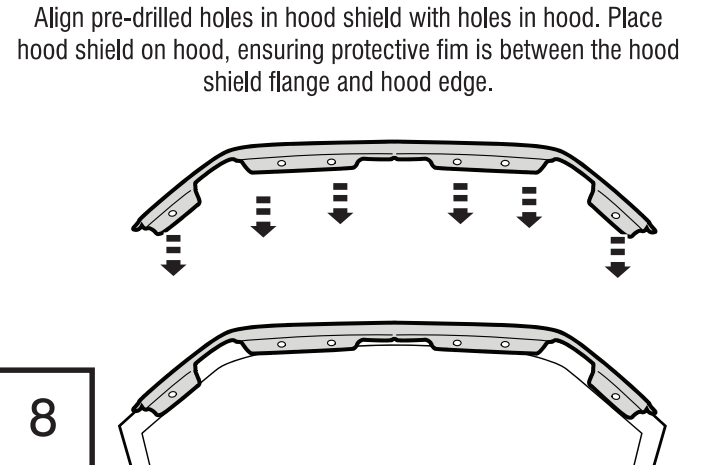

8

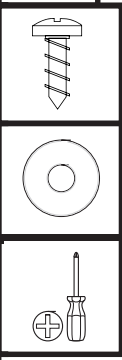

Using a phillips screwdriver install (4) screws with (4) washers at the locations noted in **Step 6.**



9

**DO NOT OVER TIGHTEN**

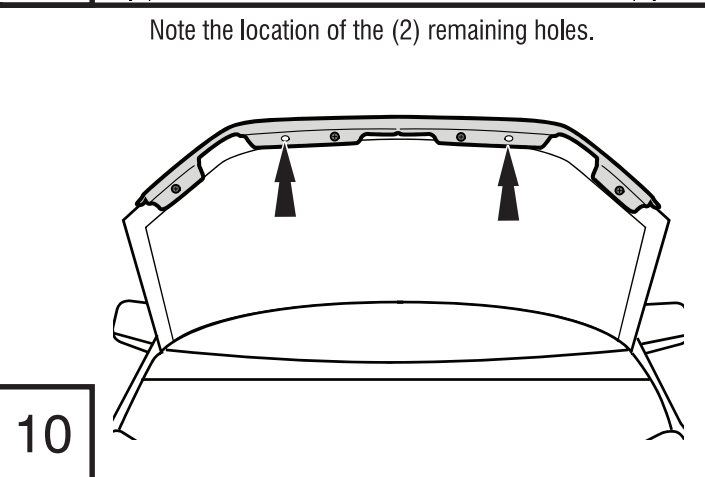

10

## Installation Steps

**NOTE:** Actual application may vary slightly from illustrations.



Insert (1) fastener and push firmly through hole in hood shield and into hood to secure. Repeat for remaining hole location.

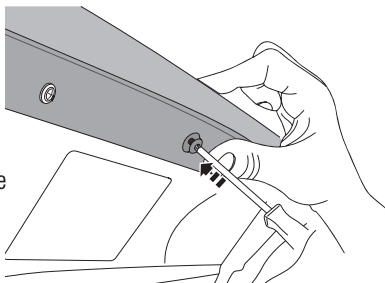
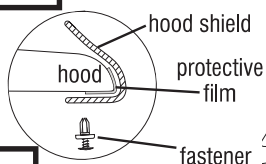

**DO NOT OVER TIGHTEN**

**11**



Close hood, and install bump ons at pre-cleaned locations on the painted hood surface.

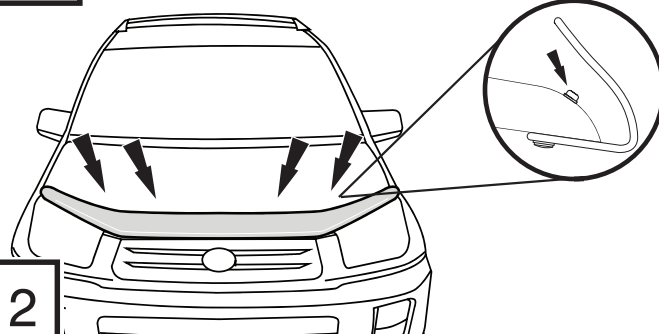

**12**

## Care and Cleaning

- Wash only with mild soap & dry with a clean cloth.



The material that your product is made from can be recycled. Please also consider recycling the packaging that your product came in.



## Congratulations!

You have purchased one of the many quality Husky® branded products. We take the utmost pride in our products and want you to enjoy years of satisfaction from your investment. We have made every effort to ensure that your product is top quality in terms of fit, durability, finish and ease of installation.



1-800-344-8759 • Visit us at [huskyliners.com](http://huskyliners.com)

© 2024 Husky Liners, Inc. All rights reserved.

Husky® and the Husky® logo are trademarks of Husky Liners, Inc.