

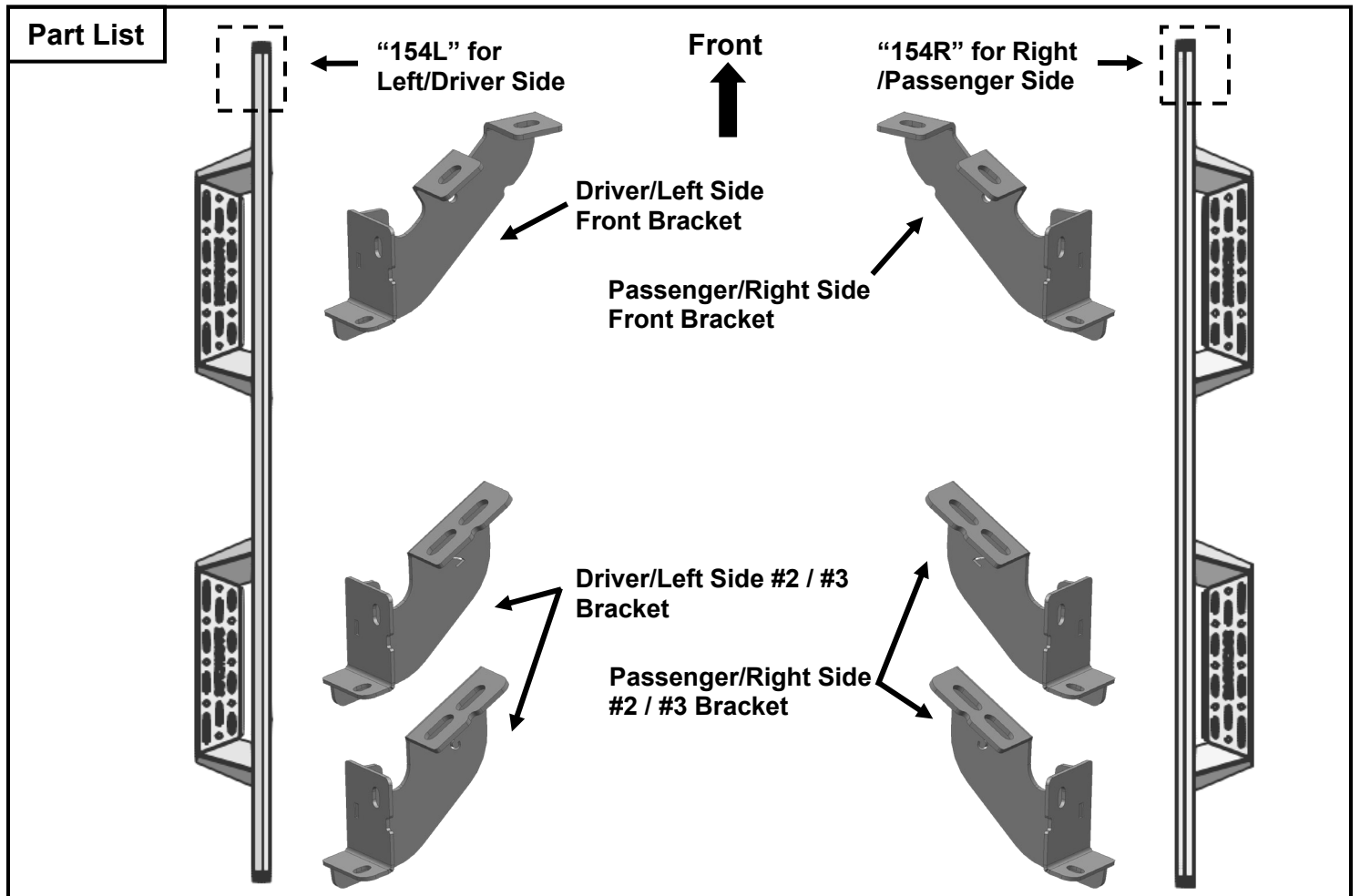

Canyon Drop Steps
2024 Tacoma Double Cab
SKU # TT62299





8mm x 30mm
Hex Bolt



8mm Flat Washer



8mm Lock Washer

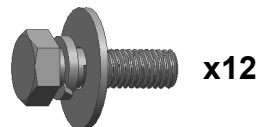

8mm x 25mm
Combo Bolt

PLEASE NOTE THAT THE FOLLOWING PICTURES ARE BASED ON THE PASSENGER SIDE INSTALLATION

STEP 1

Starting on the Passenger/Right front of the vehicle, remove the plastic plugs, (or hex bolts), covering the threaded holes in the body panel, (Fig 1).

FIG 1

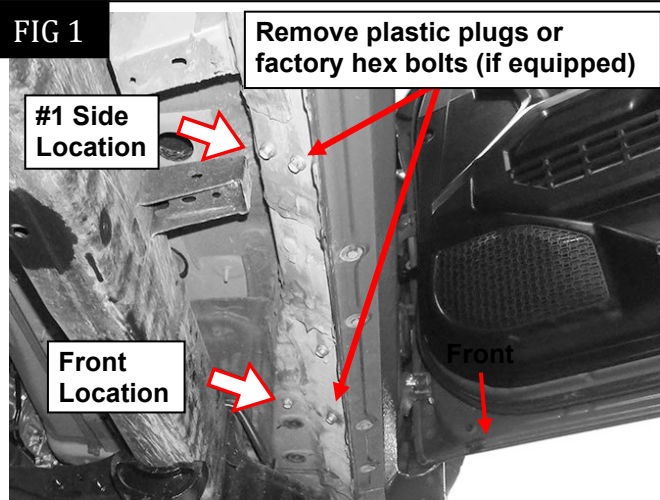

(Fig 1) Passenger/Right front and #1 mounting locations (arrows)

STEP 2

Select the Passenger/Right Front Mounting Bracket. Attach the Bracket to the vehicle with (2) 8mm Hex Bolts, (2) 8mm Lock Washers and (2) 8mm Flat Washers, (Fig 2). Do not tighten hardware at this time.

FIG 2

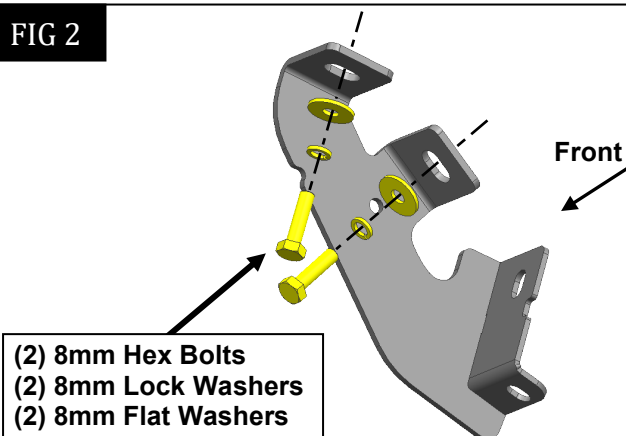

(Fig 2) Attach Passenger/Right Front Mounting Bracket to the front mounting location

STEP 3

Move along the side of the vehicle to the next mounting location, (Fig 1). Select the Passenger/Right #1 Mounting Bracket, (Fig 3). Repeat **Step 2** for Mounting Bracket installation. **IMPORTANT:** The Passenger/Right Side #1 Brackets are different from #2/ #3 Brackets. Properly identify all Brackets before installing.

FIG 3

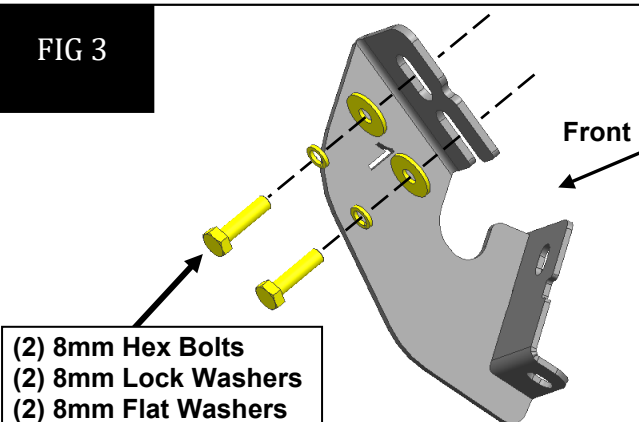

(Fig 3) Attach Passenger/Right #1 Mounting Bracket to the #1 mounting location

STEP 4

Move along the body panel to the #2/ #3 (rear) mounting location, (**Fig 4**). Select Passenger/Right #2/ #3 Mounting Brackets. Repeat **Step 3** to install the Mounting Brackets. Do not tighten hardware.

FIG 4

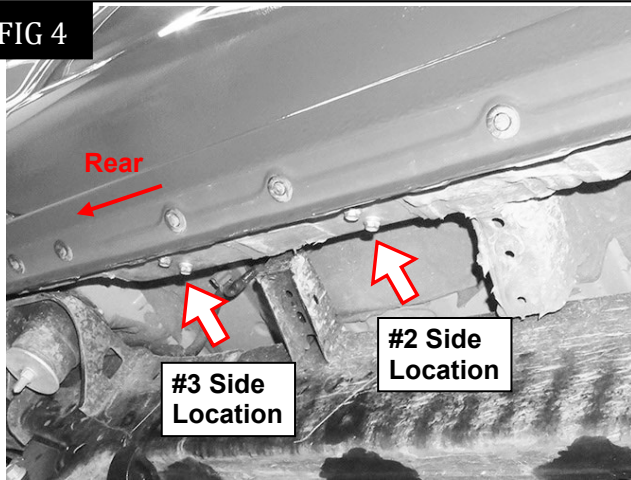

(Fig 4) Passenger/Right #2/ #3 (rear) mounting locations

STEP 5

Select the Passenger/Right Running Board. **NOTE:** The Passenger/Right Running Board will have a "154R" on the front. Carefully place Running Board on the brackets. **IMPORTANT:** Do not slide the Running Board front to back or damage to the finish may result. Attach Running Board to the (4) Mounting Brackets with (8) 8mm Combo Bolts, (**Fig 5**). Do not tighten hardware.

FIG 5

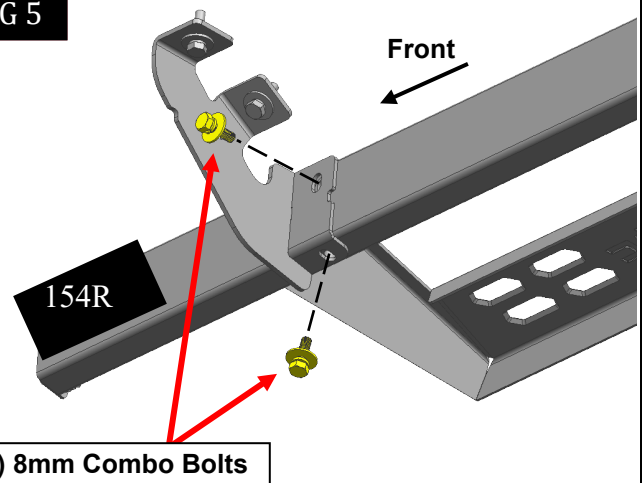

(Fig 5) Attach Passenger/Right Running Board to the Mounting Brackets

STEP 6

Level and adjust the Running Board and fully tighten all hardware.

STEP 7

Repeat **Steps 1—6** to attach the Driver/Left Running Board.

STEP 8

Do periodic inspections to the installation to make sure that all hardware is secure and tight.

To protect your investment, wax this product after installing. Regular waxing is recommended to add a protective layer over the finish. Do not use any type of polish or wax that may contain abrasives that could damage the finish. Mild soap may be used to clean the Running Board.