

REDROCK

TC2 RUNNING BOARD

SKU #: TT50911

FITS:

2024-Up Tacoma Double Cab



60-120 min



Cutting Not
Required



Drilling Not
Required

Torque & Tools

Fastener Size	Tightening Torque (ft-lbs)	Wrench Required		Allen Wrench Required	
<input type="checkbox"/> 6mm	<input type="checkbox"/> 7-8.5		<input type="checkbox"/> 10mm		<input type="checkbox"/> 4mm
<input checked="" type="checkbox"/> 8mm	<input checked="" type="checkbox"/> 18-20		<input checked="" type="checkbox"/> 13mm		<input type="checkbox"/> 5mm
<input type="checkbox"/> 10mm	<input type="checkbox"/> 35-40		<input type="checkbox"/> 16mm		<input type="checkbox"/> 6mm
<input type="checkbox"/> 12mm	<input type="checkbox"/> 60-70		<input type="checkbox"/> 18mm		<input type="checkbox"/> 8mm

BEFORE INSTALLATION

REMOVE CONTENTS FROM BOX. VERIFY ALL PARTS ARE PRESENT. READ INSTRUCTIONS CAREFULLY BEFORE STARTING INSTALLATION. ASSISTANCE IS RECOMMENDED.

Part List

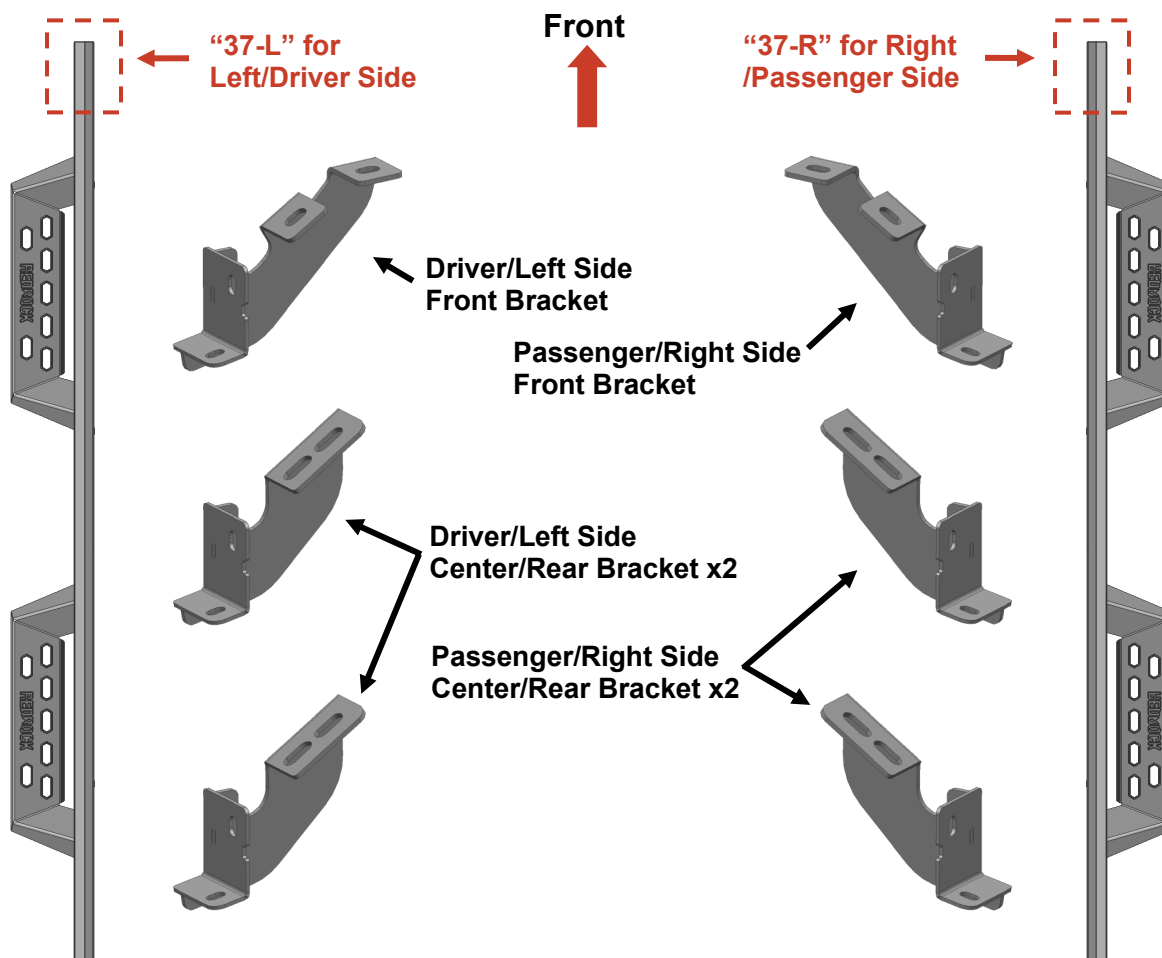

REDROCK



8mm x 30mm
Hex Bolt

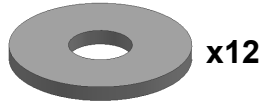

8mm Flat Washer



8mm Lock Washer

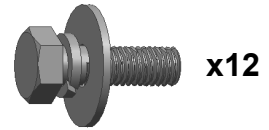

8mm x 25mm
Combo Bolt

PLEASE NOTE THAT THE FOLLOWING PICTURES ARE BASED ON THE PASSENGER SIDE INSTALLATION

STEP 1

Starting on the Passenger/Right front of the vehicle, remove the plastic plugs, (or hex bolts), covering the threaded holes in the body panel, (Fig 1).

FIG 1

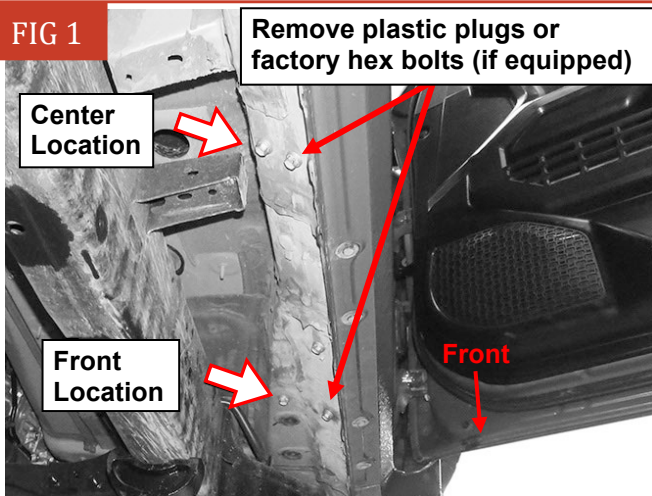

(Fig 1) Passenger/Right Front and Center mounting locations (arrows)

STEP 2

Select the Passenger/Right Front Mounting Bracket. Attach the Bracket to the vehicle with (2) 8mm Hex Bolts, (2) 8mm Lock Washers and (2) 8mm Flat Washers, (Fig 2). Do not tighten hardware at this time.

FIG 2

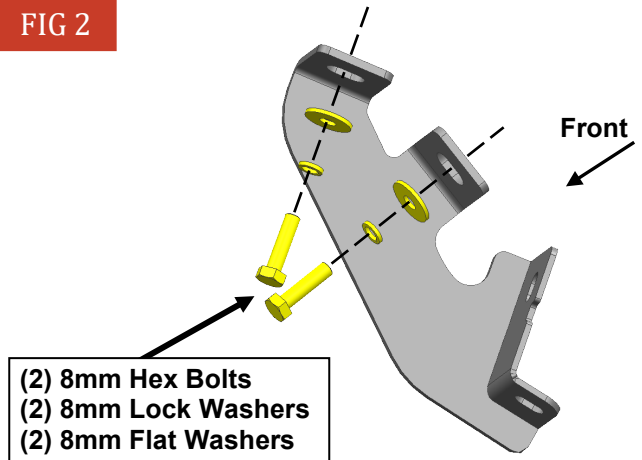

(Fig 2) Attach Passenger/Right Front Mounting Bracket to the front mounting location

STEP 3

Move along the body panel to the center and rear mounting locations, (Figs 1 & 3). Select remaining (2) Passenger/Right Center/Rear Mounting Brackets. Repeat **Step 2** to install the Mounting Bracket on center and rear mounting locations, (Fig 4). Do not tighten hardware.

FIG 3

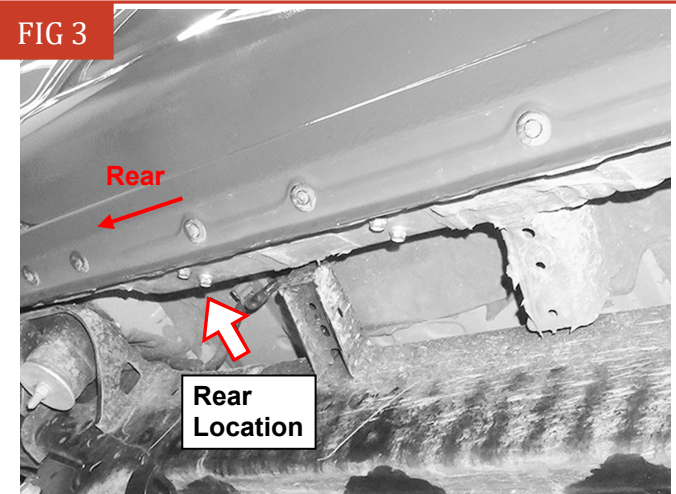

(Fig 3) Passenger/Right Rear mounting location

FIG 4

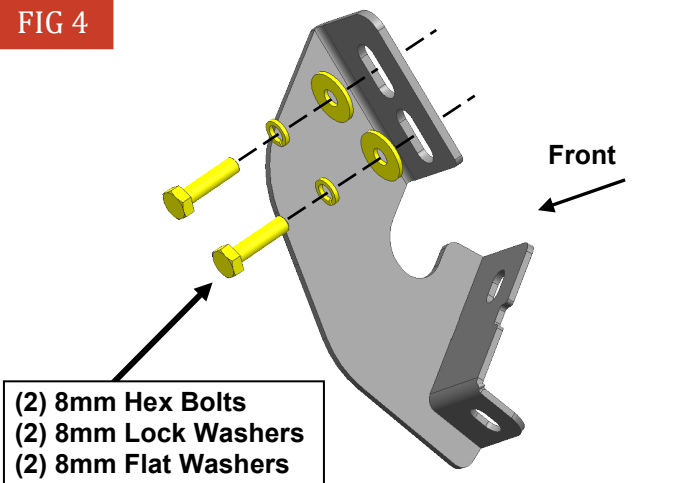

(Fig 4) Attach Passenger/Right Center/Rear Mounting Brackets to the center and rear mounting locations

STEP 4

Select the Passenger/Right Running Board.
NOTE: The Passenger/Right Running Board will have a “37-R” on the front. Carefully place Running Board on the brackets. **IMPORTANT:** Do not slide the Running Board front to back or damage to the finish may result. Attach Running Board to the (3) Mounting Brackets with (6) 8mm Combo Bolts, (Fig 5). Do not tighten hardware.

FIG 5

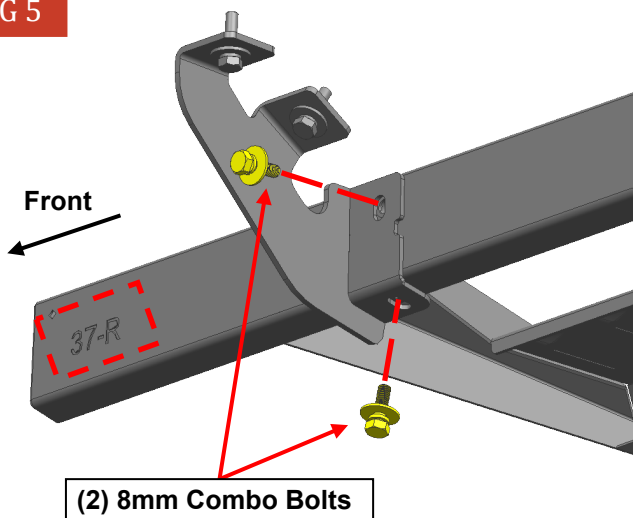

(Fig 5) Attach Passenger/Right Running Board to the Mounting Brackets

STEP 5

Level and adjust the Running Board and fully tighten all hardware.

STEP 6

Repeat **Steps 1—5** to attach the Driver/Left Running Board.

STEP 7

Do periodic inspections to the installation to make sure that all hardware is secure and tight.

Attention

To protect your investment, do not use any type of polish or wax that may contain abrasives that could damage the finish.

Mild soap may be used also to clean the Running Boards.