

#### TAILGATE SPOILER TACOMA 2016-2023

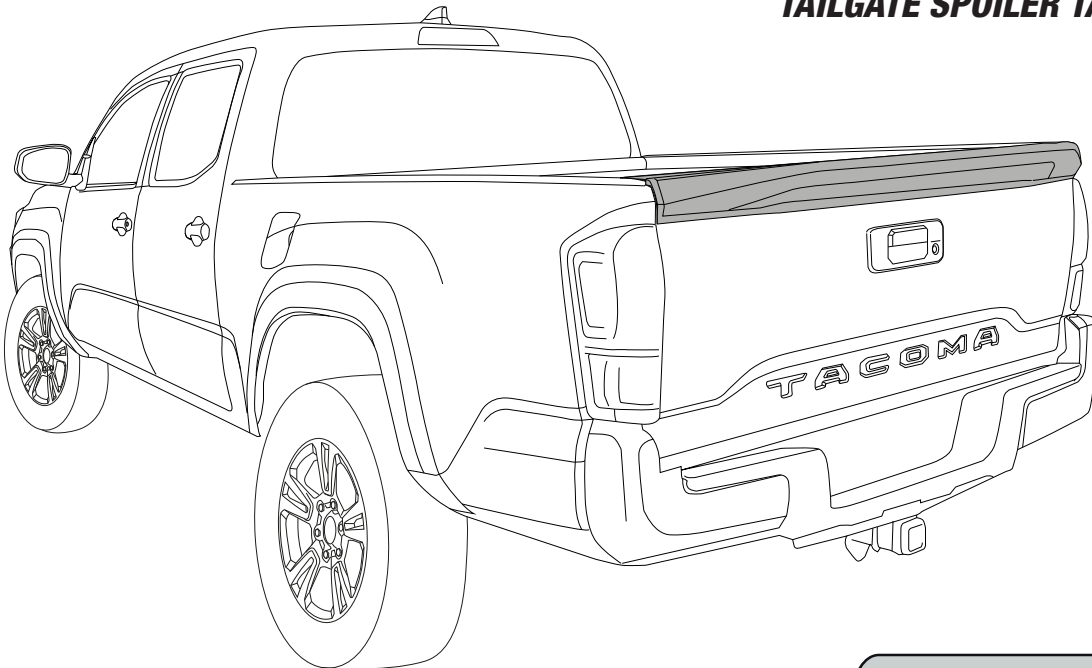

**READ CAREFULLY  
BEFORE INSTALLATION**



**WASH BEFORE  
INSTALLING**



**WE RECOMMEND  
2 PERSONS FOR  
INSTALLATION**

#### AFTER INSTALLING

**DO NOT  
WASH CAR**



**24 hrs**



**DRIVE SLOWLY  
25 mph max**

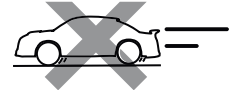

#### TOOLS



#### CHECK LIST

*\*Already installed in the part*

ITEM	DESCRIPTION	DRAWING	AMOUNT
<b>A</b>	*VHB TAPE		N/A
<b>B</b>	GREASE PENCIL		1 pc
<b>C</b>	ADHESION PROMOTER		1 pc

#### 1 CLEAN

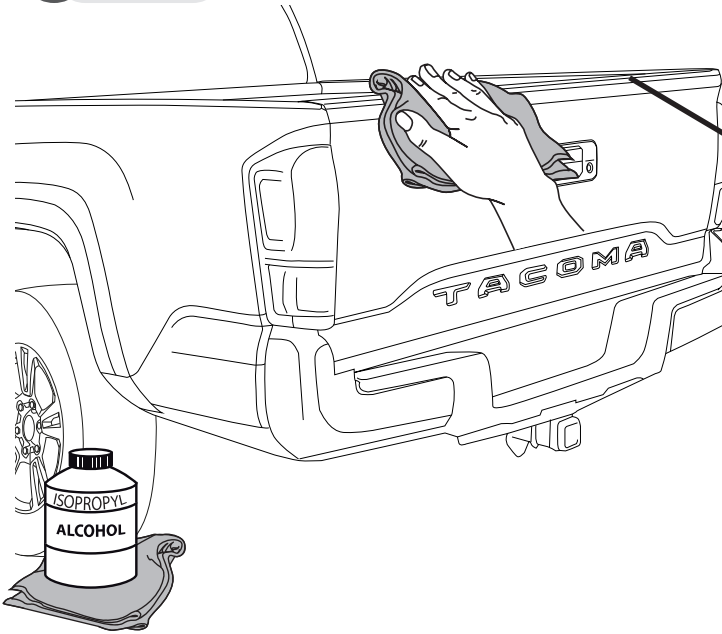

#### IMPORTANT

ENSURE THE SURFACES ARE COMPLETELY CLEAN BEFORE INSTALLING

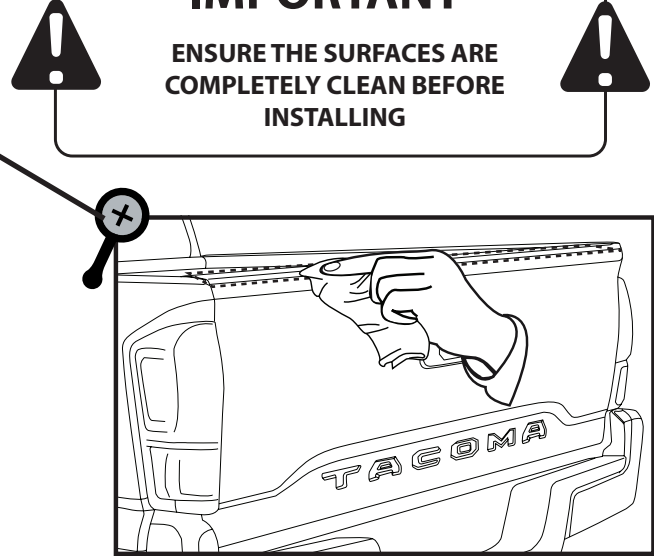

#### 2 PRE-MOUNT

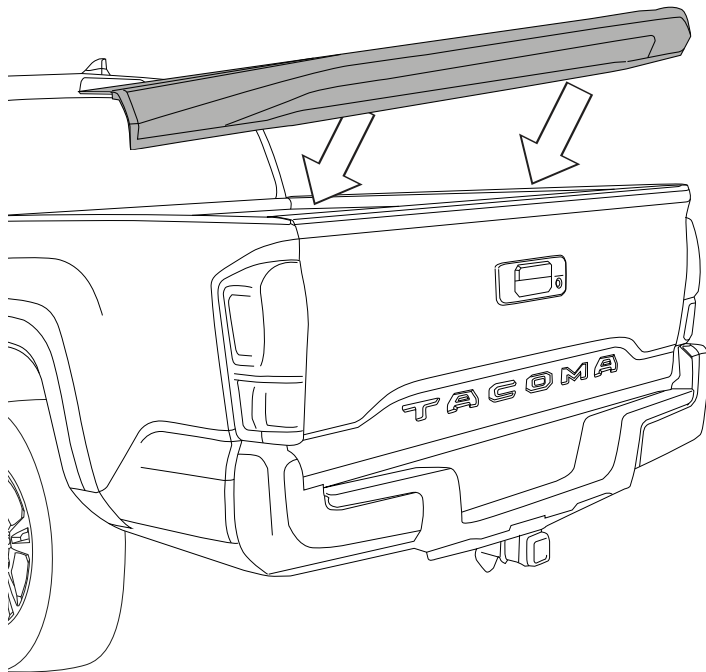

#### 3 ALIGN & CENTER

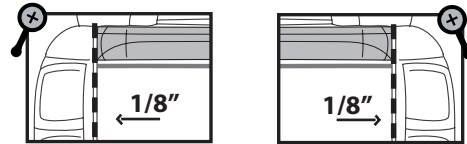

LEAVE APPROXIMATELY 1/8" FROM THE EDGE, ON BOTH SIDES

DRAW CENTER HASH MARK WITH GREASE PENCIL ON WING SPOILER AND SHEET METAL, THIS WILL ENSURE WING SPOILER WILL BE CENTERED TO GREASE PENCIL OUTLINE.

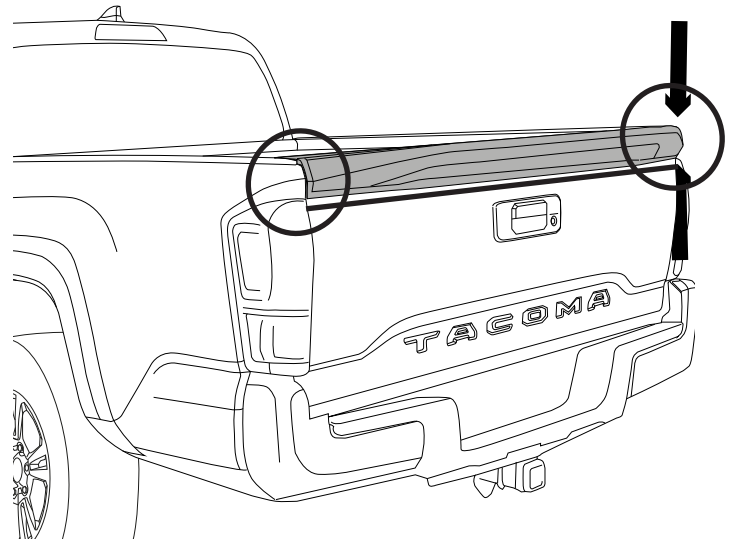

**4 ADHESION PROMOTER**

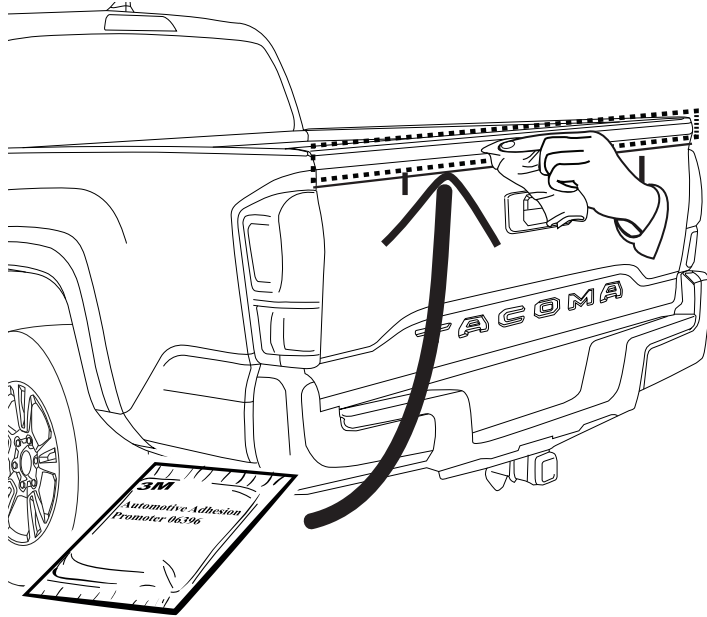

**!** A full surface contact between tape and substrate is decisive for good adhesion performance. Contact is achieved by applying pressure. In practice a pressure between 40 and 50 N/cm<sup>2</sup> is usually needed and an application temperature between 25 and 45 °C or 77 and 113 °F is also necessary. During application, add-on parts and tapes must have the similar temperature.

**5 PEEL**

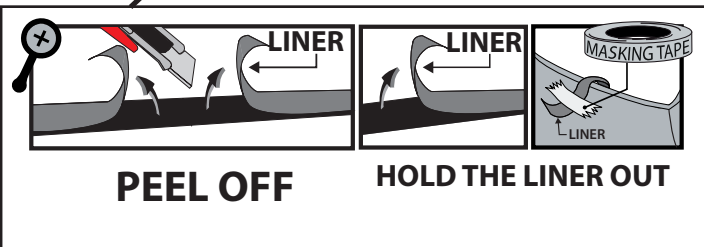
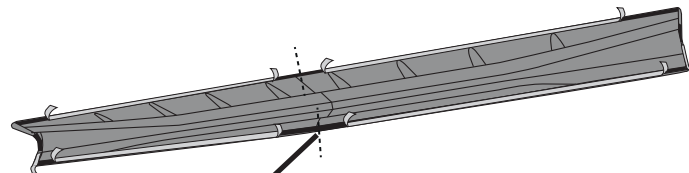

**WARM SURFACES WITH HEAT GUN IF SURFACE TEMPERATURE IS TOO COLD.**

**6 PLACE**

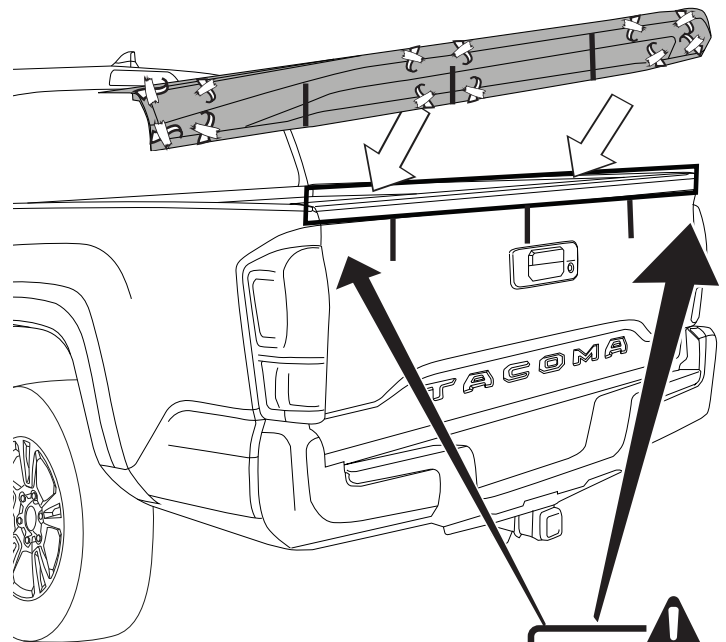

**7 REMOVE LINER**

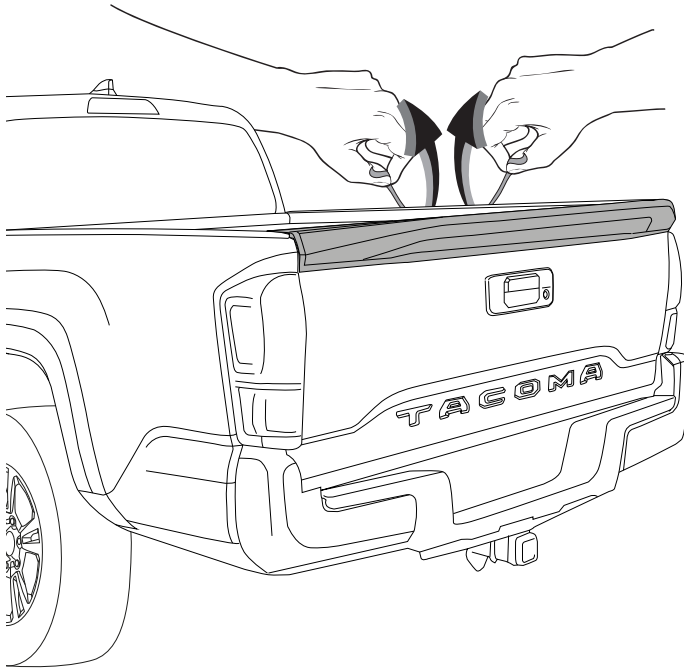

**8 PRESS FIRMLY**

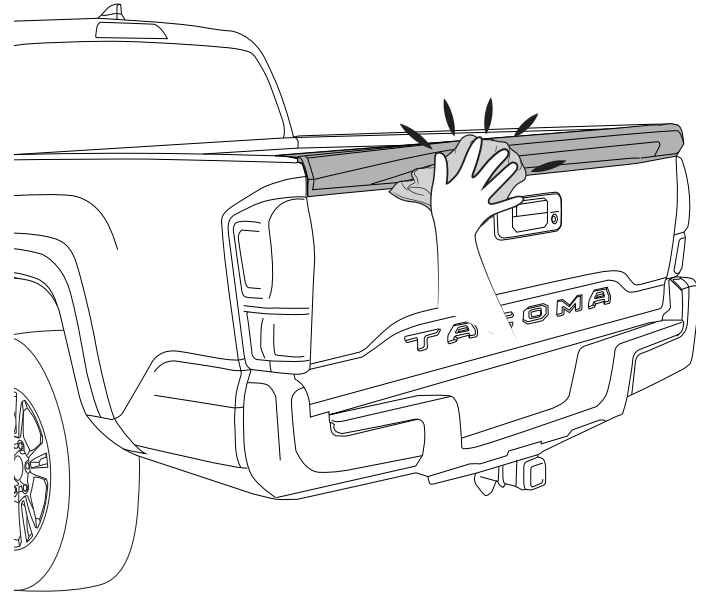

**9 CLEAN**

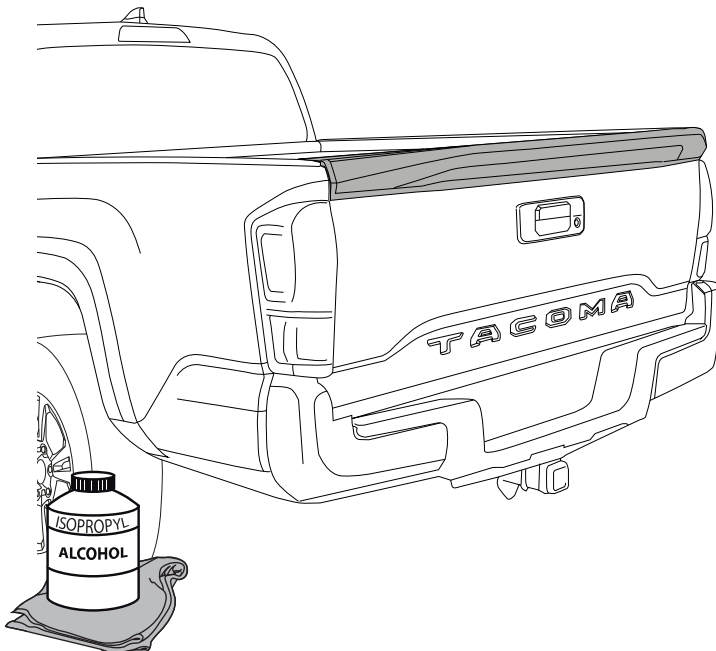

**INSTALLED PART**

