



BAJA MESH GRILLE WITH LED OFFROAD LIGHTING

(2016-2023+ TACOMA)

INSTALLATION INSTRUCTIONS

CONTENTS

- (1) Grille Assembly
- (1) Light Bar
- (3) Scotchlok Connectors
- (6) Cable Ties

TOOLS REQUIRED

- Flathead Screwdriver
- Phillips Screwdriver
- Panel Removal Tool
- 10mm Socket
- Ratchet
- Exterior Detailer
- Microfiber Cloth

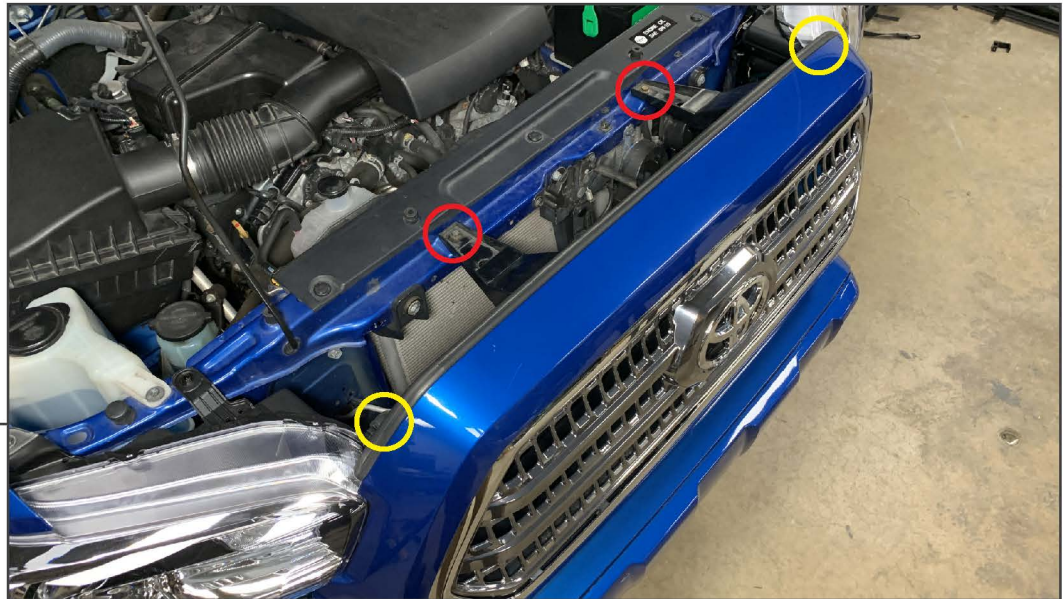

STEP 1

Open the vehicle hood. Remove (2) 10mm bolts and (2) plastic push clips from the vehicle grille.



STEP 2

Lift the (2) plastic grille brackets over the bolt holes, and pull the grille away from the vehicle. Place the grille face down on a soft surface for disassembly.

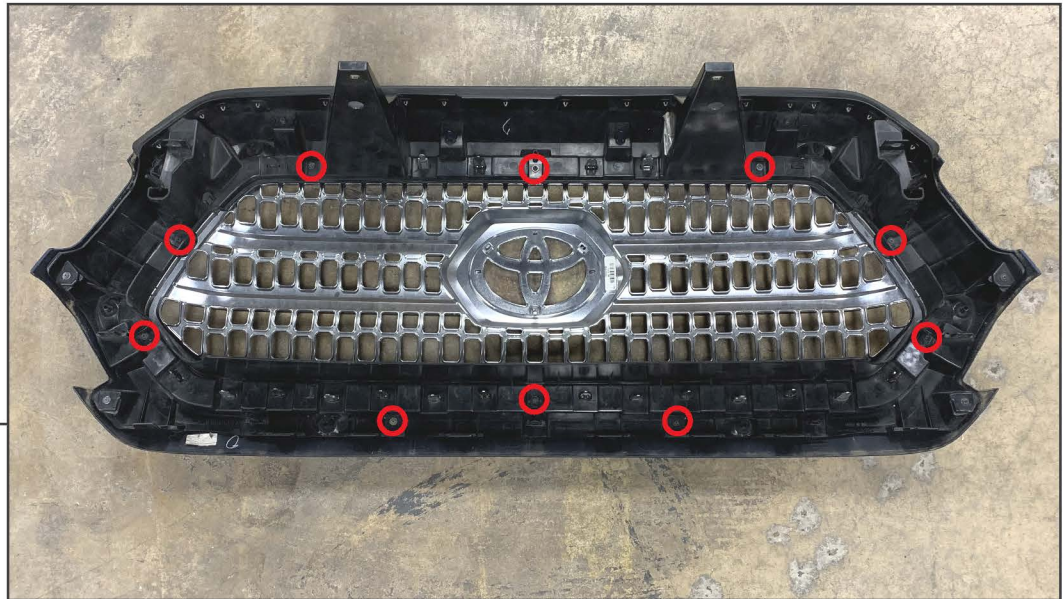

STEP 3

Remove (10) Phillips screws from the back-side of the grille.

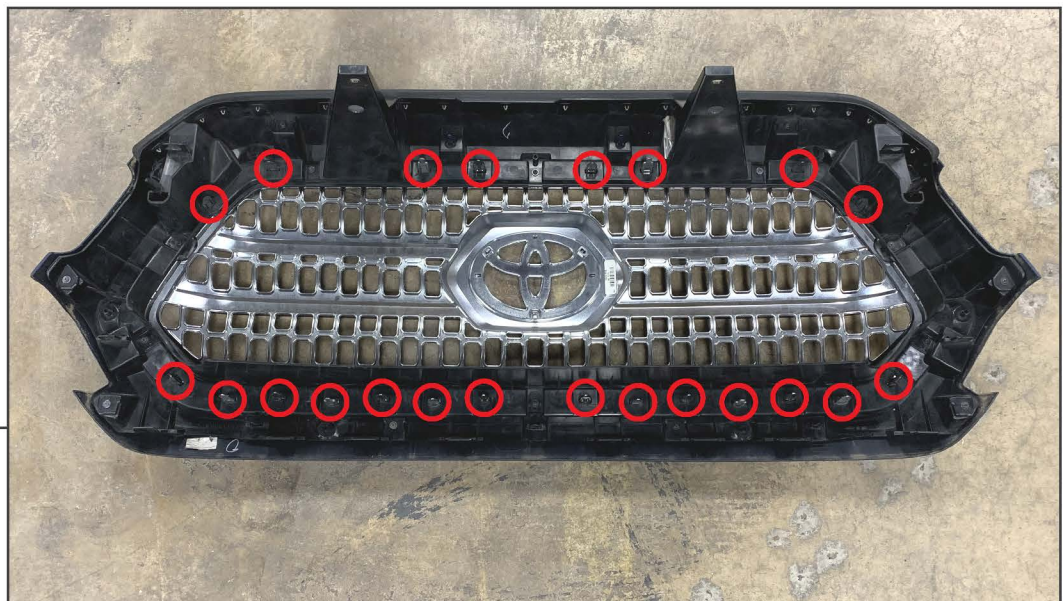

STEP 4

Using a flathead screwdriver, dislodge the outer grille mesh from the vehicle grille housing. Depress the retainer with a flathead screwdriver, while gently prying outwards on the mesh. The mesh will be removed through the front of the grille.

STEP 5



Using exterior detailer and a microfiber cloth, clean the inside edges of the grille housing.

STEP 6



Press the new grille into the vehicle grille housing. Ensure each mounting point is properly aligned, and firmly press until all of the mounting tabs are fully depressed.

If the vehicle has the grille sensor, carefully transfer the sensor to the new grille.

STEP 7

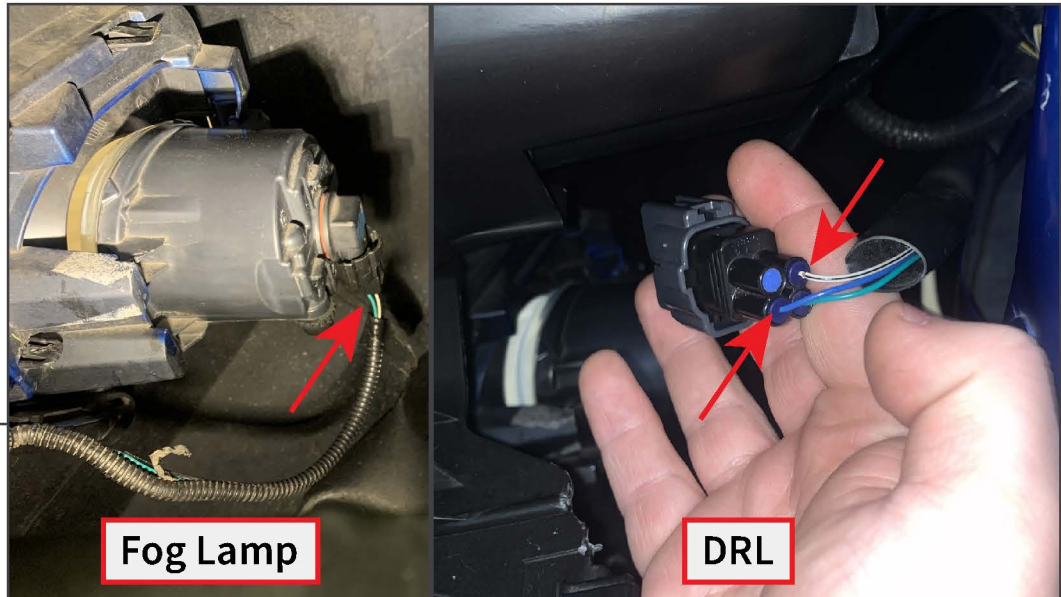

Route the LED lighting wiring towards the RH side headlight and fog light assembly. Splice the LED lighting harness into the vehicle following the diagram below.

<u>Grille Lighting</u>	-	<u>Vehicle Harness</u>
Red (Offroad Lights)	-	Green (Fog Light +)
Yellow (Parking Lamps)	-	Blue (DRL +)
Black (Ground)	-	White/Black (Ground)

STEP 8

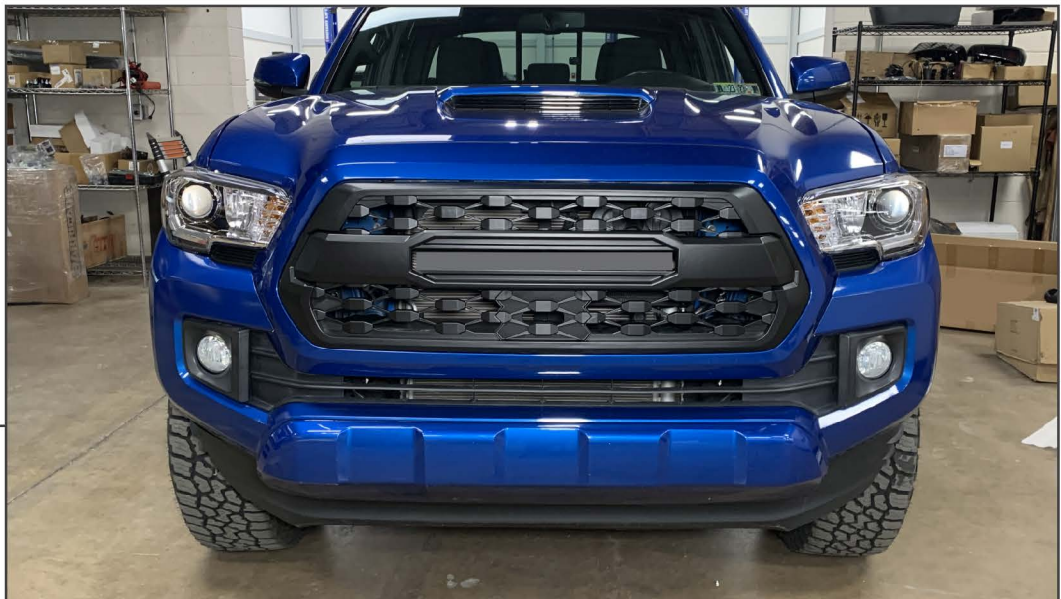

Fit the grille to the vehicle, and secure into place using the original (2) 10mm bolts and (2) plastic push clips.

Installation is now complete.