

# Front skid plate

## Mounting instructions for Toyota Land Cruiser 150/155

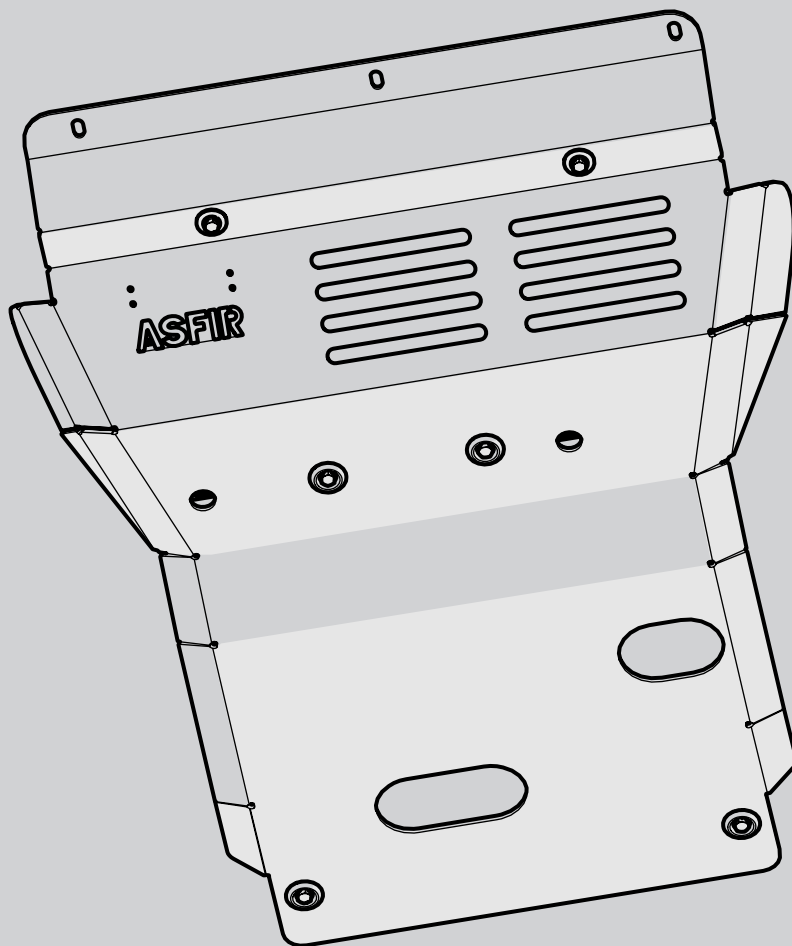

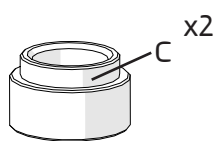
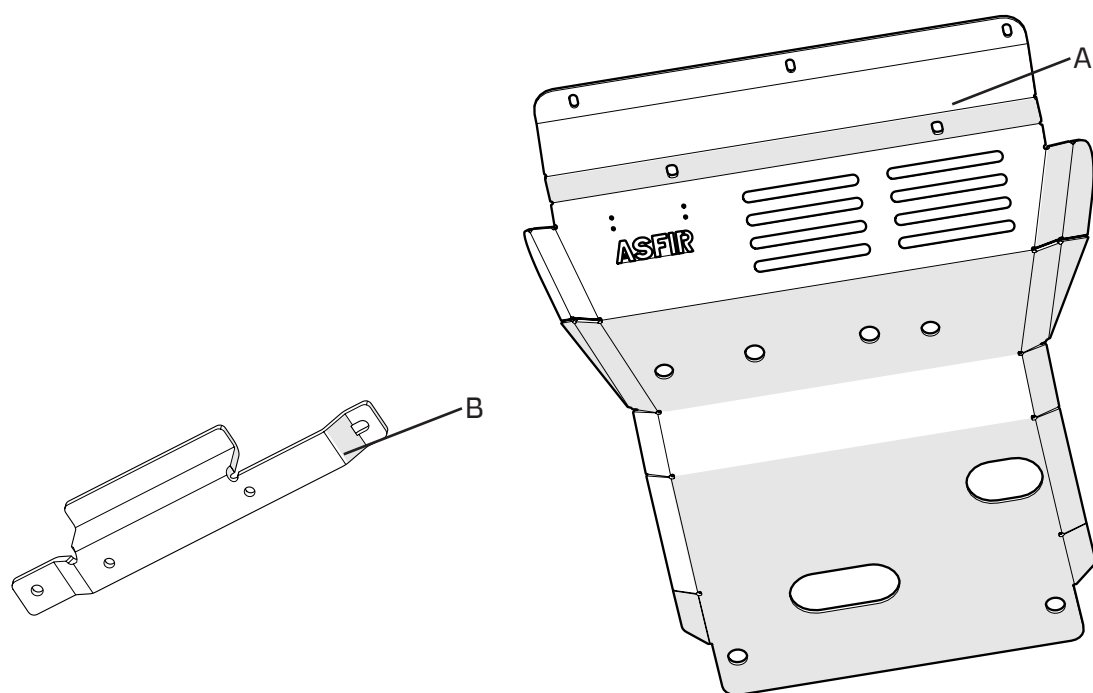

Spacer 1/2" L-13

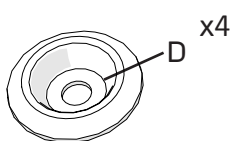

Pocket washer 8

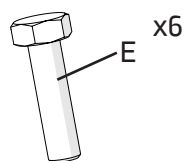

Hex bolt M8x30

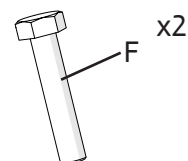

Hex bolt M8x40

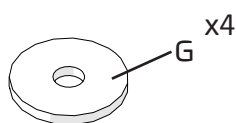

washer 8x30

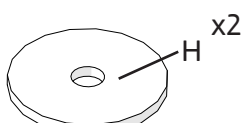

washer 8x40

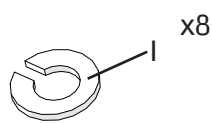

Spring washer 8

### Maximum Tightening Torques

M8(8.8)

25 Nm

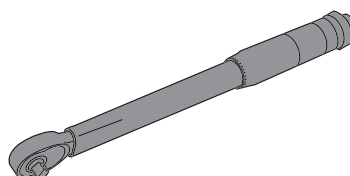

12,13

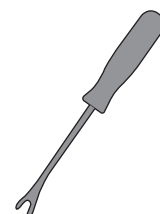

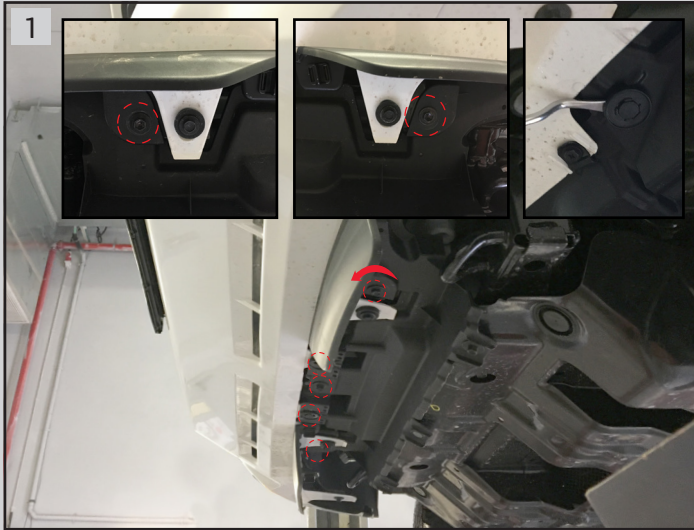

Remove the 3 bolts and 2 clips



12



Remove 4 bolts and middle clips.  
Dispose the original plate



12

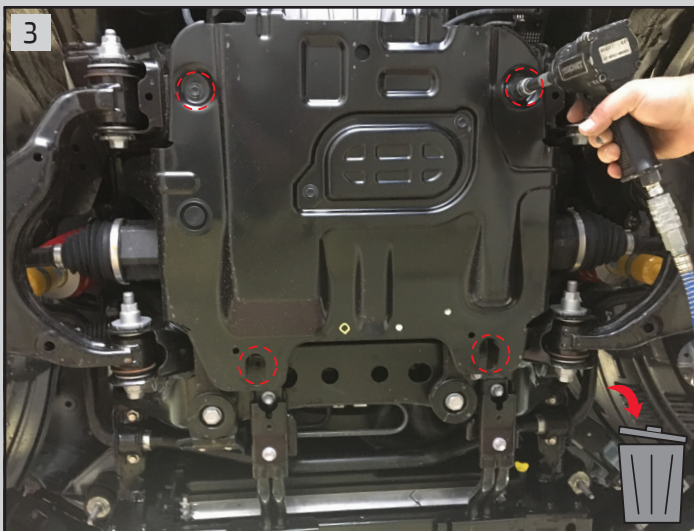

Remove 4 bolts and dispose the original plate



12



Connect the bracket to the original screwing using  
hex bolt (E), spring washer (I), and washer (G)



13

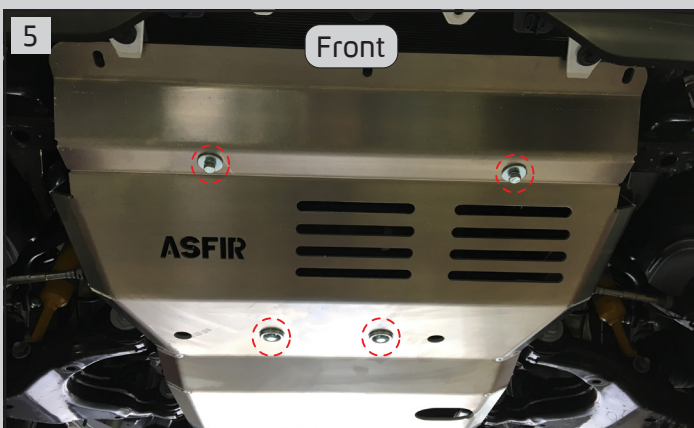

In the front, connect plate (A) to original screwing  
using hex bolt (E), spring washer (I) and washer (G).



13

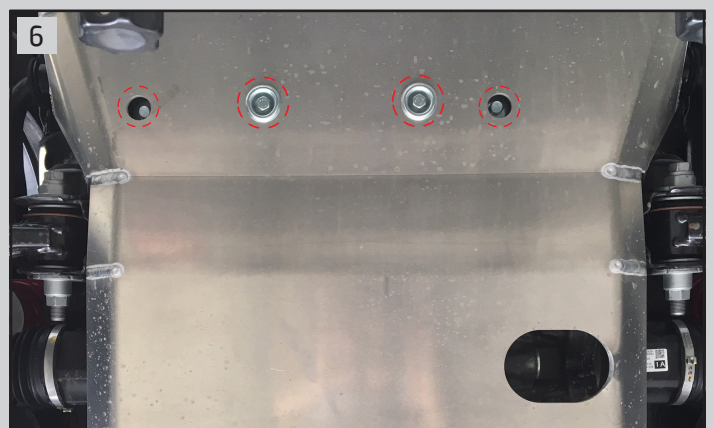

In the middle connect bracket (B) to the plate (A)  
using hex bolt (E), spring washer (I), and washer (D)



13



In the rear place spacer (C) and align it with the front holes of plate (A)



Connect the plate to original screwing using hex bolt (F), spring washer (I), pocket washer (D).  
Tighten all 6 bolts of the skid plate