



INSTALLATION INSTRUCTIONS

Not legal for sale or use in California on any pollution controlled motor vehicle.

77-6018KC NISSAN 2022-25 Frontier V6-3.8L

TOOLS NEEDED:

- Ratchet
- Extension
- 13mm socket
- 10mm socket
- Pliers
- Flat blade screw driver
- 4mm allen key
- 3mm allen key
- 7/8" wrench

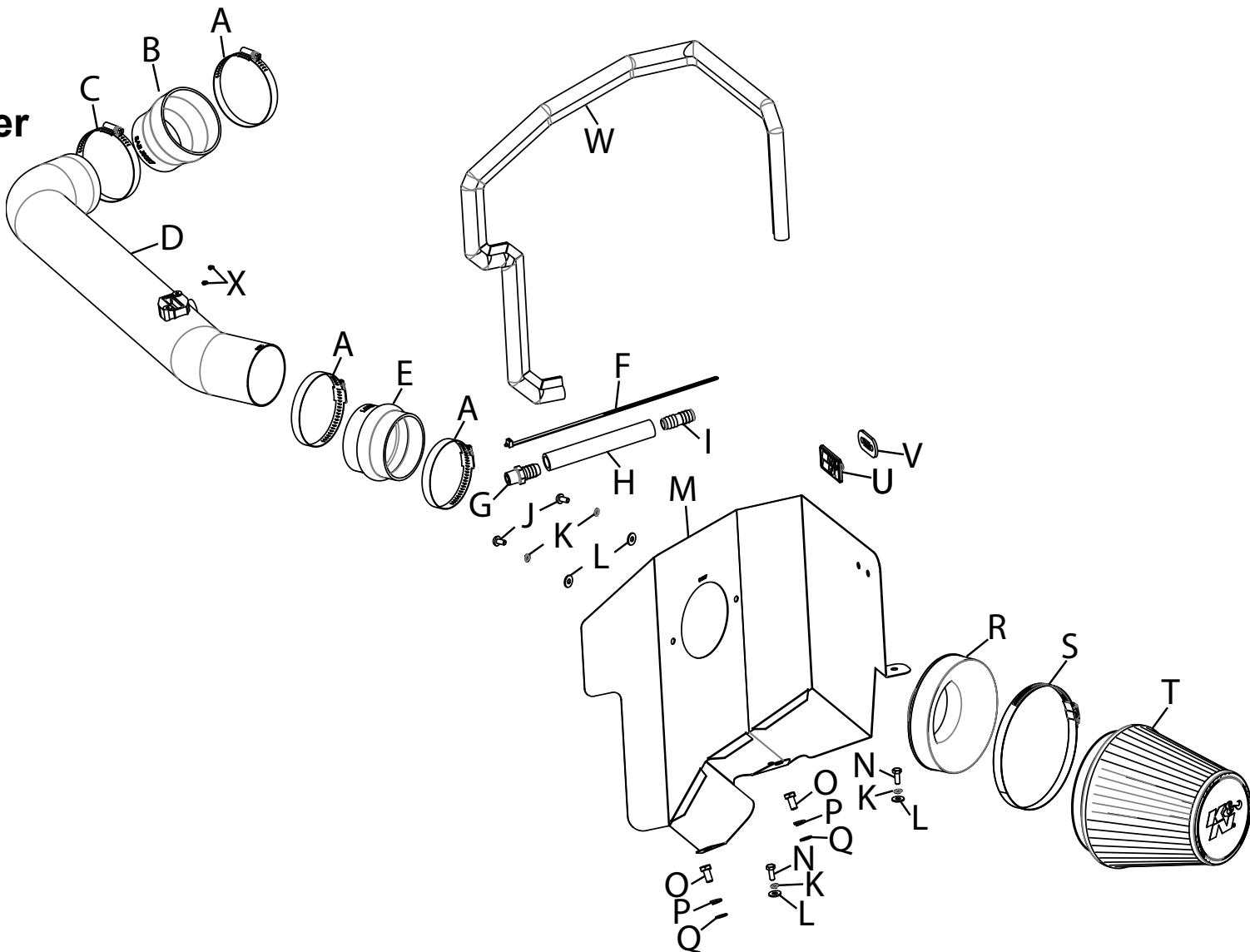

PARTS LIST:

Description	Qty.	Part #	Description	Qty.	Part #	Description	Qty.	Part #
A HOSE CLAMP; #52	3	08610	I FITTING, VENT 5/8"OD	1	08048	Q WASHER; 8MM, FLAT	2	08272
B HOSE; 3.5" TO 3"ID X 3"L	1	084055	J BOLT; M6-1 X 12MM BTNHD	2	07794	R ADAPTER; 6" COUPLER	1	21512-1
C HOSE CLAMP; #56	1	08620	K WASHER; M6, SPLIT LOCK	4	1-3025	S HOSE CLAMP; #104	1	08697
D TUBE; 3.25"OD X 30"L, (AL)	1	25890C	L WASHER; 6MM FLAT	4	08269	T AIR FILTER	1	RU-1042
E HOSE; HUMP 3.25"ID X 2-5/8"L	1	08171	M HEAT SHIELD	1	074557	U BADGE, SNAP-IN LOGO	1	088096
F CABLE TIES 11" BLK	1	21590	N BOLT; M6-1 X 16MM HEX	2	07812	V PLATE; LOCKING	1	010151
G FITTING, 5/8"BARB TO 3/8"NPT	1	82635	O BOLT; 8MM-1.25 X 16MM, HEX	2	07844	W EDGE TRIM; (46"L)	1	102487
H HOSE; 5/8"ID X 6"L, BLK	1	08653	P WASHER; M8 SPLIT LOCK	2	1-3036	X BOLT; M4-.7 X 8MM, ALNHD	2	07733

If you need any assistance please call 1-800-858-3333 to speak with a representative in our Customer Service Center before returning the product.

NOTE: FAILURE TO FOLLOW INSTALLATION INSTRUCTIONS AND NOT USING THE PROVIDED HARDWARE MAY DAMAGE THE INTAKE TUBE, THROTTLE BODY AND ENGINE.

TO START:

1. Turn off the ignition and disconnect the negative battery cable.
NOTE: Disconnecting the negative battery cable erases pre-programmed electronic memories. Write down all memory settings before disconnecting the negative battery cable. Some radios will require an anti-theft code to be entered after the battery is reconnected. The anti-theft code is typically supplied with your owner's manual. In the event your vehicles anti-theft code cannot be recovered, contact an authorized dealership to obtain your vehicles anti-theft code.



2. Loosen the hose clamp that secures the factory intake tube to the throttle body.



3. Disconnect the mass air sensor electrical connection and release the tie wrap that secures the harness to the air filter housing.



4. Remove the two bolts shown that secure the factory intake tube. Release the spring clamp and then disconnect the CCV hose from the factory intake.



5. Release the spring clips that secure the upper air filter housing and then remove the upper housing and intake tube from the vehicle.



6. On 4X4 equipped vehicles, cut the tie wrap that secures the front differential vent line to the lower air filter housing. Lift the lower housing up and remove it from the vehicle.

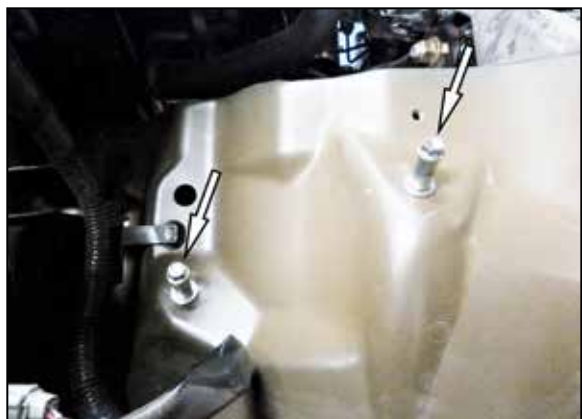

7. Remove the factory air box mounting post.



8. Use the provided tie wrap to secure the front differential vent to wiring harness as shown.



9. Install the provided edge trim onto the heat shield as shown. Install the K&N badge into the heat shield and lock with the provided locking plate.



10. Install the filter adapter into the heat shield and secure with the provided hardware.



11. Install the heat shield into the vehicle and secure with the provided hardware.



12. Install the provided hump coupler onto the filter adapter using the provided hose clamp.



13. Install the straight coupler onto the throttle body and secure with the provided hose clamp.



14. Assemble the CCV hose onto the K&N intake tube as shown.



15. Remove the mass air sensor from the factory housing and install it into the K&N intake tube using the provided hardware.



16. Install the K&N intake tube into the couplers, adjust for best fit and secure the hose clamps.



17. Connect the factory CCV hose to the Assemble K&N CCV hose.



18. Reconnect the mass air sensor electrical connection.



19. Install the K&N air filter and secure with the provided hose clamp.



20. Apply the K&N decal to the intake tube.



21. Reconnect the vehicle's negative battery cable. Double check to make sure everything is tight and properly positioned before starting the vehicle.

22. It will be necessary for all K&N® high flow intake systems to be checked periodically for realignment, clearance and tightening of all connections. Failure to follow the above instructions or proper maintenance may void warranty.

ROAD TESTING:

1. Start the engine with the transmission in neutral or park, and the parking brake engaged. Listen for air leaks or odd noises. For air leaks secure hoses and connections. For odd noises, find cause and repair before proceeding. This kit will function identically to the factory system except for being louder and much more responsive.
2. Test drive the vehicle. Listen for odd noises or rattles and fix as necessary.
3. If road test is fine, you can now enjoy the added power and performance from your kit.
4. K&N Engineering, Inc., requires cleaning the intake system's air filter element every 100,000 miles. When used in dusty or off-road environments, our filters will require cleaning more often. We recommend that you visually inspect your filter once every 25,000 miles to determine if the screen is still visible. When the screen is no longer visible some place on the filter element, it is time to clean it. To clean and re-oil, purchase our filter Recharger® service kit, part number 99-5050 or 99-5000 and follow the easy instructions.