



# Installation Guide

Empire Grille  
For 2018-2023 Jeep Wrangler JL

SKU # AMJPCA00130 & AMJPCA00131 & AMJPCA00132

## STEP 1

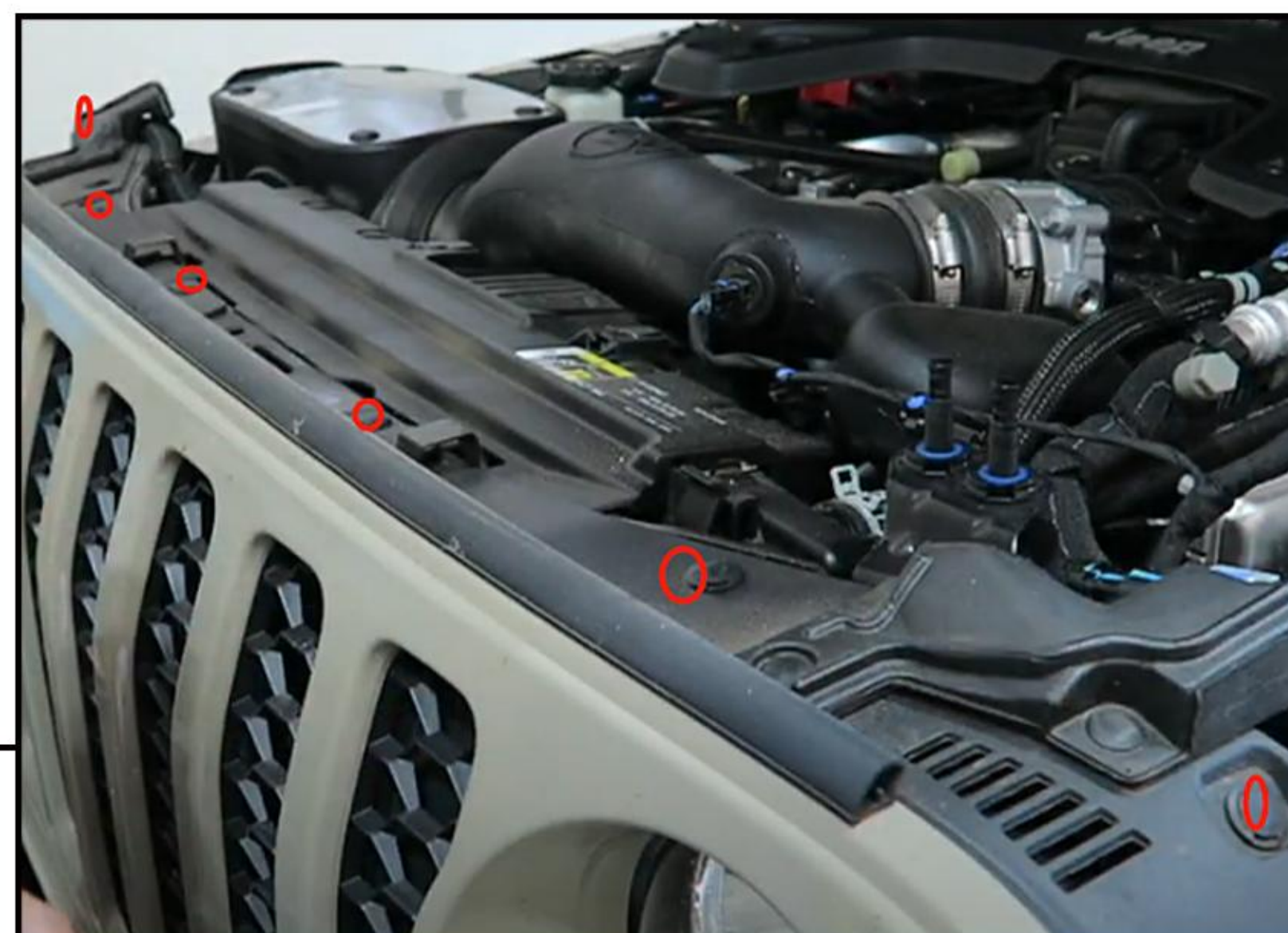

Open the hood,remove 6 push clips at the top of the grille,then pull the two lower corners to release clips and remove the grille.

## STEP 2



Install the 8 retaining clips on the back of the new grille.

## STEP 3

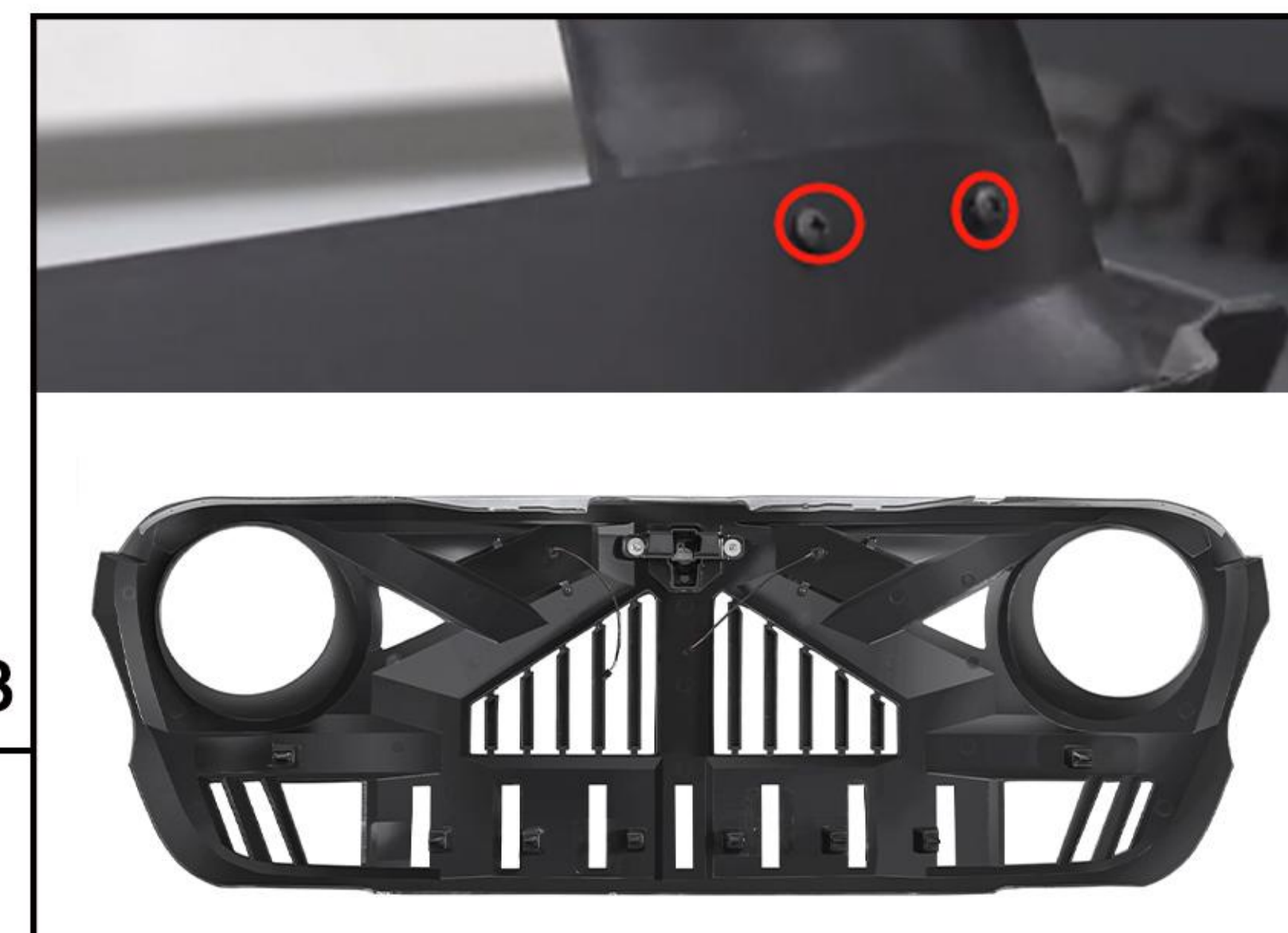

Fixed the bracket with the screws on both sides.If your car is equipped with a camera, please remove the cover plate on the new grille and install the camera bracket. (There is a camera bracket included in the accessories)

## STEP 4

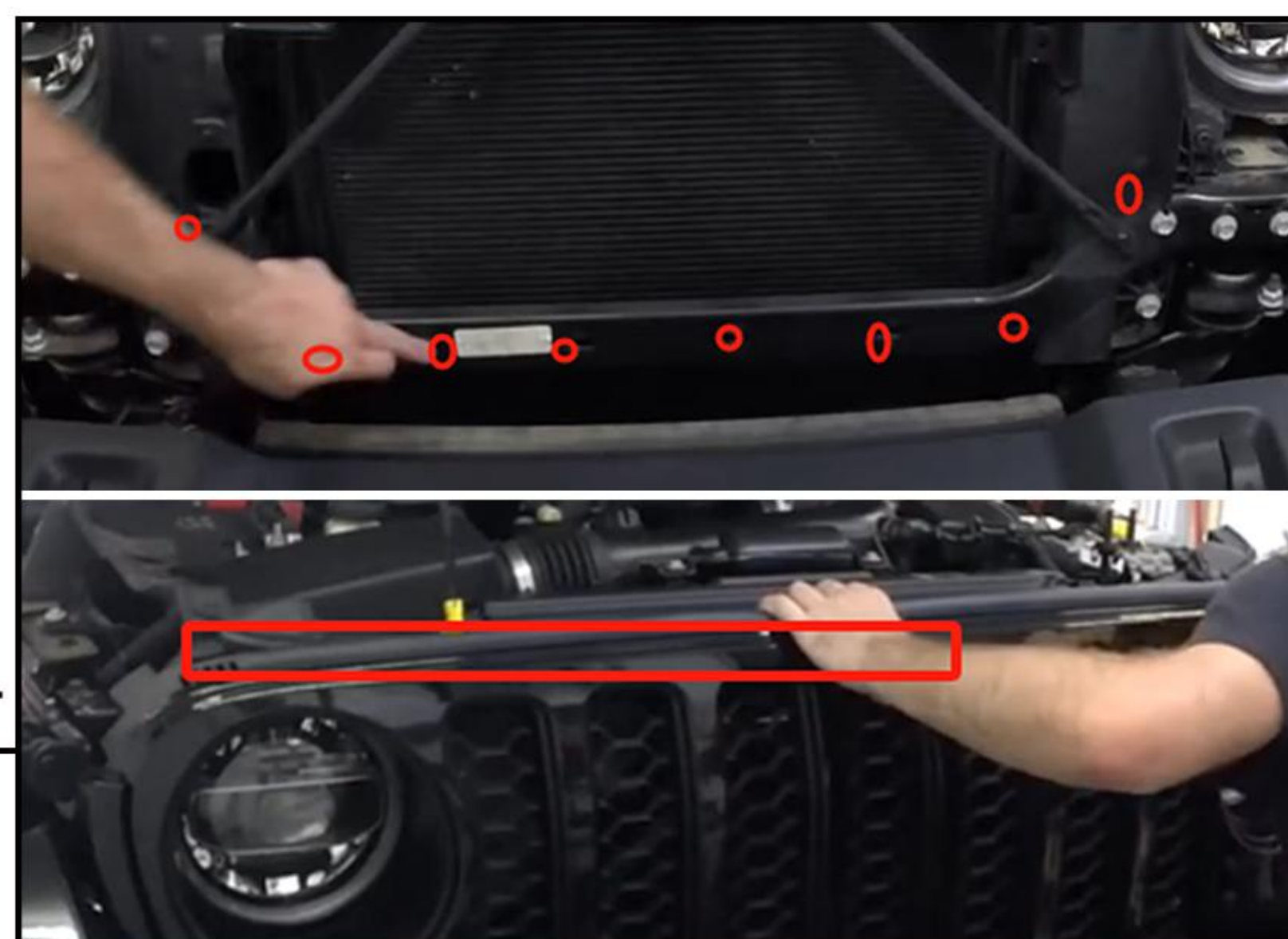

Align the 8 retaining clips with the holes on the car and push inwards.Apply the weather stripping to the new grille.

## STEP 5



Open the fuse box,connect the red wire to the ACC, the black wire to the negative terminal.

## STEP 6



Follow the step 1 in reverse order to install the grille to complete the installation.