



# VELCRO ROLL UP TONNEAU COVER

(2020-2023+ GLADIATOR JT)

---

## INSTALLATION INSTRUCTIONS

### CONTENTS

---

- (1) Tonneau Cover
- (1) Pair of Side Rails
- (6) Clamping Mounting Brackets
- (6) Trail Rail Mounting Brackets
- (2) Allen Keys

### TOOLS REQUIRED

---

Phillips Screwdriver

SKU # JG26174

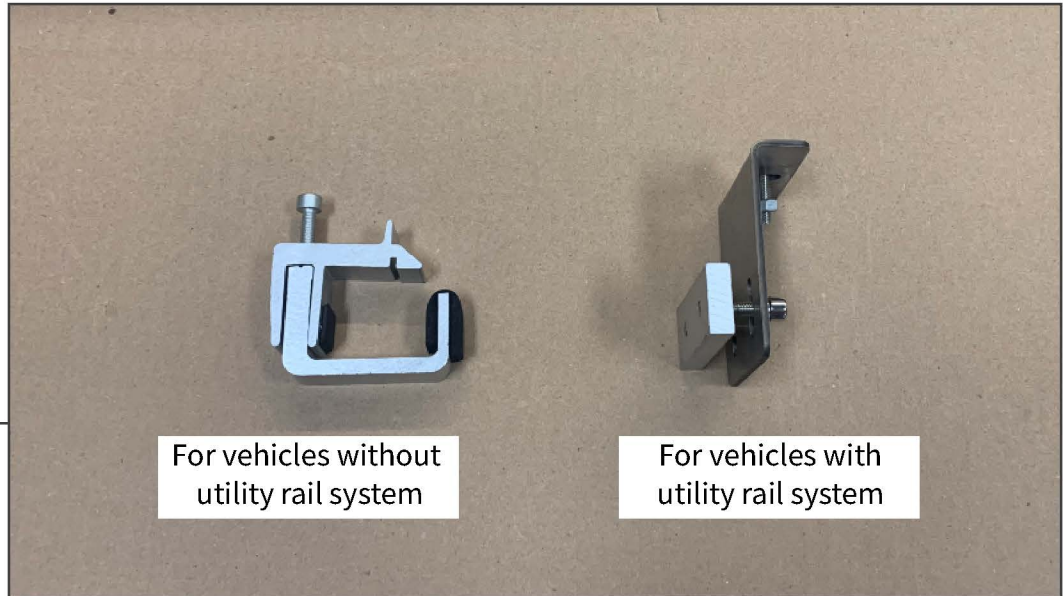

## STEP 1

Determine the mounting brackets needed for the vehicle. Vehicles with and without the utility rail system will require the specific mounting brackets.



## STEP 2

Loosely mount the tonneau cover bed rails to the vehicle using the (3) clamping brackets per side. The clamping brackets clamp inside the vehicle bed rail to the underside of the tonneau cover bed rail.

## STEP 3



Install the tonneau cover to the end of the bed rails. Slide both ends of the cover into the bed rails. Tighten the adjustment knobs and adjustment screws to ensure the cover is secure in the rails.

## STEP 4



Unroll the tonneau cover over the bed and press down the velcro along the sides. Ensure the alignment is even and the tailgate closes. To open the tonneau cover, pull the cable along the middle of the tonneau cover.

Installation is now complete.

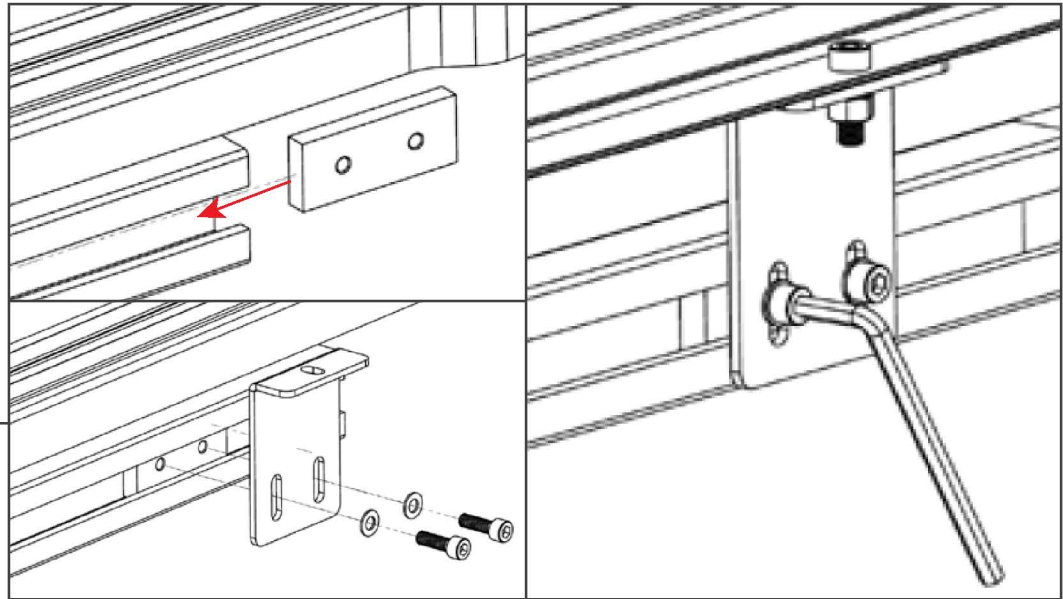

## UTILITY RAIL VEHICLES

Remove the rail end caps from the utility rails. Slide each bracket onto the utility rail. Use the provided hardware to secure the tonneau cover bed rails to the utility rails. Install all hardware loosely at first, then position the bed rails into place. Once positioned, tighten the upper bolt into place, following with the lower utility rail hardware.