



Installation Instructions Safari Style Bikini Top

Vehicle Application:
Jeep® JL Wrangler Unlimited 2024 - Current
Part Number 52612

Installation Tips

Before you begin installing your new Cable Bikini Top, please read all the instructions thoroughly.



WARNING

Do not rely in any way on the components of this product to protect against injury or death in the event of an accident. Never operate the vehicle in excess of manufacturer's specifications.

Read and follow, precisely, all installation instructions provided when installing this product. Failure to do so may result in a poor fit and could place occupants of the vehicle in a potentially dangerous situation.

WEAR SEAT BELTS AT ALL TIMES



CAUTION

Safety glasses should be worn at all times when installing this product.



Tools



Safety Glasses



T25 - T40 - T50
Torx Drivers

Phillips Screw Driver



Ratchet



13mm Socket

- OR -



13mm Wrench

Installation Time



30 minutes

Skill Level



1 - Easy

Support

We're here to help! Go to:
<https://www.bestop.com>
and click on **Need Help?**



<https://www.bestop.com/video-library>



Installation Instructions Safari Style Bikini Top

Vehicle Application:
Jeep® JL Wrangler Unlimited 2024 - Current
Part Number 52612

Sugerencias de Instalación

Antes de empezar a instalar esta unidad, lea atentamente todas las instrucciones.

Para un buen ajuste:

Para facilitar la instalación, el producto debe instalarse a temperaturas superiores a 72 °F (22 °C).

Por debajo de esta temperatura, la tela puede encogerse una pulgada o más, lo que dificultaría su ajuste al vehículo.

Es normal que la tela se contraiga o arrugue cuando está guardada en la caja de empaque. A los pocos días después de la instalación, la tela se relajará y las arrugas desaparecerán.



ADVERTENCIA

Este producto se diseñó principalmente para mejorar la apariencia del vehículo y proteger a los ocupantes de las condiciones climáticas comunes. De ninguna manera piense que los componentes de este producto pueden servir como medio de contención para los ocupantes del vehículo o que pueden protegerlos contra lesiones o la muerte en caso de accidente. Este producto no protegerá a los ocupantes contra caídas de objetos. Nunca conduzca este vehículo fuera de las especificaciones del fabricante.

USE LOS CINTURONES DE SEGURIDAD EN TODO MOMENTO

Lea y siga con precisión todas las instrucciones de instalación que se proporcionan para instalar este producto. Si no lo hace, podría producirse un mal ajuste que colocaría a los ocupantes del vehículo en una situación potencialmente peligrosa.



PRECAUCIÓN

Debe usar gafas protectoras en todo momento durante la instalación de este producto.

Conseils pour l'installation

Lire toutes les instructions au complet avant de commencer l'installation de cet assemblage.

Pour un ajustement sans problème :

Afin de faciliter l'installation, ce produit doit être installé à des températures au-dessus de 72 °F (22 °C).

Sous cette température, le tissu peut rétrécir d'un pouce (2,5 cm) ou plus, ce qui rendra l'ajustement sur le véhicule difficile.

Il est normal que le tissu rétrécisse et plisse pendant qu'il est dans la boîte d'expédition. En quelques jours après l'installation, le tissu se détendra et les plis disparaîtront.



AVERTISSEMENT

Ce produit est conçu principalement pour améliorer l'apparence du véhicule et pour protéger les occupants des conditions météorologiques usuelles. Ne jamais se fier aux composants de ce produit pour se protéger de blessures ou de la mort en cas d'accident. Ce produit ne protégera pas les occupants des chutes d'objets. Ne jamais utiliser le véhicule au-delà des caractéristiques techniques indiquées par le fabricant.

PORTER UNE CEINTURE DE SÉCURITÉ EN TOUT TEMPS

Lire et suivre, très fidèlement, toutes les instructions d'installation fournies lors de l'installation de ce produit. Ne pas suivre cette consigne peut causer une installation inadéquate et mettre les occupants du véhicule dans une situation potentiellement dangereuse.



MISE EN GARDE

Des lunettes de sécurité doivent être portées en tout temps lors de l'installation de ce produit.



Installation Instructions Safari Style Bikini Top

Vehicle Application:
Jeep® JL Wrangler Unlimited 2024 - Current
Part Number 52612

Parts List

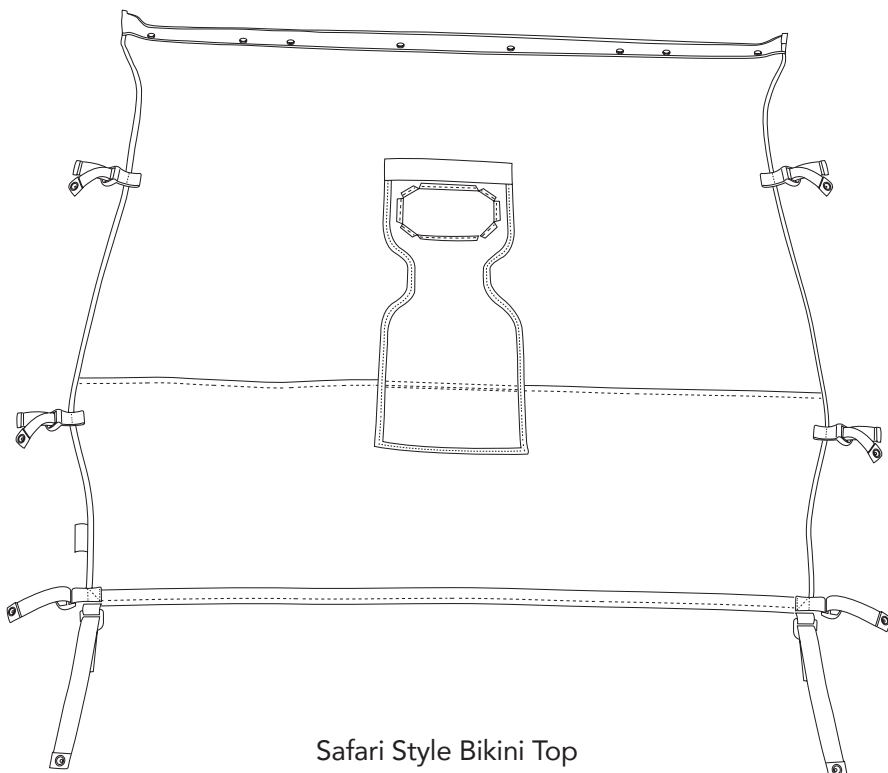

Safari Style Bikini Top
Qty. 1

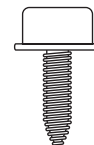

Snap Stud Screw
#8x1"
Part #592.71
Qty. 8



Plastic Bushing
Part #235.91
Qty. 8

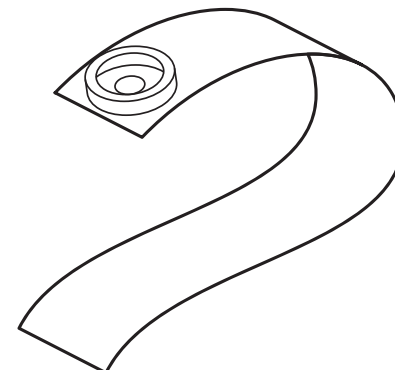

Snap Straps

Short Straps (12")
Part # 665.97
Qty. 6

Long Straps (21")
Part # 591.20
Qty. 2



Tail Clip
Part #338.24
Qty. 8

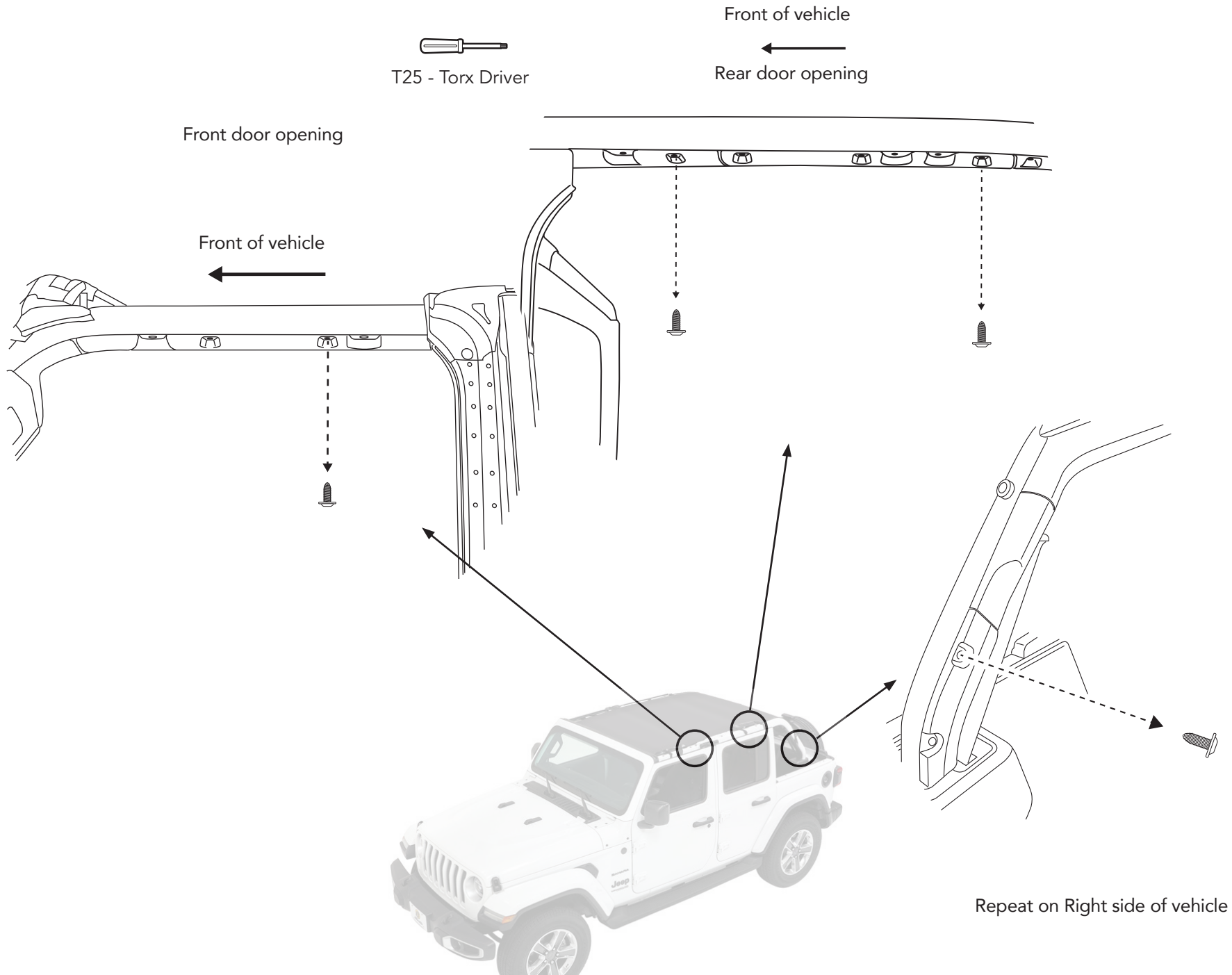

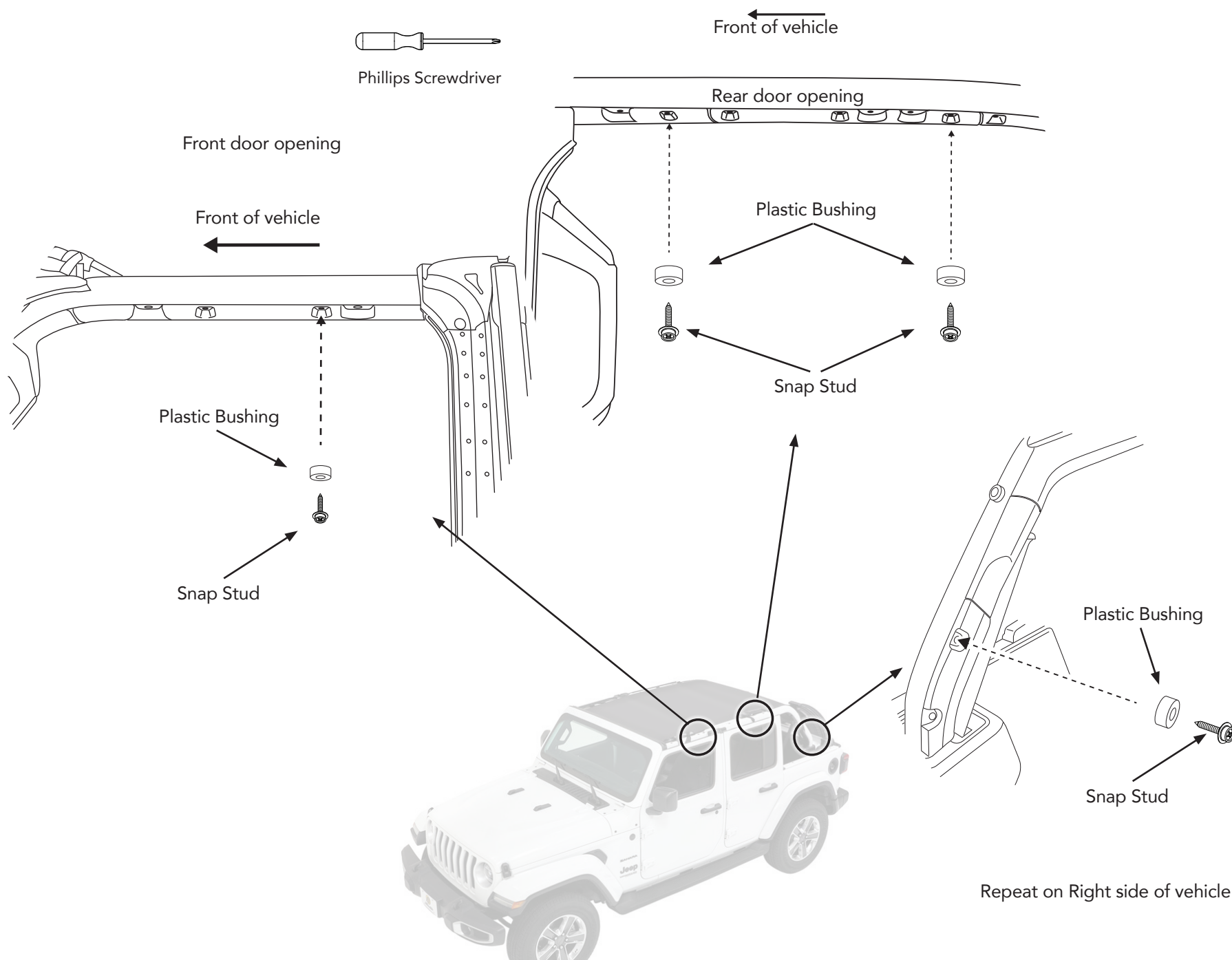

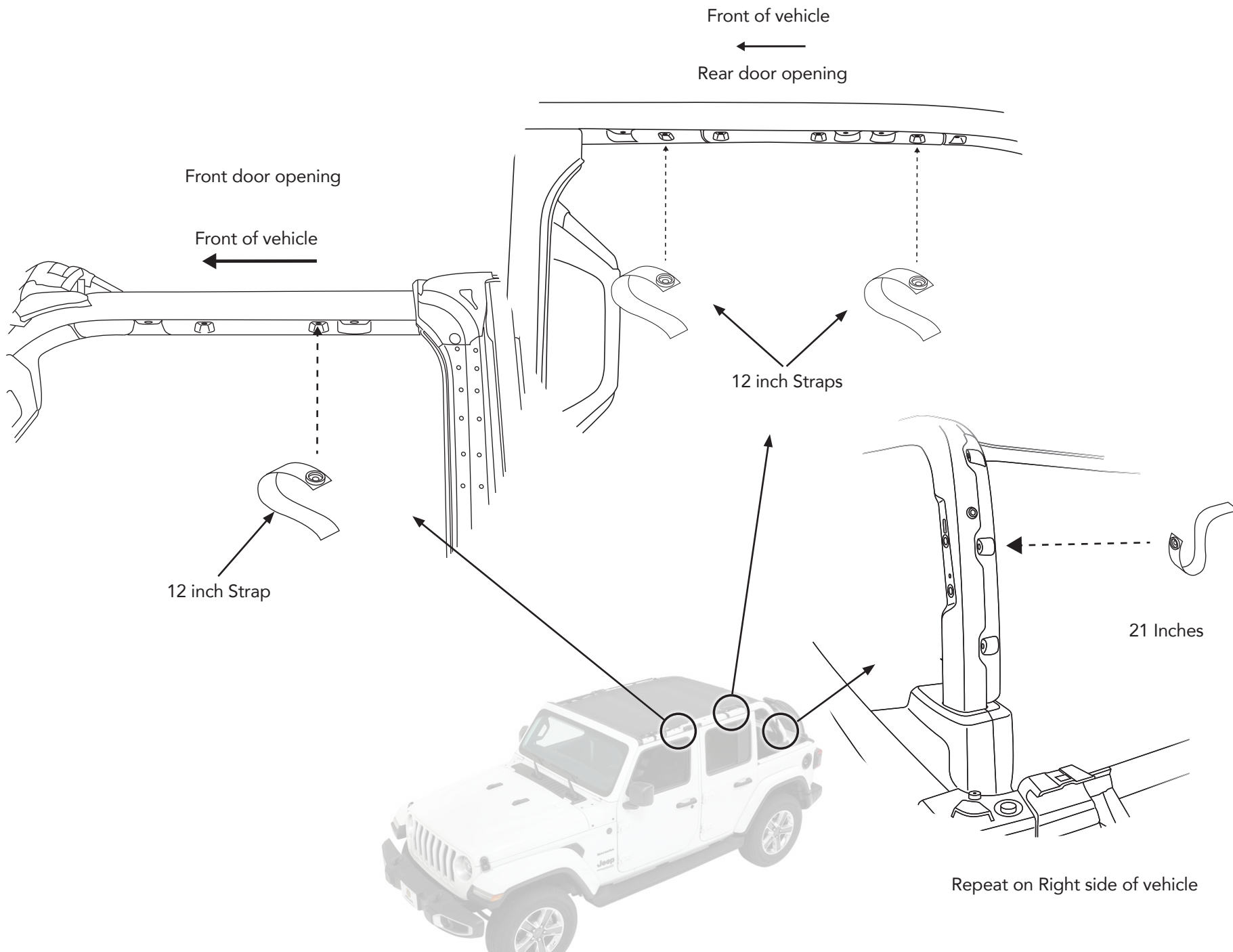

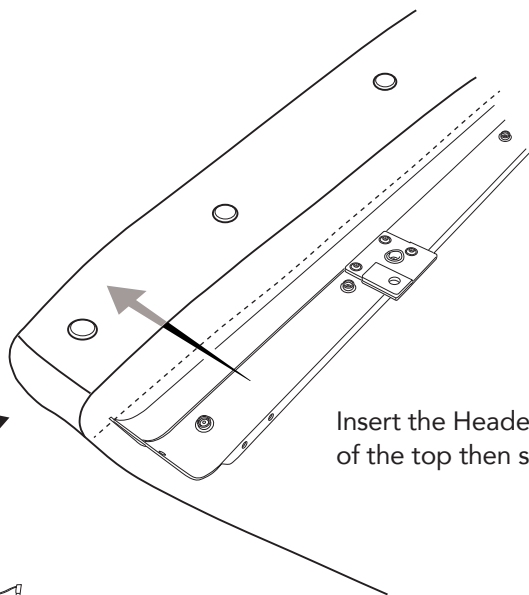
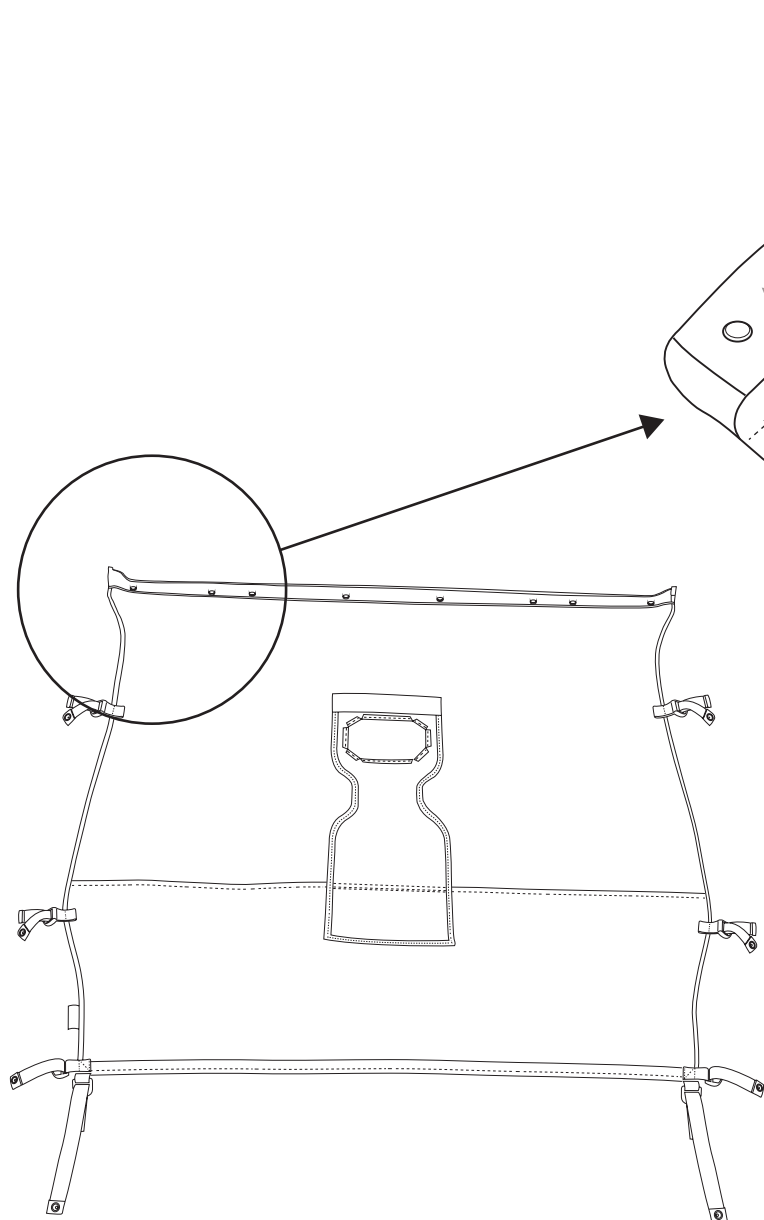

Insert the Header Channel 51244-01 (Sold Separately) into the front of the top then snap the top to the Header Channel.

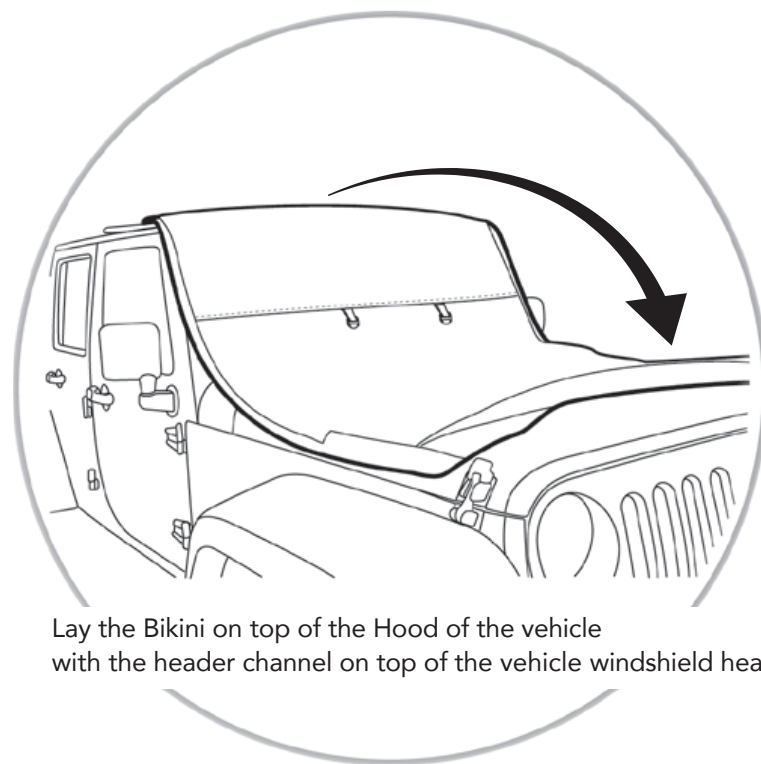

Lay the Bikini on top of the Hood of the vehicle with the header channel on top of the vehicle windshield header.

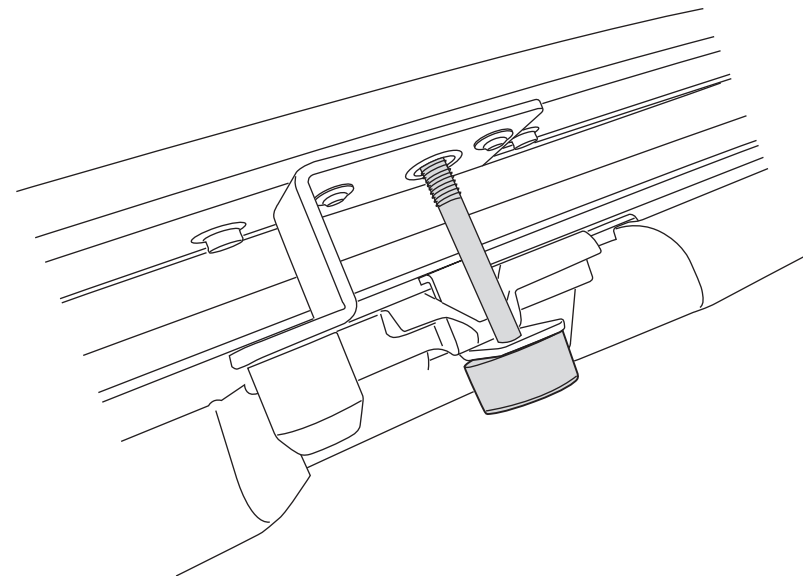
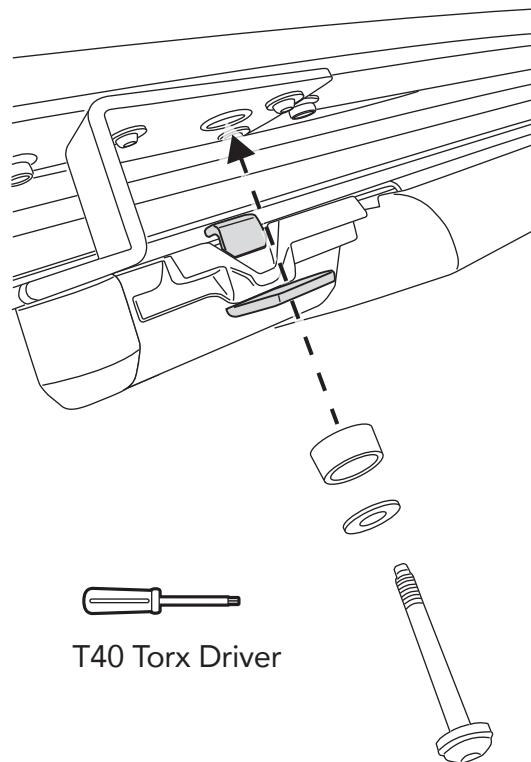
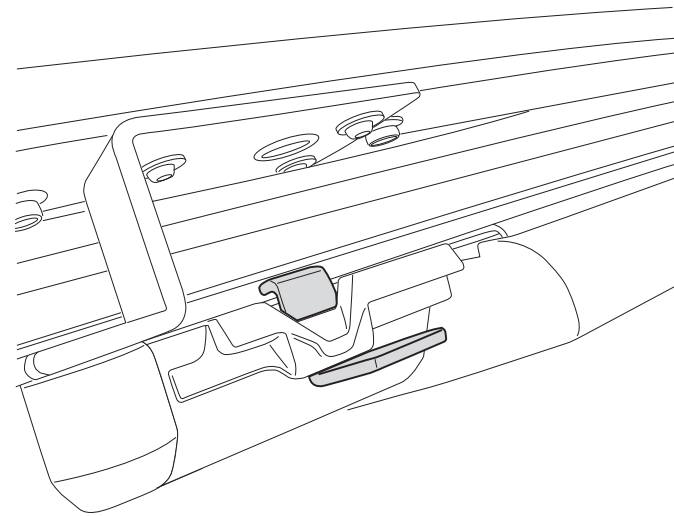
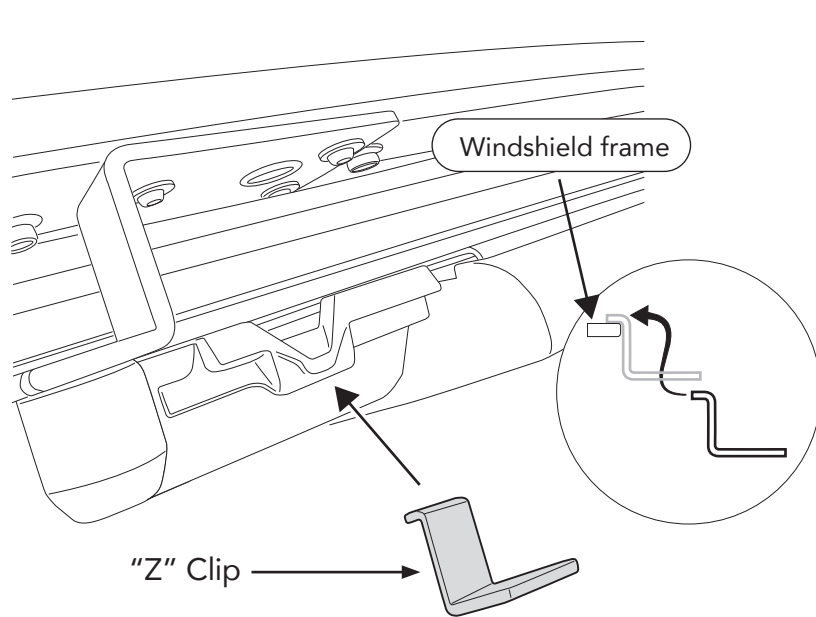

Repeat on other side of header
Leave fasteners loose

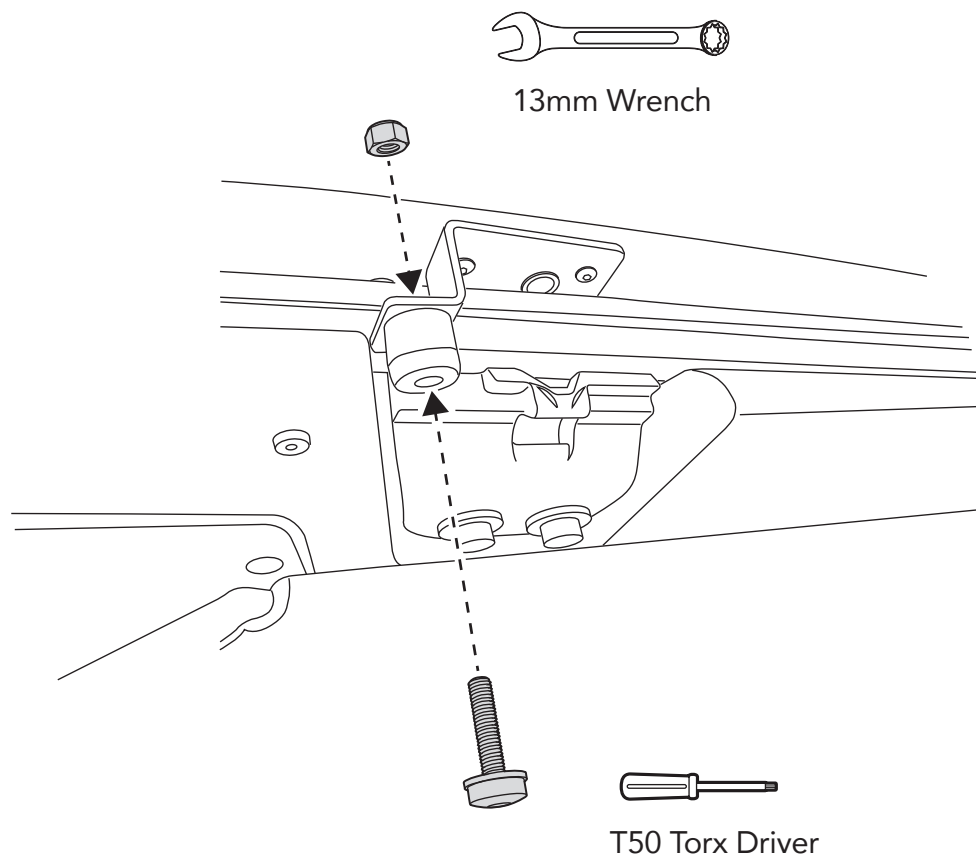

Repeat on other side of header
Leave fasteners loose

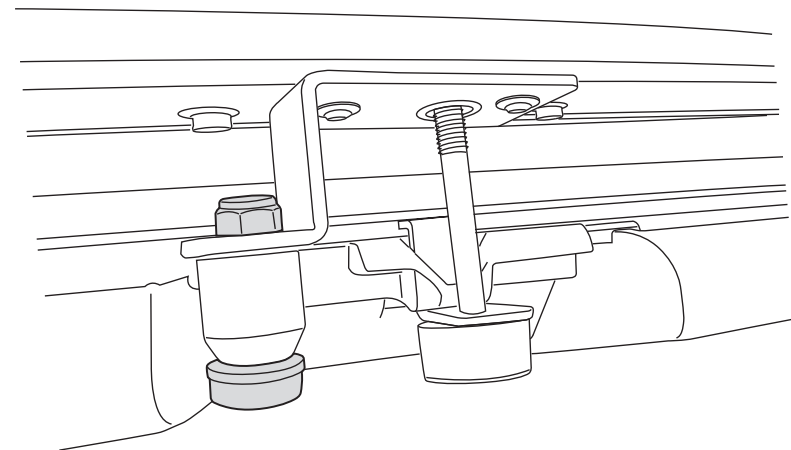

Tighten M8 x 38mm screws first then
tighten the M8 x 80mm screws.

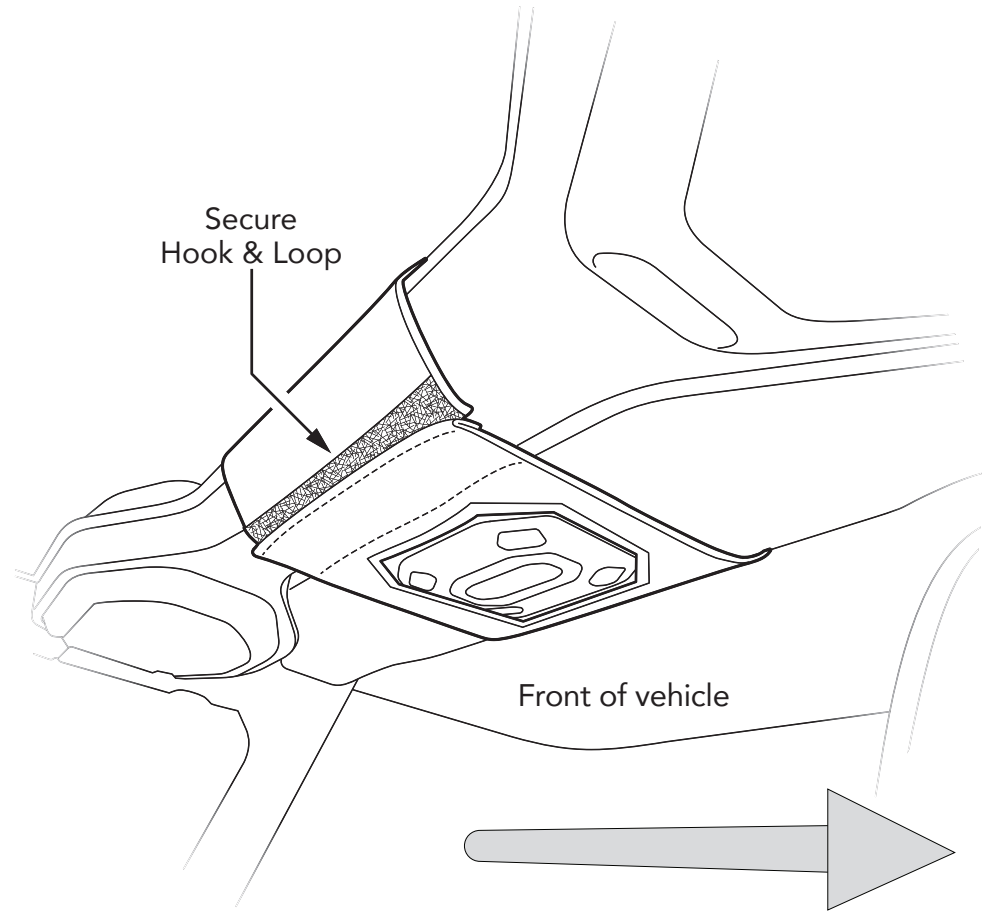
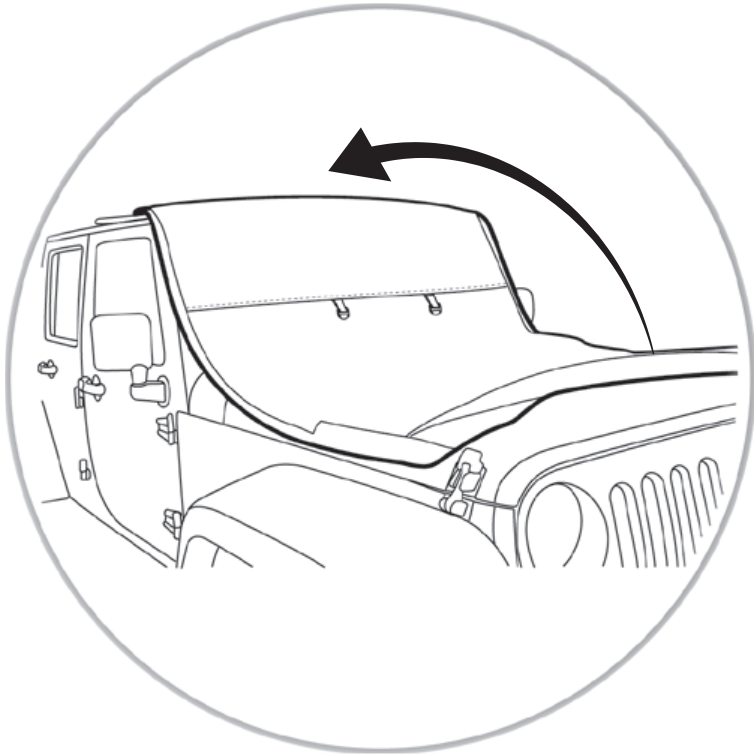

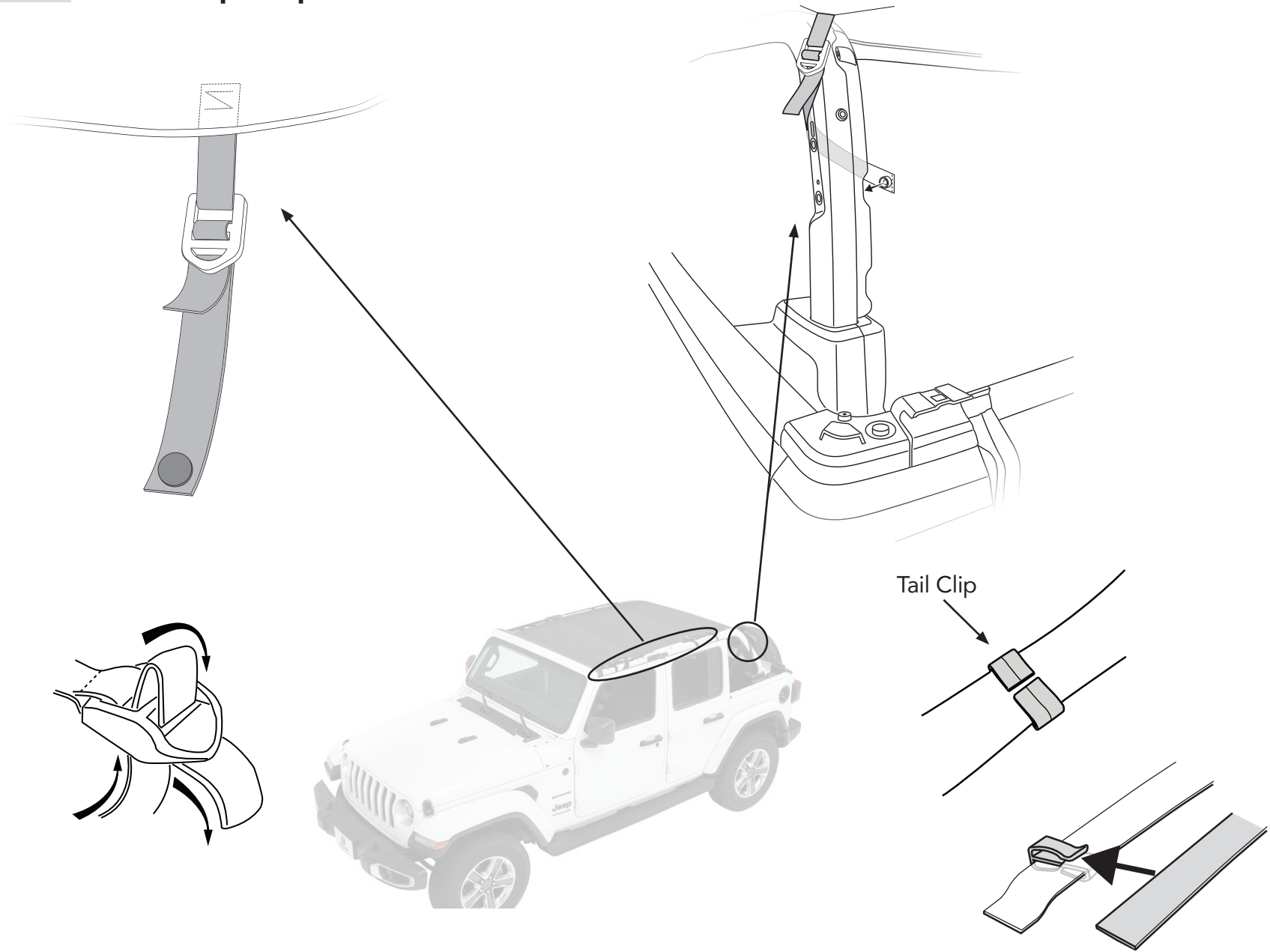

Care and Maintenance of your Bestop Product

Your Bestop product is made of the finest materials available. To keep it looking new and for the maximum possible wear, it will need periodic cleaning and maintenance.

Fabric: The fabric should be washed often using soap, warm water and a soft bristle brush. Rinse with clear water to remove all traces of soap. Bestop recommends using Bestop Cleaner (part no. 11201-00) and Bestop Protectant (part no. 11202-00) for Vinyl fabric and Bestop Twill Protectant (part no. 11207-00) for Twill fabric. Bestop Cleaner and Bestop protectant are specially formulated to provide a total cleaning and protection system. Bestop Cleaner safely removes the toughest stains, will not harm vehicle finishes, is biodegradable and environmentally friendly. Bestop Protectant protects against UV-fading, cracking and hardening, and repels dust, grease, dirt and mildew.

Windows: Keep windows clean to avoid scratching. DO NOT use a brush on the windows! Wash with a water-soaked cloth or sponge and a mild dishwashing detergent. Bestop recommends Bestop Vinyl Window Cleaner (part no. 11203-00), which safely cleans and protects vinyl windows and helps prevent UV damage. NEVER WIPE THE WINDOWS WHEN THEY ARE DRY. Be careful when cleaning snow or frost from the vinyl windows since they are easily scratched and may crack at low temperatures. DO NOT roll the sides or rear window in cold weather. The windows become stiff and will crack. Cracks caused by misuse in cold temperatures are not covered under warranty.

Water: Seeping through at the seams may be stopped by applying 3-M Scotchgard® on the inside of the seams.

Snap: Keep snaps cleaned and lubricated with silicone to help prevent snaps from sticking to the studs. If a snap does become stuck to a stud, use a screwdriver and GENTLY pry apart to prevent permanent damage to the snap or the top fabric.

Zippers: Keeping zippers cleaned and lubricated with Bestop's Zipper Cleaner (part no. 11206-00) will help prevent damage and keep the zippers in smooth working condition. If a zipper opens behind the slider, the slider may have been spread apart. This problem can usually be repaired by using an ordinary pair of pliers to bring the sides back into parallel. Return slider to the end of the zipper in the normal Open position. Squeeze lightly at first and test the zipper. If the zipper continues to remain open squeeze more firmly with the pliers and try the zipper again. Repeat this procedure until the zipper operates correctly.

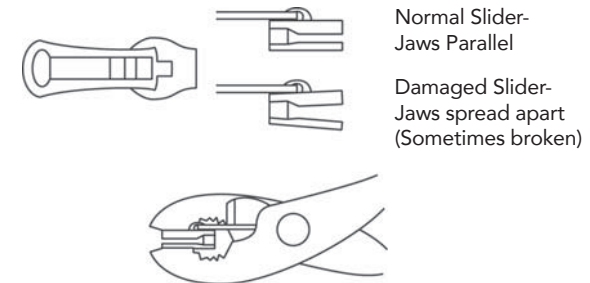

For Bestop Warranty Information, Please go to;
<https://www.bestop.com/help/warranty-information/>





FIND THE RIGHT BIKINI® TOP

| BIKINI TYPE | | YEAR | MODEL | DRILLING REQUIRED | PARTS NEEDED | DOOR SURROUNDS | TOP MATERIAL | PART NUMBER |
|-------------------------------------|---|--------------|----------------------|-------------------|--|------------------------|---------------------------------------|-------------|
| SUNSHADE |  | 2010-18 | Jeep Wrangler JK | No | Compatible with Sunrider for Hardtop ONLY | N/A | Mesh | 52406 |
| | | 2007-18 | Jeep Wrangler JK | No | Compatible with soft tops except Trektop and Trektop Pro | N/A | Mesh | 52405 |
| TRADITIONAL BIKINI |  | 1976-91 | CJ7/CJ8/ Wrangler YJ | Yes | 51209 | N/A | Black Crush, Tan, Charcoal/Gray, Mesh | 52508 |
| | | 1976-83 | CJ5 | Yes | 51209 | N/A | Black Crush, Tan | 52507 |
| | | 1972-80 | Scout II | Yes | 51207 | N/A | Black Crush | 52550 |
| | | 1966-77 | Bronco | Yes | 51206 | N/A | Black Crush | 52542 |
| | | 1964-84 | FJ40 | Yes | 51209 | N/A | Black Crush | 52540 |
| | | 1951-81 | M-38A1/CJ5/ CJ6 | No | Factory Channel | N/A | Black Crush | 52505 |
| STRAPLESS HEADER BIKINI |  | 1997-02 | TJ | Yes | 51210 | N/A | Black Denim, Spice | 52521 |
| | | 1986-91 | YJ | Yes | 51209 | N/A | Black Crush, Black Demin | 52509 |
| | | 1992-95 | YJ | Yes | 51209 | N/A | Black Denim, Spice | 52519 |
| | | 1980-86 | CJ7 | Yes | 51209 | N/A | Black Crush, Black Demin | 52518 |
| | | 1986-94 | Samurai | No | Factory Channel | N/A | Black Crush, Black Denim | 52561 |
| | | 1995-98 | Tracker/Sidekick | No | Factory Channel | N/A | Black Denim | 52562 |
| | | 1988-94 | Tracker/Sidekick | No | Factory Channel | N/A | Black Denim | 52570 |
| STRAPLESS SAFARI BIKINI |  | 1997-02 | TJ | Yes | 51210 | N/A | Black Denim, Spice | 52530 |
| | | 1992-95 | YJ | Yes | 51209 | N/A | Black Denim, Charcoal/ Gray, Spice | 52529 |
| CABLE STYLE TARGA AND SAFARI BIKINI |  | 2020-Current | Gladiator | No | Included | N/A | Black Diamond | 52615 |
| | | 2018-Current | JL | No | Included | N/A | Black Diamond | 52607 |
| | | 2018-Current | JLU | No | Included | Factory Door Surrounds | Black Diamond | 52608 |
| | | 2010-18 | JK | No | Included | Factory Door Surrounds | Black Diamond, Mesh | 52593 |
| | | 2010-18 | JKU | No | Included | Factory Door Surrounds | Black Diamond, Mesh | 52594 |



FIND THE RIGHT BIKINI® TOP

| BIKINI TYPE | | YEAR | MODEL | DRILLING REQUIRED | PARTS NEEDED | DOOR SURROUNDS | TOP MATERIAL | PART NUMBER |
|----------------------------|--|--------------|------------------|-------------------|---|----------------|--------------------------|-------------|
| HEADER STYLE TARGA BIKINI | | 2018-Current | JL/Gladiator | No | 51244 | N/A | Black Diamond | 52606 |
| | | 2010-18 | JK (2-Door) | No | 51243 | N/A | Black Diamond | 52586 |
| | | 2007-09 | JK (2-Door) | No | 51243 | N/A | Black Diamond | 52580 |
| | | 2003-06 | TJ | No | 51238 | N/A | Black Diamond | 52528 |
| | | 1997-2002 | TJ | No | 51238 | N/A | Black Denim, Spice | 52525 |
| HEADER STYLE SAFARI BIKINI | | 2020-Current | Gladiator | No | 51244 | N/A | Black Diamond | 52614 |
| | | 2018-Current | JLU | No | 51244 | N/A | Black Diamond | 52610 |
| | | 2010-18 | JKU | No | 51243 | N/A | Black Diamond | 52584 |
| | | 2010-18 | JK | No | 51243 | N/A | Black Diamond | 52583 |
| | | 2007-09 | JKU | No | 51243 | N/A | Black Diamond, Mesh | 52581 |
| | | 2004-06 | LJ/TJU | No | 51238 | N/A | Black Diamond | 52544 |
| | | 2003-06 | TJ | No | 51238 | N/A | Black Diamond, Mesh | 52532 |
| | | 1997-02 | TJ | No | 51238 | N/A | Black Denim, Spice, Mesh | 52531 |
| SUN TARGA BIKINI | | 2018-Current | JL/JLU/Gladiator | No | N/A | N/A | Mesh | 52410 |
| | | 2007-18 | JK/JKU | No | N/A | N/A | Black Diamond, Mesh | 52400 |
| | | 1997-2006 | TJ | No | N/A | N/A | Black Diamond, Mesh | 52403 |
| SUN SAFARI BIKINI | | 2020-22 | Gladiator | No | N/A | N/A | Mesh | 52413 |
| | | 2018-Current | JLU | No | N/A | N/A | Mesh | 52411 |
| | | 2018-Current | JL | No | N/A | N/A | Mesh | 52412 |
| | | 2007-18 | JKU | No | N/A | N/A | Black Diamond, Mesh | 52401 |
| | | 2007-18 | JK | No | N/A | N/A | Black Diamond, Mesh | 52402 |
| | | 1997-2006 | TJ | No | N/A | N/A | Black Diamond, Mesh | 52404 |
| ACCESS SAFARI BIKINI | | 2021-Current | Bronco 2DR | No | Compatible with Trektop, OE Soft top and OE Hardtop | N/A | Mesh | 52420 |
| | | 2021-Current | Bronco 4DR | No | Compatible with Trektop, OE Soft top and OE Hardtop | N/A | Mesh | 52421 |