

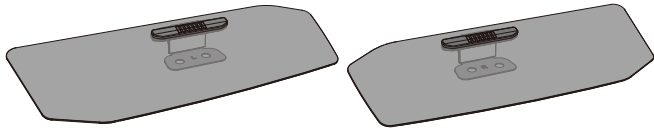

Sun visor user's manual

It is compatible with both right-hand-drive and left-hand-drive models.



MHG-050L
Left side sun visor

MHG-050R
Right side sun visor

Compatible car models

Jeep Wrangler(JL)
Jeep Wrangler(JL) : From Dec 2017~
It is compatible with four-door and two-door models.
SPORT/WILLYS/SAHARA/RUBICON/ALTITUDE/TIDE/392
*Will not fit the following Wranglers:
Sky One Touch Power Top vehicles
Jeep WRANGLER (4xe) : 2021~
SAHARA/RUBICON/ALTITUDE
Jeep Gladiator(JT) : From Feb 2019~

This product is compatible with vehicles as of August 2024, the survey date.
This product may not be compatible with vehicles that have undergone a minor change after the date of the survey.

Thank you for your purchase.
Please read this user's manual in its entirety before using the product.

Specialized skills and knowledge are required to properly install this product.
If you are not confident that you can complete installation on your own, we recommend hiring a specialist.
* Note to hired installation specialists
Make sure to return this user's manual to the owner after installation.

This user's manual contains important warnings and user notices. Please keep it in an easily accessible location inside the vehicle to facilitate reference at any time.

Product Features

- This product effectively filters sunlight and reduces sun glare.
- The screen filters the sunlight enhancing better visibility for traffic signals and road signs.
- It's convenient when the factory sun visor cannot be used after installing a 300mm wide mirror or similar accessories.
- Since the hinge part uses a damper hinge, it fits perfectly with the factory sun visor.
- The UV400-cut polycarbonate material protects your eyes from harmful UV rays.
- This product allows you to cut sunlight on the front windshield side with the sun visor screen and on the side window side with the original factory sun visor.

⚠ WARNING

- SEIKOSANGYO CO., LTD. is not responsible for any accident, breakdown, malfunction or loss resulting from incorrect installation, disassembly or alteration of the product caused by failure to follow the warnings and user notices in this manual.

⚠ User Notice

- You may find scratches on the protective film of the screen surface due to the manufacturing process.
- * After installation is complete, please remove the protective film from both sides of the screen before use.
- Please be aware that the level of vision may become narrower depending on the installation and usage of this product.
- To ensure compliance with road transport vehicle safety standards, please avoid using this product in the following ways.
 - * Please refrain from using it when there is no sunlight.
 - * Please refrain from using it in the dark or in tunnels. ※It can cause accidents.
 - * Do not install other than the specified locations.
- Perform the installation in broad daylight. Installing this product involves removing screws from the vehicle and reusing them again. Take care to avoid losing them in this process.
- * Using screws of different dimensions and specifications may result in insufficient mounting strength being applied.
- After installing, regularly retighten the bolts (once per 320 to 640 miles).
- When cleaning this product, do not rub hard with tissue paper or other similar materials. Use a soft cloth, such as the ones for eyeglasses.
- For safety, drivers should not adjust the screen's angle while driving. Always stop the vehicle in a safe location before making any adjustments.
- Although it is made from materials with excellent heat and weather resistance, it may deform or deteriorate over time or when left inside a vehicle under intense heat.
- * We are not responsible for any accidents, malfunctions, or damages resulting from failure to follow the precautions listed in the user's manual.
- While materials with outstanding heat-resistant and weather-resistant properties are used in this product, the product may deform or deteriorate due to conditions inside the vehicle in extreme heat or due to aging and other factors.



azuto.co.jp/en/



548MHG-050014A

Contact Information for Product-related Inquiries

Customer Service Center E-mail : azuto-mk@seikosangyo.co.jp 561-1, Komatsugawa, Yoshikawa-shi, azuto.co.jp/en/ Saitama , 342-0043, Japan

- * Jeep is a registered trademark of Stellantis N.V.
- * AZUTO is a registered trademark of SEIKOSANGYO CO., LTD.
- * Planning, Design and Quality control for this product were carried out in Japan.
- * Product specifications and appearance are subject to change without prior notice.
- * All other product names, etc. used in this document are the trademark or registered trademark of their respective owners.

SEIKOSANGYO CO., LTD.

Main material PC

FX-1 Made in CHINA

Parts

Please check to make sure that all parts shown below are present.

- * Since the installation requires the use of the vehicle's onboard tools, please check the following tools.

① Sun visor (Product)	1 piece
② Cushion tape (Accessory)	1 sheet

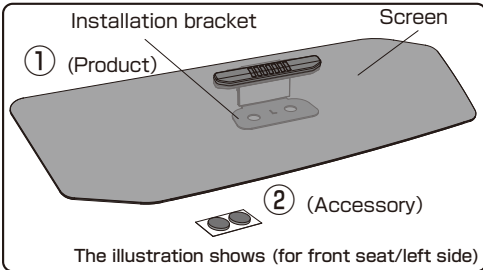

* You will need to use the onboard ratchet wrench and a Torx (T40) bit for the installation.



Installation positions

right-hand drive / left-hand drive vehicle sun visor installation position

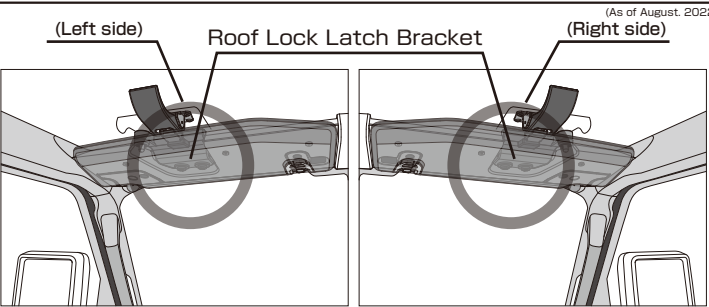

advice

For installation and removal, it is recommended to lower the vehicle's factory sun visor and rotate it toward the door side before proceeding with the work. Additionally, please prepare the vehicle's onboard tools, as they will be used during the process.

Installation procedure

1. Lower the vehicle's factory sun visor and check the position of the roof lock latch bracket.
 2. Please use the Torx (T40) from the onboard tools and follow the steps in the order from (1) to (8) for the installation process.
- * For removal, simply reverse the installation steps.
 - * The illustration explains the installation for the right-side sun visor. The left side is installed using the same method.

- (1) Lower the factory sun visor, remove the clip, rotate the sun visor toward the door, and then pull the sun visor backward.

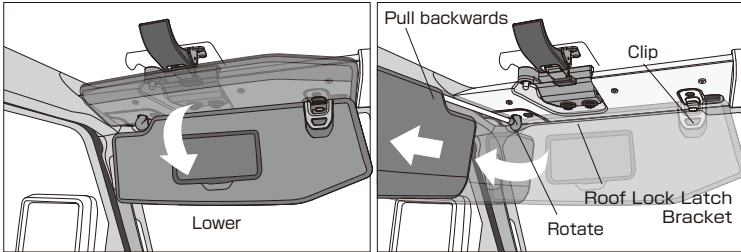

- (2) Remove the screws from the vehicle's roof lock latch bracket using the ratchet wrench and the Torx (T40) bit.

- * For vehicles from 2023 and earlier, the bracket is made of metal, so please support it with your hand during the process to prevent the bracket from falling.

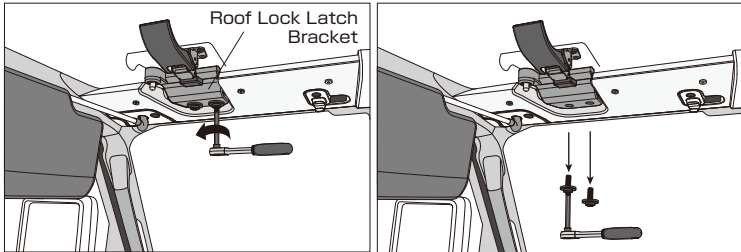

- Loosen the screws in an anti-clockwise direction to remove them.
- * The screws that were removed will be used during the installation of this product.

- (3) Open the mounting bracket of this product as shown in the illustration. On the backside of the mounting bracket, you will find L/R markings. Please confirm the left side with "L" and the right side with "R" before proceeding with the installation.

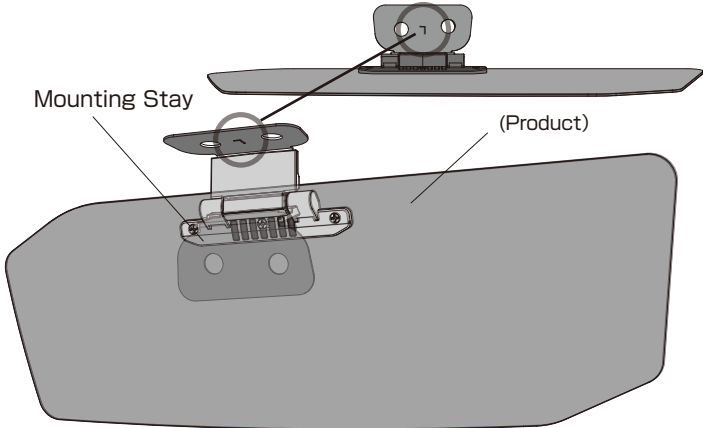

- (4) Align the screw holes, and use the screws removed in step (2) to temporarily secure the mounting bracket.

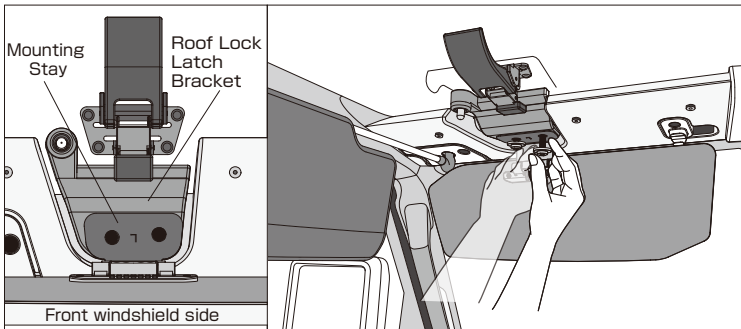

- (5) Using the screws removed in step (4), install the product. Tighten the two screws using the Ratchet wrench and Torx (T40), paying attention to the position of the pins on the hardtop roof.
- * Please be careful not to over-tighten the screws as this might damage the threads.
 - * Please tighten the screws with a standard torque value of about 8.8ft·lb (12N·m).

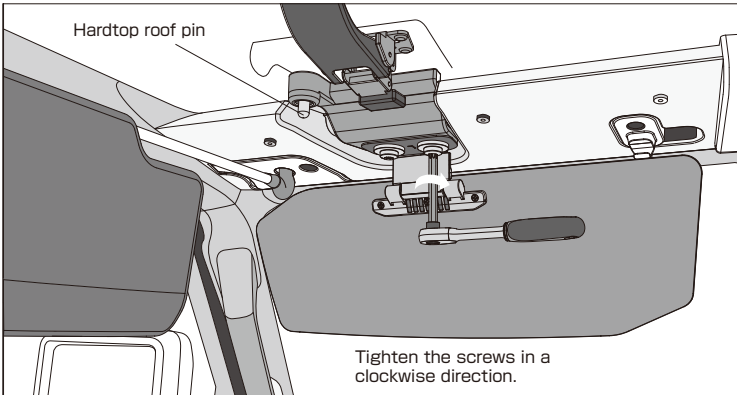

- (6) Secure the factory sun visor with the clip, then return it to its original position and store it properly.

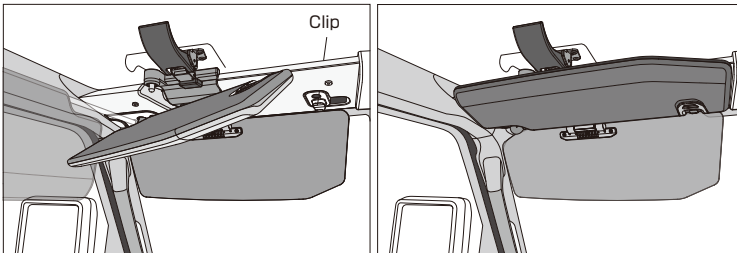

- * To remove, follow the installation procedure in reverse.

- (7) Attach the included cushion tape as shown in the illustration. After attaching the cushion tape, remove the protective film from the backside of the screen.
- * The protective film is applied on both the front and back sides of the screen.

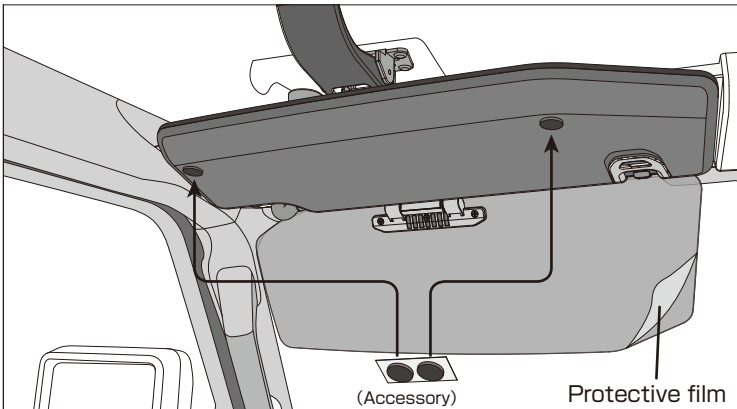

- (8) Lift the screen and place it on the factory sun visor side, then remove the protective film from the front side of the screen to complete the installation.

