

# Installation Guide

## Front Lower Control Arm Inner

Z 5061

Suits: Dyna LH80, YH81 11/85 - 5/95

Dyna YY100 - 5/95 - on

Hi-Ace LH51, 60, 61, 70, 71, YH50, 51, 61, 71, 1/83 - 9/89

Hi-Ace LH103, 113, 125, RZH103, 113, 125, 10/89 - on

Hi-Lux 4 Runner LN61, YN63 (Surf) 4WD, 11/85 - 9/89

Hi-Lux 4 Runner LN130, RN130, VZN130, YN130 (Surf) 4WD, 10/89 - 6/96

Hi-Lux RN105, LN106 4WD, 10/88 - 11/97

Hi-Lux LN107, 111RN106, 110, 111, 4WD, 10/88 - 12/97

Hi-Lux KZN165, LN167, 172, RZN169, 174 4WD, 11/97 - 4/05

**N.B:** These instructions should be used in conjunction with the workshop manual.

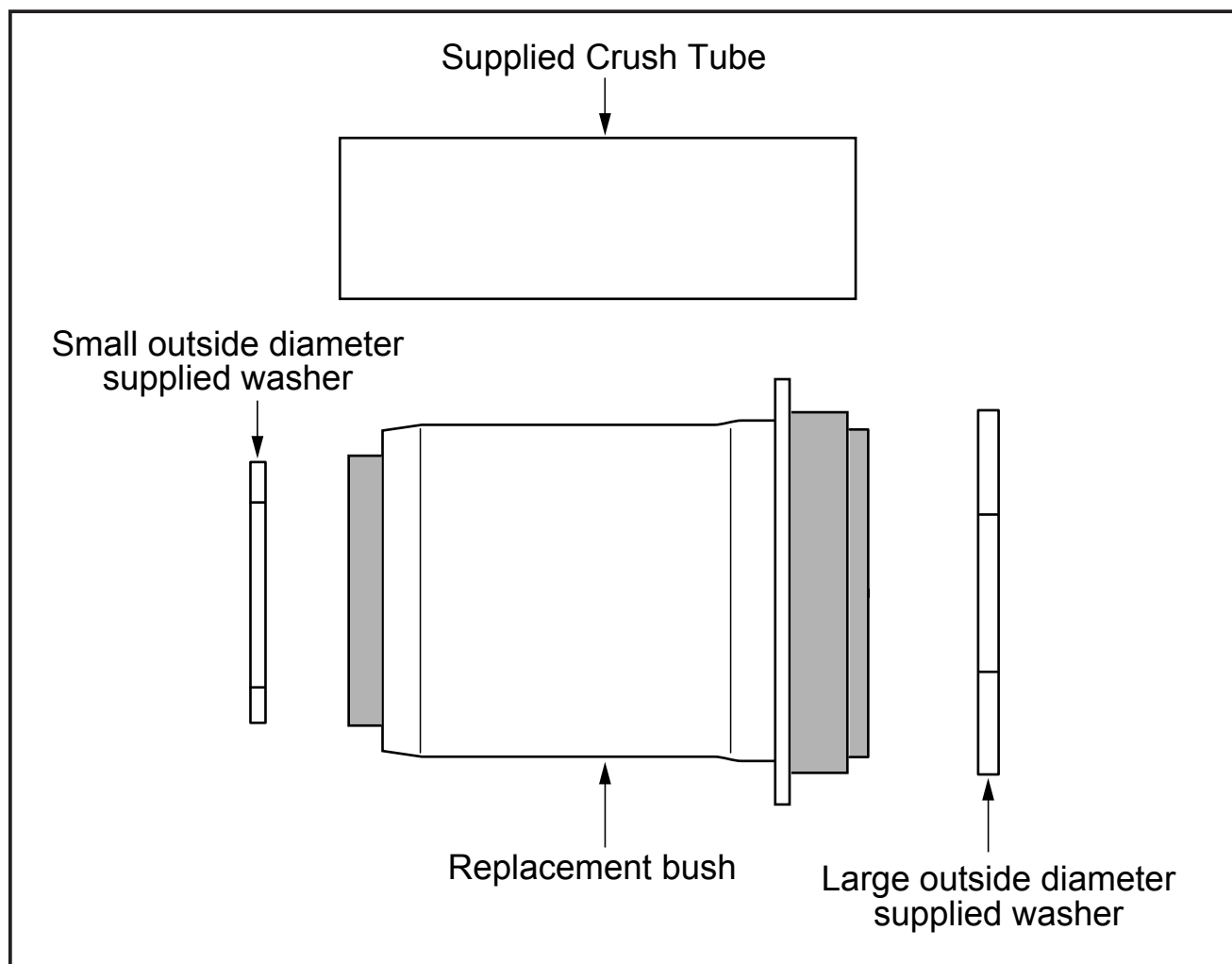

**N.B:** It is recommended that a licenced workshop or trades person carry out the above procedure and that workshop manual and relevant safety procedures are followed in addition to the above.

# Instructions

## General Control Arm Shell Bushing Removal

**N.B:** This instruction sheet should be used in conjunction with the workshop manual and proper safety procedures followed.

1. Confirm your new bushings have an outer steel shell. If no, you may have to leave the original shell in the control arm.
2. In order to remove the rubber only, you may apply heat to the bonded area of the bushing. Careful to not over heat - there should be no flames present.
3. If pressing bushings out of A-arms or open eye-rings, be sure to measure the control arm and support the arm prior to pressing - please see images 1,2 and 3.
4. Check the bushing OD - if the bushing is stepped, note the 2 different OD's and pressing direction.
5. If the vehicle has factory adjustment bolts, there may be a washer as part of the original bushing. This may need to be removed and re-used with new supplied bushing. Please see image 4. This is due to the slot in the chassis.
6. When installing new bushings, grease ID and face of bushings with the supplied grease only.
7. All bolts should be re-torqued to manufacturers specifications - this is best done at ride height.

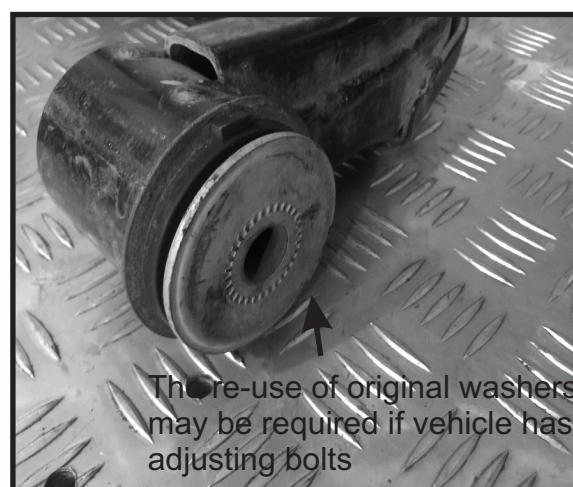
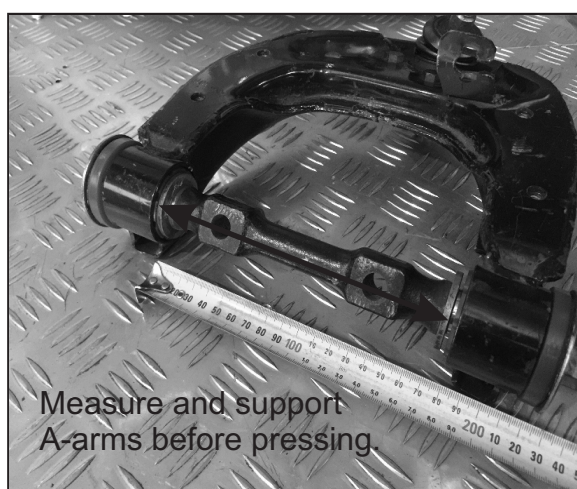
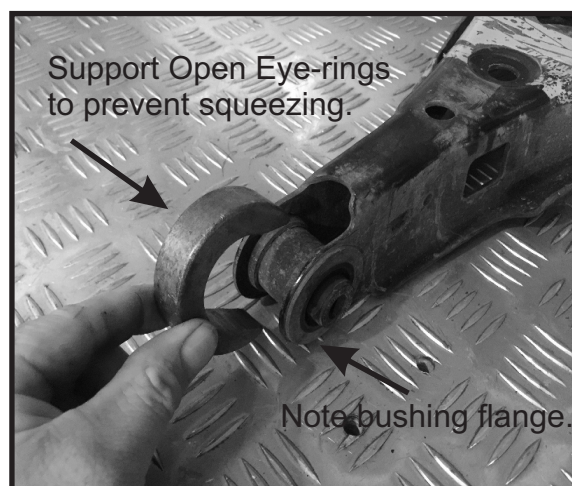
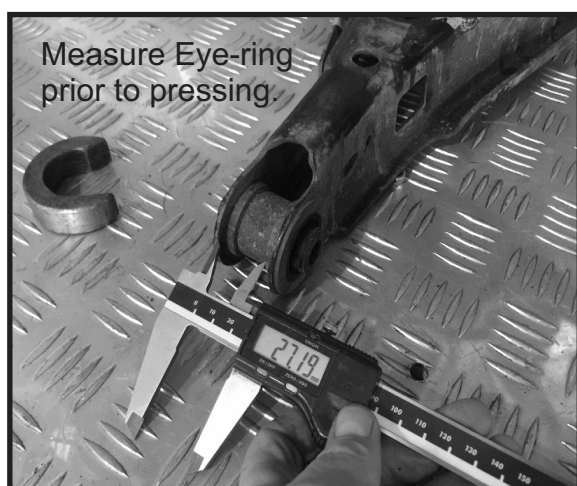

**N.B:** It is recommended that a licenced workshop or tradesperson carry out the above procedure and that workshop manual and relevant safety procedures are followed in addition to the above.