

Complete Soft Top, TJ with Full Doors

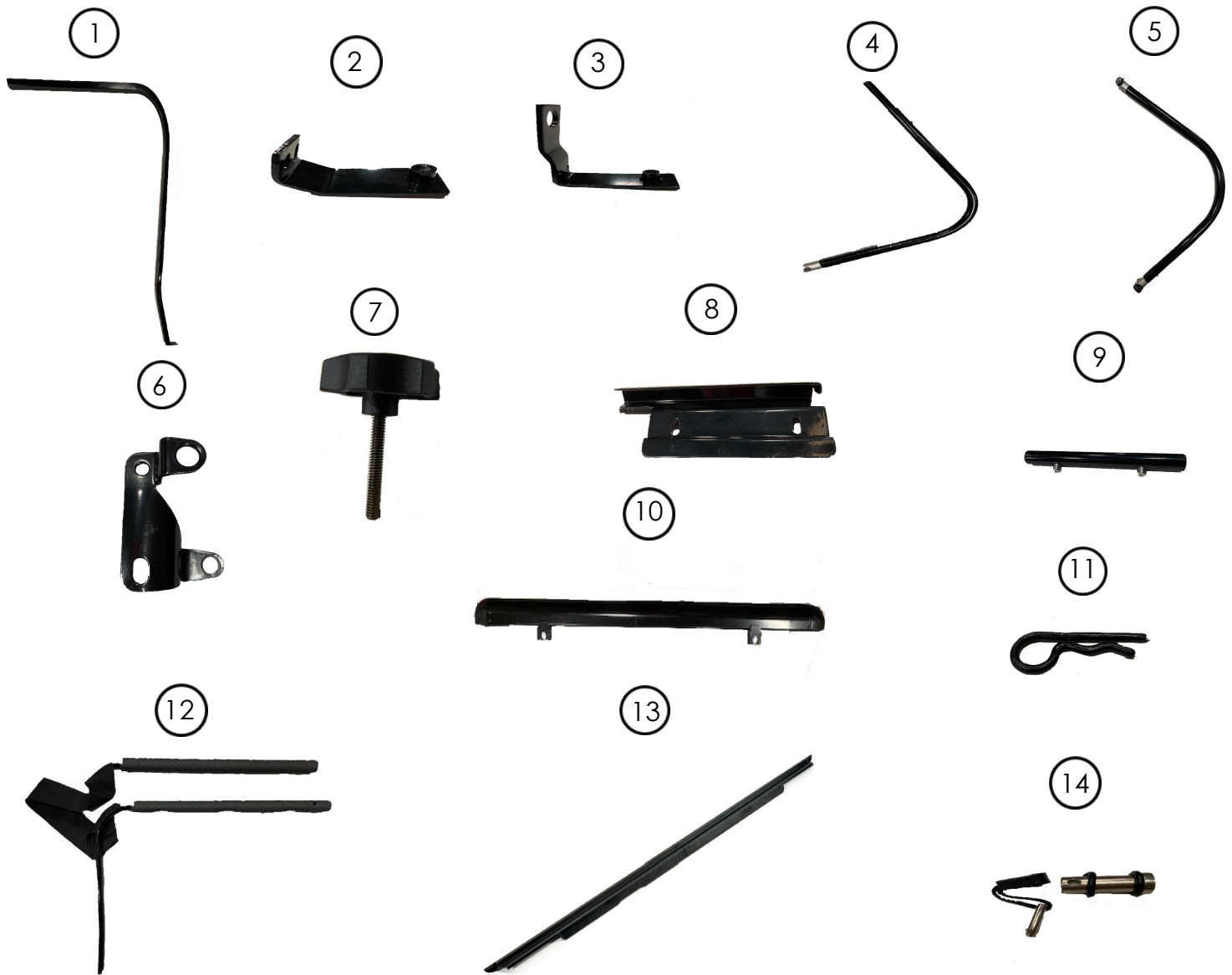

Components

1. Door Surround.....(2)	8.Tailgate Brackets.....(2)
2. Door Surround Front Bracket.....(2)	9.Connector Tubes.....(2)
3. Door Surround Rear Bracket.....(2)	10.Windshield Channel.....(1)
4. Rear Bow Legs.....(2)	11.Cotter Pin.....(2)
5. Side Bows.....(2)	12.Bow Assembly.....(2)
6. Bow Assembly Brackets.....(2)	13.Tailgate Bar.....(1)
7. Threaded Knobs.....(4)	14.Disconnect Pins.....(6)
	Clips.....(8)

OMIX-ADA® TECHNICAL SUPPORT

PHONE: M-F 8am - 5pm EST 1-800-449-6649 | EMAIL: techsupport@omix-ada.com

FOR WARRANTY INFORMATION VISIT: www.Omix-Ada.com



OMIX-ADA, Inc.

460 HORIZON DR. SUITE 400 | SUWANEE, GA 30024 | PHONE: 770-614-6101 | FAX: 770-614-6069 | info@omix-ada.com

Complete Soft Top, TJ with Full Doors

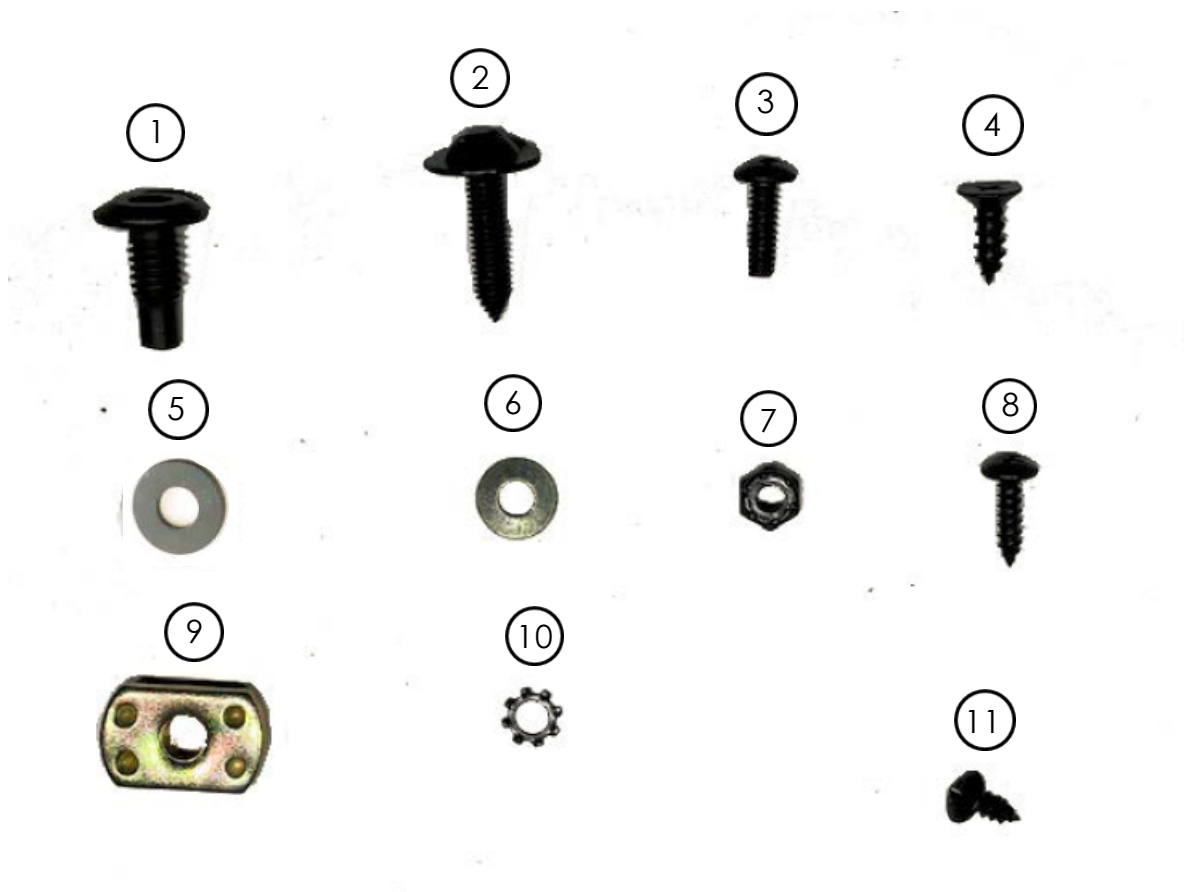

Components

1. 5/16" x 3/4" Torx Bolt.....(2)	7. #10 Lock Nut.....(4)
2. M6 x 25mm Torx Screw.....(4)	8. #8 x 5/8" Sheet Metal Screw.....(8)
3. 10 - 24 x 5/8" Phillips Machine Screw.....(4)	9. 5/16" Nut Insert.....(2)
4. #10 x 3/4" Sheet Metal Screw.....(2)	10. #10 Star Washer.....(4)
5. 5/16" Flat Washer.....(2)	11. Frame Sheet Metal Screw.....(2)
6. #10 Flat Washer.....(4)	

OMIX-ADA® TECHNICAL SUPPORT

PHONE: M-F 8am - 5pm EST 1-800-449-6649 | EMAIL: techsupport@omix-ada.com

FOR WARRANTY INFORMATION VISIT: www.Omix-Ada.com



460 HORIZON DR. SUITE 400 | SUWANEE, GA 30024 | PHONE: 770-614-6101 | FAX: 770-614-6069 | info@omix-ada.com

Complete Soft Top, TJ with Full Doors

IMPORTANT NOTICE

Carefully read instructions before attempting to install this product. Rugged Ridge is in no way responsible for any damage to the vehicle or personal injury that may occur during the installation or use of this product.

WARNING

This product is designed to enhance the appearance of the vehicle and only for protection against the elements. Do not rely on this product to contain occupants within the vehicle or to protect against injury during an accident.

WEAR SEAT BELTS AT ALL TIMES

SOFT TOP INSTALLATION TIPS

To help ease the installation, be sure to install the top when temperatures are above 70 degrees F. The material shrinks substantially at lower temperatures and may become difficult to install. The top may seem wrinkled when first installed, this is caused by the fabric becoming wrinkled in shipping. It will relax after a few days on the vehicle.





OMIX-ADA, Inc.

460 HORIZON DR. SUITE 400 | SUWANEE, GA 30024 | PHONE: 770-614-6101 | FAX: 770-614-6069 | info@omix-ada.com

Complete Soft Top, TJ with Full Doors

1. Windshield Channel Installation

Locate Windshield Channel and remove brackets. Save hardware for later use. Position Windshield Channel onto windshield and engage bracket. Secure Windshield Bracket assembly with hardware removed in this step.

WARNING: Ensure Windshield Channel is properly secured prior to installing the Soft Top. Damage to the vehicle or personal injury may occur if Windshield Channel is not securely mounted. Rugged Ridge is not responsible for personal injury or damage to the vehicle if Windshield Channel is not secured properly.

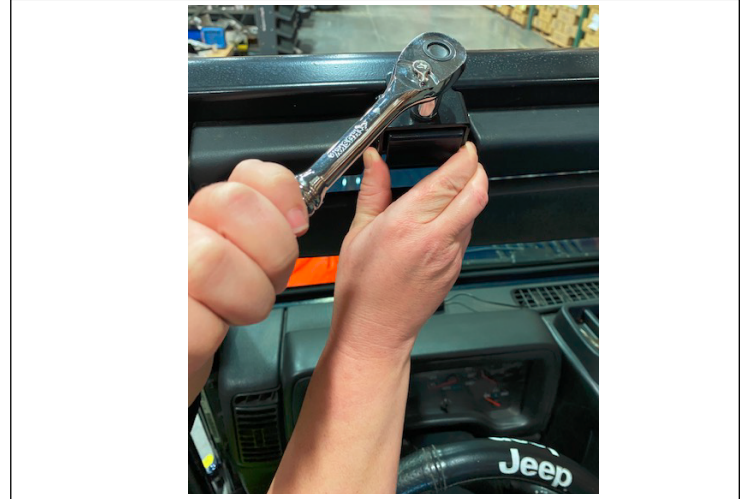

2. Door Surround Installation

Locate Driver Side Door Surround, Front and Rear Door Surround Bracket, (4) #8 x 5/8" Sheet Metal Screws. Attach Front and Rear Brackets to Door Surround with the hardware listed in this step.

NOTE: The Threaded Nipple on both brackets should face up and towards the inside of the vehicle.



3. Orient Door Surround Assembly on the vehicle with the Brackets towards the inside of the vehicle. Line up the Threaded Nipples with the holes on the bottom of the roll bar. Secure the Door Surround Assembly to the roll bar by inserting Knobs from the top of the roll bar until it reaches the Threaded Nipples. Do not tighten at this time.





OMIX-ADA, Inc.



460 HORIZON DR. SUITE 400 | SUWANEE, GA 30024 | PHONE: 770-614-6101 | FAX: 770-614-6069 | info@omix-ada.com

Complete Soft Top, TJ with Full Doors

4. Locate (1) 5/16" x 3/4" Torx Bolt, (1) 5/16" Flat Washer, and (1) 5/16" Nut Insert. Secure the bottom of the Door Surround to the vehicle by using the hardware listed in this step. Tighten hardware listed on Step 3 & 4 at this time.

Repeat steps 2-4 for opposite side.



5. Bow Assembly Installation

Locate Driver side Bow Assembly Bracket and (2) M6 x 25mm Torx Screws. Unzip side center roll bar cover and mount Bracket by using the hardware listed in this step.

NOTE: Slits on the roll bar cover should match the Bracket. Close the zipper once the bracket is attached to the roll bar.

NOTE: Some trimming may be required.



6. Locate (1) Side Bow and (2) Billet Disconnect Pin w/ Clips. Attach top section of the Side Bow to the Rear Door Surround Bracket and secure it with Billet Disconnect Pin.

NOTE: Hole on the Side Bow should be on top. To ease the installation of the Side Bow, it is very important to install the Side Bow to the Door Surround Rear Bracket first.

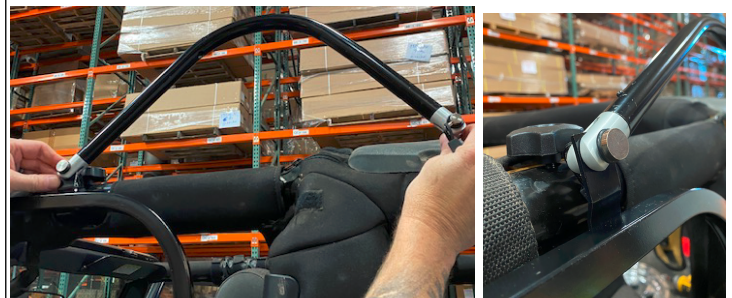



OMIX-ADA, Inc.



460 HORIZON DR. SUITE 400 | SUWANEE, GA 30024 | PHONE: 770-614-6101 | FAX: 770-614-6069 | info@omix-ada.com

Complete Soft Top, TJ with Full Doors

7. Once the top of the Side Bow is secured, attach opposite side of the Side Bow to the upper hole on the Bow Assembly Bracket. Secure it with the Billet Disconnect Pin w/ Clip.



8. Locate (2) Connection Tubes, Left and Right Bow Assembly and lay them on a flat clean surface and identify the Front and the Rear Bow.

NOTE: The Front Bow has one pin on each side.

Assemble the two halves of the Bow Assembly using the included Connection Tubes with the push buttons.

NOTE: It may be helpful to use a screw flat driver to push down the buttons while sliding Bow halves together. Also, it may be helpful for two persons to slide both sides of the Bow Assembly forward simultaneously.

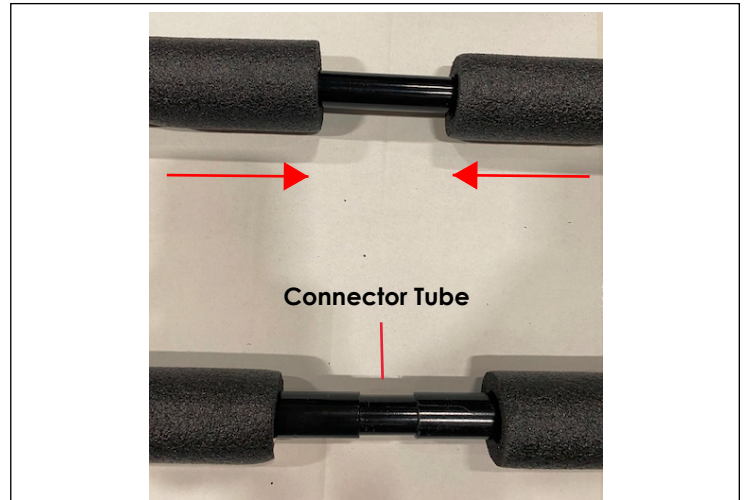

9. Slide Bow Leg into Rear Bow Assembly. Line up holes on the Leg and the Bow Assembly then secure them together by provided frame sheet metal screws. Repeat this step for opposite side.

Once the Bow Assembly is fully assembled, place it on the back of the vehicle. Line up the holes on the Bow Legs to the lower hole on the Bow Assembly Bracket. Secure them by inserting Billet Disconnect Pin.

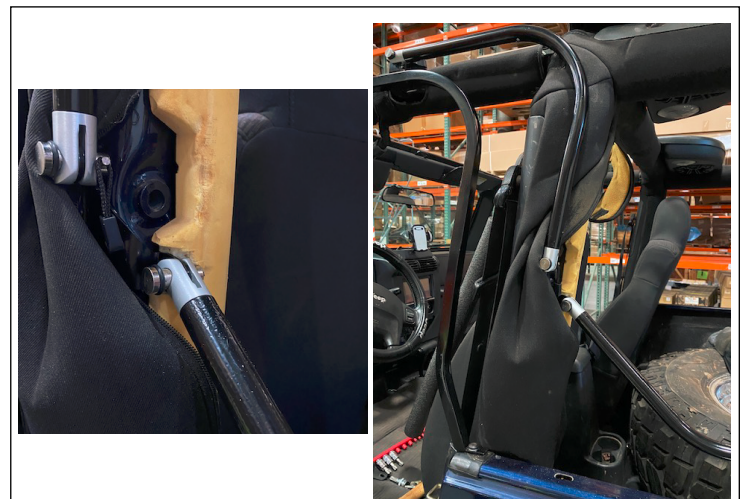



OMIX-ADA, Inc.



460 HORIZON DR. SUITE 400 | SUWANEE, GA 30024 | PHONE: 770-614-6101 | FAX: 770-614-6069 | info@omix-ada.com

Complete Soft Top, TJ with Full Doors

10. Move the Bow Assembly to the front of the vehicle. Insert post into the hole on the door surround and secure it with the Cotter Pins provided.



11. Tailgate Bracket Installation

Locate the Passenger Tailgate Bracket, (2) #10 - 24 x 1/2" Phillips Machine Screws, (2) #10 star lock washers, (2) #10 flat washers and (2) #10 - 24 Nyloc Nuts. In some cases the holes on the Tailgate Bracket will line up with the existing holes. In this case, use the existing holes as pilots to drill 3/16" holes on the vehicle.

NOTE: Carefully check under the drilling area to be sure you do not drill into any concealed wiring.

NOTE: If you are replacing a hardtop, use the Tailgate Bracket as a template to drill the 3/16" holes. Position the Tailgate Bracket and secure it by using the hardware listed in this step. Repeat this step for opposite side.

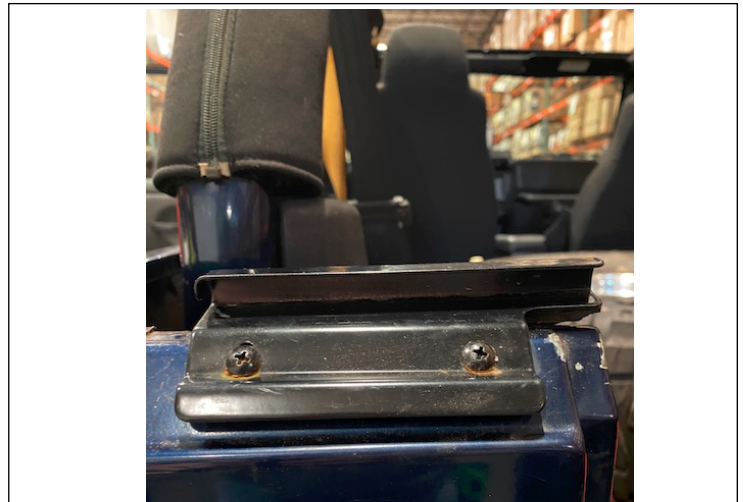

12. Fabric Replacement Top Installation

Locate the Soft Top, remove rear and quarter windows from the top. Once you have removed the windows orient Soft Top on the vehicle.

Secure the Main Skin to the center and rear Bow Assembly.

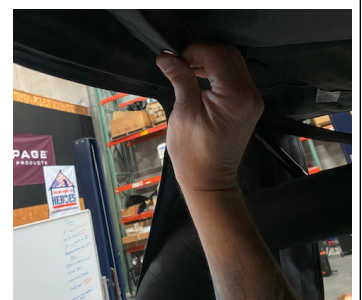
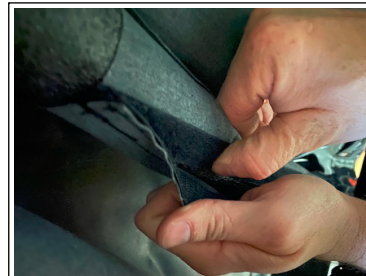



OMIX-ADA, Inc.

460 HORIZON DR. SUITE 400 | SUWANEE, GA 30024 | PHONE: 770-614-6101 | FAX: 770-614-6069 | info@omix-ada.com

Complete Soft Top, TJ with Full Doors

13. Insert the front of the Soft Top into the Windshield Channel.

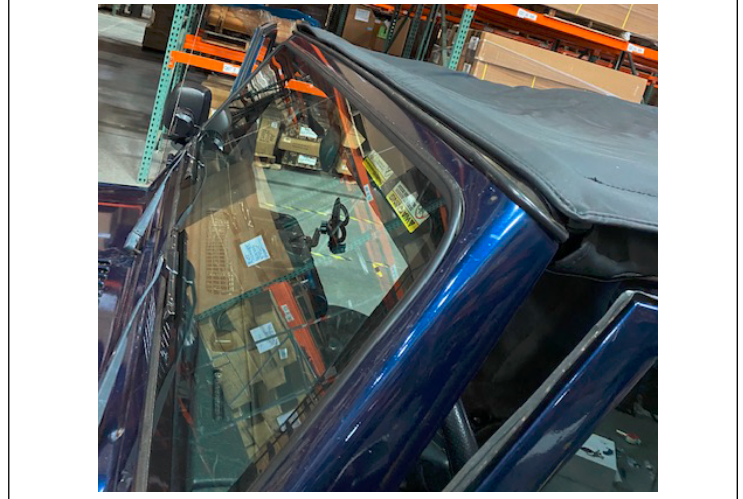

14. Insert the rear corners of the Soft Top into the rear corner belt rail.

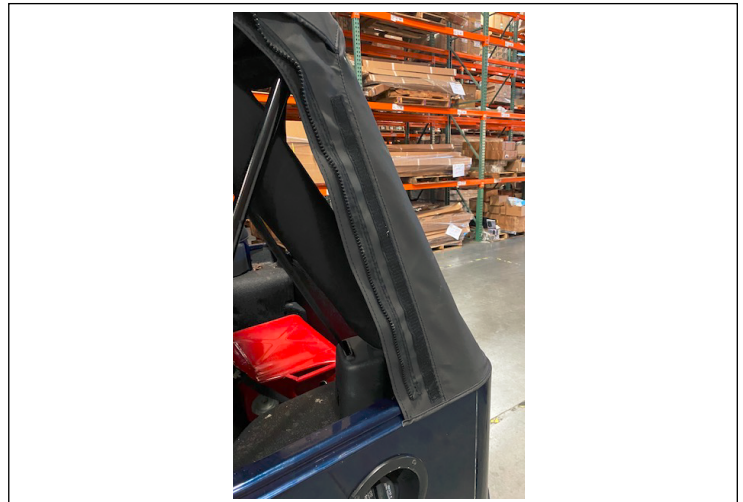

15. Start horizontal and vertical zippers on the quarter window about 4-6 inches. Insert the plastic strip on the bottom of the quarter window into the Side Belt Rail.

NOTE: Start at one end of the strip and work along it to the other end. Close the horizontal and vertical zippers on the quarter window.

Wrap the front of the quarter window around Door Surround and secure it by hooking the Velcro together. Wrap overhead flap around Upper Door Surround and secure it by hooking Velcro together. Repeat this step for the opposite side.

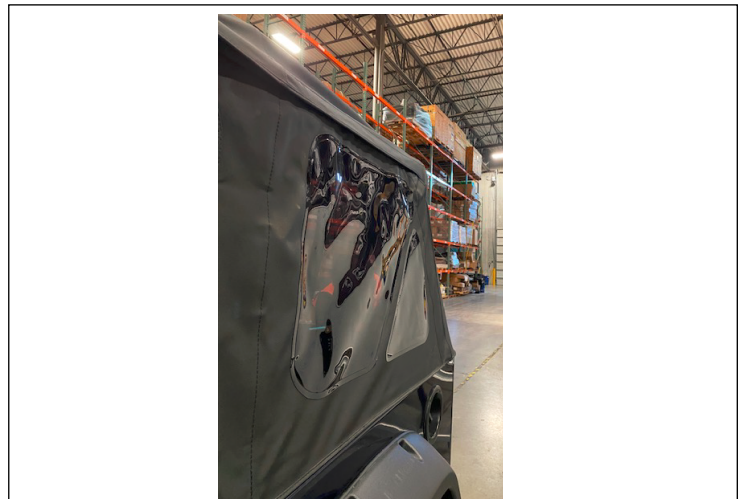



OMIX-ADA, Inc.

460 HORIZON DR. SUITE 400 | SUWANEE, GA 30024 | PHONE: 770-614-6101 | FAX: 770-614-6069 | info@omix-ada.com

Complete Soft Top, TJ with Full Doors

16. Rear Window/Tailgate Bar Installation

Pull both zipper pulls to the driver rear corner. Insert zipper slide into both zipper pulls then zip the rear window.

Close the rear window zippers and attach the bottom extrusion of the rear window to channel on the Tailgate Bracket.

NOTE: Tailgate Brackets are adjustable and need to be tightened periodically.

Push the Tailgate Bar into the top of the Tailgate Brackets.

Locate the Weather Stripping and attach it to the tailgate by inserting tailgate into channel on the Weather Strip.

NOTE: Make sure the Weather Strip is fully engaged before closing the tailgate.



Tips for Removing Soft Top

Remove all windows from the Soft Top and store them in the Storage Bag included.

Remove Soft Top and store it in the Storage Bag included.

To store the Bow Assembly behind rear seat, simply remove both clips from the Front Bow Assembly and carefully orient Bows behind rear seat.

NOTE: Bottom sides of the Rear Bow may need to be pushed in slightly towards the inside of the vehicle as you orient the bows behind the seat.