

# REDROCK<sup>4X4</sup>

## Throttle Body Spacer

J166362

### (1) Contents:

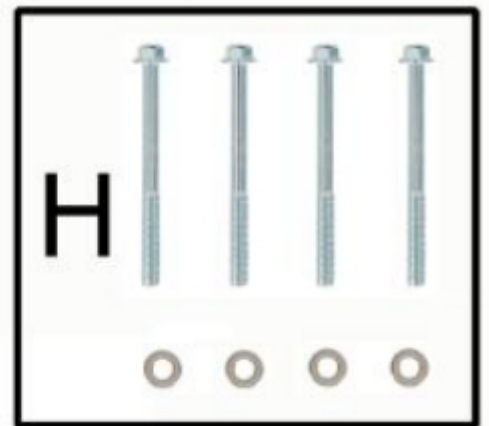
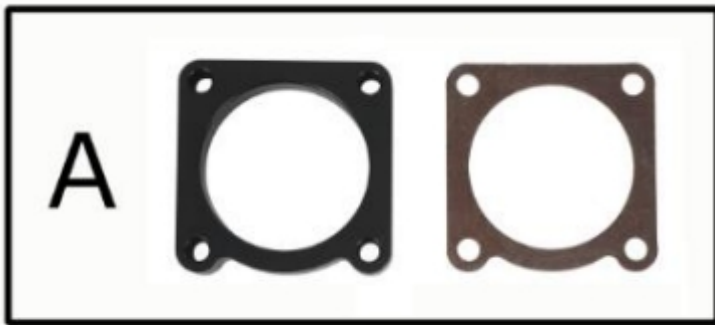

### (2) Tools required:

- 8mm Socket Wrench
- Flathead Screwdriver



### (3) Installation time:

About 40 minutes, 1-2 persons needed. Installation time is different according to your mechanical skill level.

(PLEASE VERIFY ALL PARTS ARE PRESENT AND READ INSTRUCTIONS CAREFULLY BEFORE STARTING INSTALLATION!)

### (4) Installation instruction:

**Step 1:** Disconnect the battery. Disconnect the Intake Air Temperature (IAT) sensor from the stock air inlet tube. Loosen the hose clamps from both sides of the air inlet tube and then remove the tube. Loosen the (4) 8mm bolts holding the throttle body to the intake manifold. Remove the throttle body. Disconnect the electrical connector from the bottom of the throttle body.

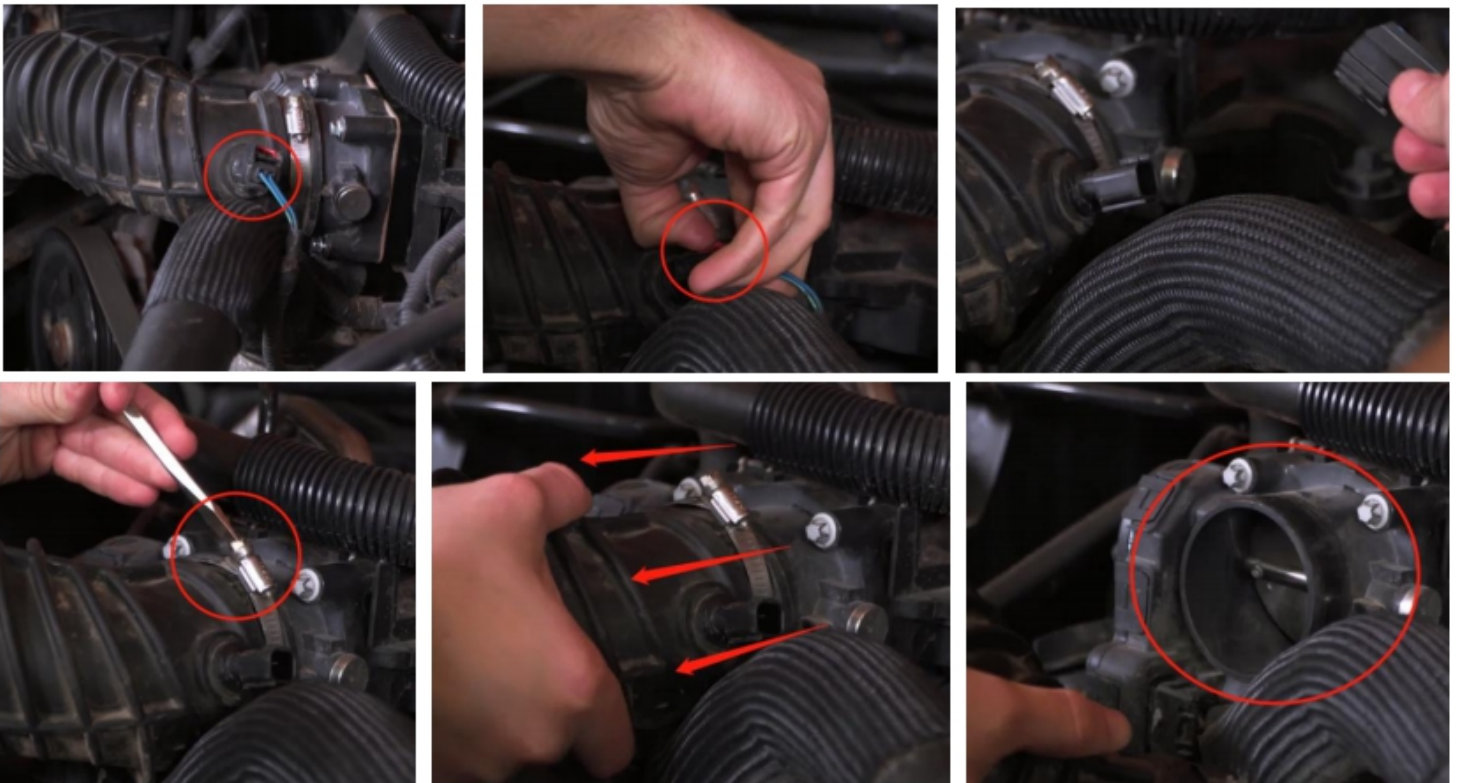

**Step 2:** Place the gasket on the backside of the throttle body followed by the spacer (Logo up, rounded edge to the right). Place the supplied bolts and washers through the front of the throttle body going through both the gasket and throttle body spacer. Take the

assembly and place the lower right bolt into the intake manifold and then rotate and align the assembly placing the other bolts into the intake manifold.

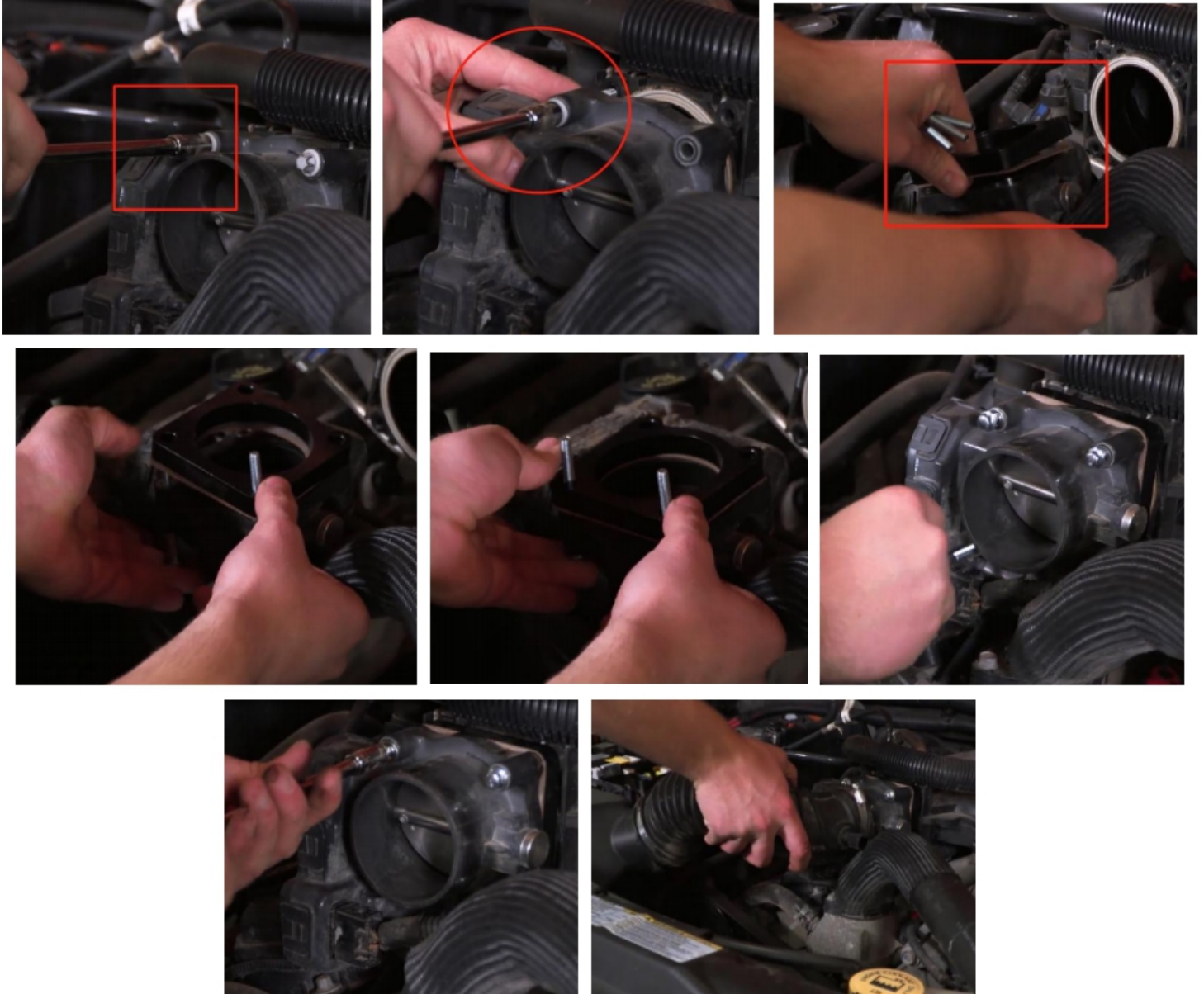

**Step3:** Tighten bolts in a criss-cross pattern to 8 ft-lbs. Reconnect electrical connector to the bottom of the throttle body; install the air inlet tube followed by the air intake temperature sensor.



*Notes: Don't over tighten the bolts. If the bolts are over tightened the throttle body can be damaged.*

**Step 4:** The installation is complete.

