



INSTALLATION GUIDE

Direct-Fit Pod Lights, Fits 2021+ Ford Bronco with Modular Bumper
SKU: BNLT-BR-21M-FG4

TABLE OF CONTENTS

1. RESOURCES & CONTACT INFO

2. EXPLODED VIEW

3. IMPORTANT SAFETY INFORMATION

REQUIRED TOOLS

INSTALL TIME & DIFFICULTY

INSTALLATION INSTRUCTIONS

11. DISPOSAL & WARRANTY INFORMATION

RESOURCES & CONTACT



CALL 1.877.466.4744

CUSTOMER SERVICE HOURS: MON-FRI 9:00AM-7:00PM EST



@BORNEOFFROAD



@BORNEOFF-ROAD



BORNEOFFROAD



@BORNEOFFROAD



ENGINEERING BLOG

WWW.BORNE.COM/ENGINEERING

PARTS BREAKDOWN

PART NUMBER	DESCRIPTION	QTY
MM10090-33SU	POD LIGHT - SPOT BEAM	2
MM10090-33FU	POD LIGHT - FLOOD BEAM	2
MM2501-33.1	LIGHT BRACKET	4
MM2524-01	BRACKET 1	1
MM2524-02	BRACKET 2	1
B6X1.0-14	M6 BUTTON HEAD BOLT	8
MM1174-26	M6 LOCK WASHER	8
MM1649-02	M6 FASTENER CAP	8

PARTS BREAKDOWN

PART NUMBER	DESCRIPTION	QTY
H8X1.25-25	M8 HEX BOLT	4
MM1163-33	M8 LOCK NUT	4
MM10158-01	HARNESS CLIP (NOT SHOWN)	2
MM2501-02	HARNESS ADAPTER (NOT SHOWN)	2
MM10083	WIRE HARNESS (NOT SHOWN)	1
MM1164-01	ZIP-TIE (NOT SHOWN)	12
MM1290-05	ZIP-TIE TREE-CLIP (NOT SHOWN)	4

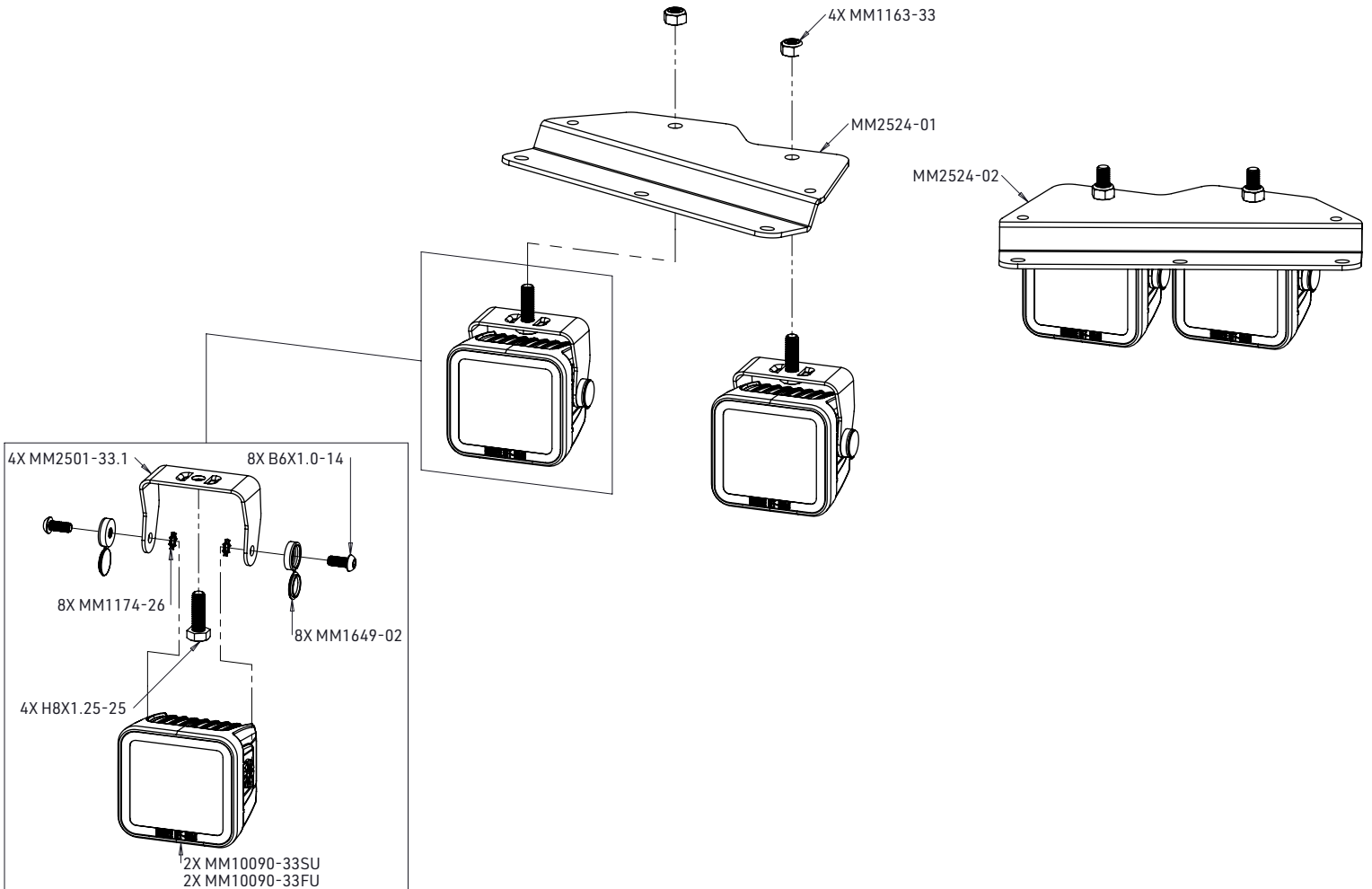

FOR QUESTIONS OR ASSISTANCE WITH YOUR BORNE OFF-ROAD PRODUCT, CONTACT US AT 1.877.466.4744 OR VISIT BORNE.COM

Continued on next page

IMPORTANT SAFETY INFORMATION

- ▶ Borne Off-Road recommends you use safety glasses and protective gloves during the installation of our products
- ▶ Raise vehicle only on jack stands or on a vehicle lift
- ▶ Allow vehicle to cool completely prior to attempting installation
- ▶ Borne Off-Road is not responsible for any vehicle damage or personal injury due to installation errors, misuse, or removal of Borne Off-Road products
- ▶ If you need any assistance while installing our products, reach out to our Customer Service Team at 1-877-GOMISHI

REQUIRED TOOLS

PANEL TOOL	8MM SOCKET
PAINTERS/MASKING TAPE	10MM SOCKET
ELECTRICAL TAPE	13MM SOCKET
METAL ROD OR FISH TAPE	T40 TORX
WIRE STRIPPER	4MM ALLEN WRENCH
DEUTSCH CLOSED BARREL TERMINAL CRIMP TOOL (FOR SIZE 12 TERMINAL)	SIDE CUTTERS
¼" RATCHET AND EXTENSION	LEVEL

INSTALL TIME: 3.5 HOURS

INSTALL DIFFICULTY: 

INSTALLATION INSTRUCTIONS

1. If equipped, remove the stock bull bar from the bumper (8x T40 Torx bolts)

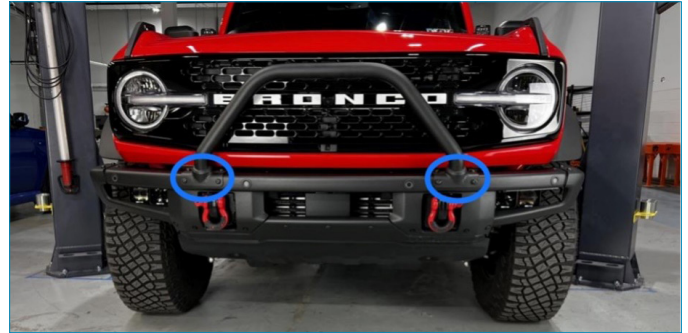

2. Remove the radiator cover. (9 pop clips)



3. Remove the bolts securing the grill to the grill support structure. (4x 10mm bolts)

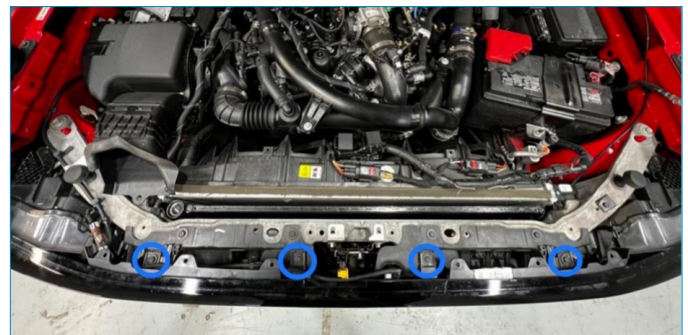

Continued on next page

4. If equipped, disconnect the electrical harness for the front camera and the fitting for the camera washer.



5. Locate the front three rotating fasteners securing the fender flares in place and turn them 90 degrees, then pull outward to partially remove them. Do this on both sides.



6. Apply masking tape to the front sections of both fenders as shown in the images below.

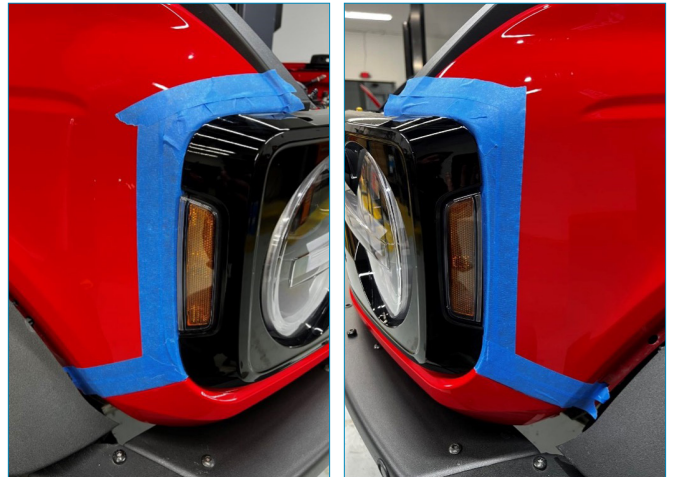

7. Carefully pull on both sides of the grill to unseat the grill from the grill support structure, then remove the grill from the vehicle.

8. Pull outward on the rear corners of the front fascia to unseat it from the clips that secure it to the fenders. Do this on both sides.



9. Unseat the front fascia from the clips that secure it to the grill support structure. Once fully unseated, remove the front fascia from the vehicle.

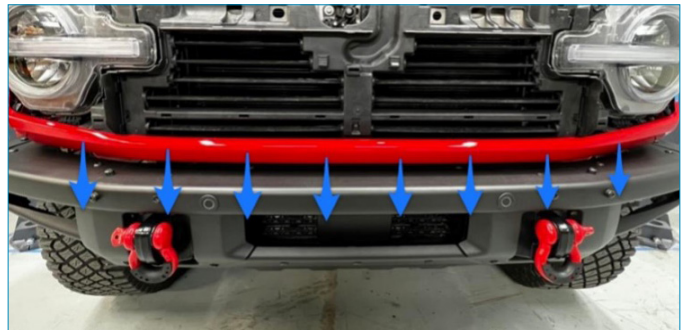

Continued on next page

If installing the light kit compatible with the factory switches, proceed to step 10. If installing a light kit using the non-Upfitter wiring harness, proceed to step 16.

10. The Upfitter auxiliary wires are located on the driver's side of the vehicle next to the brake booster. Locate the green with brown stripe wire (Aux 2) and trim the cap off the end. Once trimmed, strip approximately 1/4" of insulation off the wire. Once stripped, carefully insert the wire into the provided size #12 female closed barrel terminal, ensuring all strands make it into the terminal, then crimp it in place. This green with brown stripe wire corresponds to the auxiliary 2 Upfitter switch. The four pod lights draw approximately 13.5 amps at 12VDC, which means they must be connected to the auxiliary 1 or 2 circuits. (1x size #12 female closed barrel terminal)



11. Insert the green with brown stripe wire into position 2 of the provided large-sized male wire harness connector. A clicking sound will indicate that the terminal has been pressed far enough to engage with the locking tab inside the connector. Perform a visual inspection of the terminals from the front side of the connector. Ensure the locking rim of each terminal rests on the locking tab inside the connector. Once confirmed, insert the provided locking wedge into the center of the fitting. The wedge will be fully seated when it sits flush with the face of the connector. (1x locking wedge)

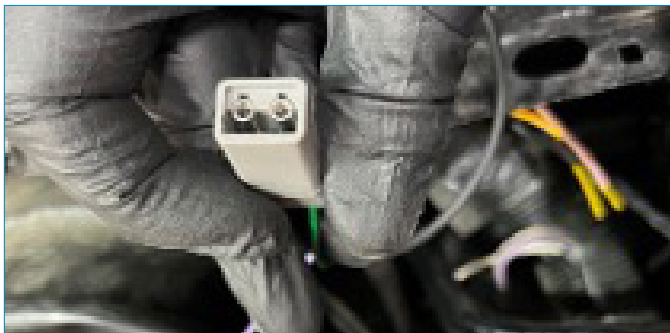

12. Secure the ground ring terminals to the chassis ground located above the brake booster. (1x 8mm Bolt)

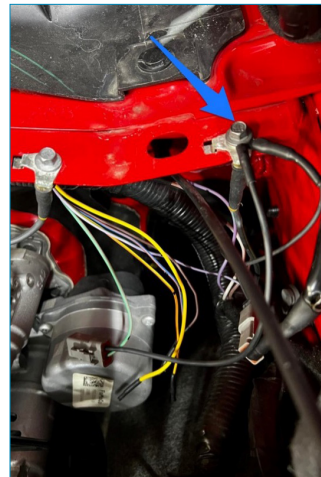

13. Connect the direct-fit wire harnesses to the connectors.



Continued on next page

14. Route the harnesses along the driver's side fender and down between the radiator and radiator support structure.



15. Once the connectors on the ends of the wire harnesses make it past the bottom of the grill support structure, carefully pull on the wire harnesses until the slack in the engine bay is removed. Proceed to step 26.



16. Remove the three female spade terminals from the two-position pod light switch. The female spade terminals have a locking feature that must be depressed to unlock them from the blades on the back side of the switch.

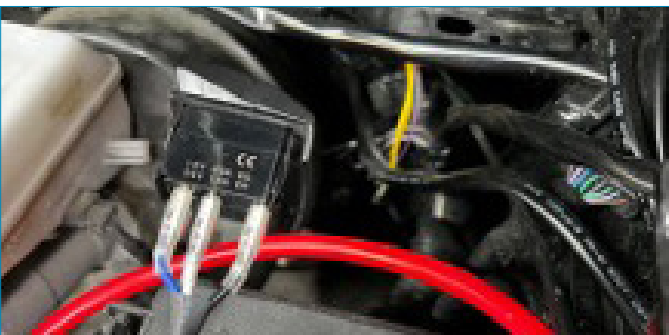

17. Tape the switch harness to a metal rod. Feed the harness inside the driver-side fender from the battery back to the cowl.



18. Feed the switch wiring harness through the driver's side of the firewall. For this installation, we drilled a hole in the rubber plug next to the brake booster to pass the wires through.



Continued on next page

19. Pull the remaining length of the switch wire harness through the firewall, then route the wiring to the desired switch mounting location. For this installation, we used the Borne Off-Road Bronco Direct-Fit Switch Panel, which mounts above the center console.



20. Feed the wires through the switch hole, then reconnect them to the switch, as shown in the diagram below. Once the wires are reconnected, install the switch into the mounting hole.

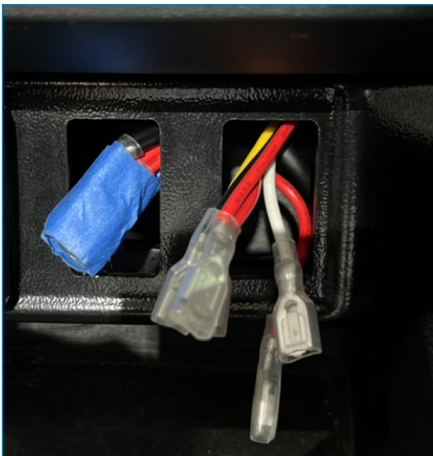

2 POSITION SWITCH: ON - OFF

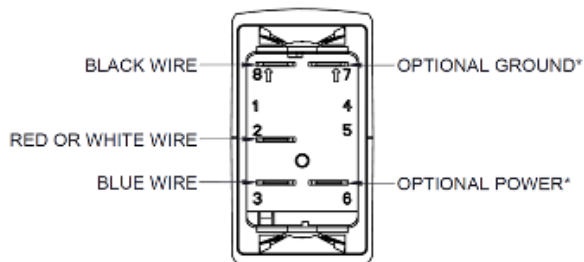

*TO ILLUMINATE BOTTOM HALF OF SWITCH. WIRING NOT INCLUDED.

21. Secure all loose wiring under the dashboard and driver-side footwell. The wires must be secured out of the way of the pedals, steering column, and any other moving components.

22. Find a suitable location to mount the wire harness relay. For this installation, we used our Borne Off-Road Bronco Direct-Fit Battery Relay Holder.

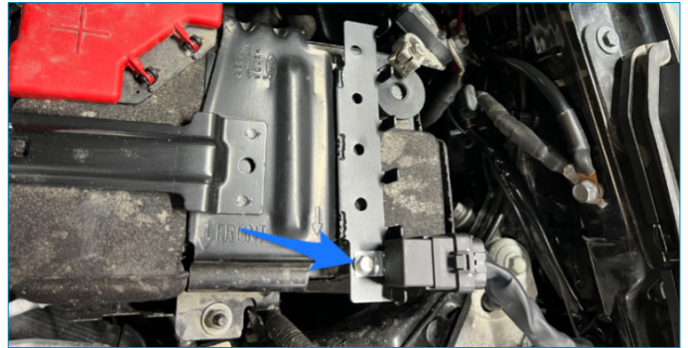

23. Connect the positive wire from the harness to a suitable power distribution point on the vehicle (this could be the battery if no other option is available). Connect the wire harness ground wire to a suitable chassis ground. For this installation, we used our Borne Off-Road Bronco Direct Fit Bus Bar Kit.



24. Route the harness down between the radiator and radiator support structure.



Continued on next page

25. Once the connectors on the end of the wire harness make it past the bottom of the grill support structure, carefully pull on the wire harness until the slack in the engine bay is removed.



26. Pass a metal rod or fish tape through the opening behind the upper section of the bumper, from the passenger's side to the driver's side. See the below images.

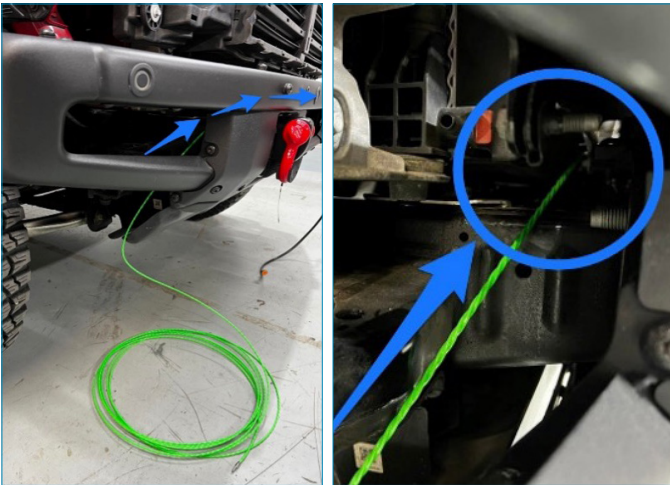

27. Securely tape the longer end of the wire harness to the end of the metal rod or fish tape, then carefully pull the wire through the back of the front bumper.

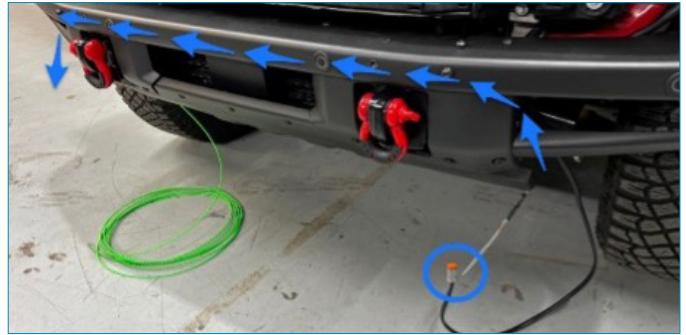

28. Remove the T40 Torx bolts from the outer bumper openings on each side of the front bumper. (6x T40 Torx bolts)



Continued on next page



29. Assemble the pod lights as shown in the above below

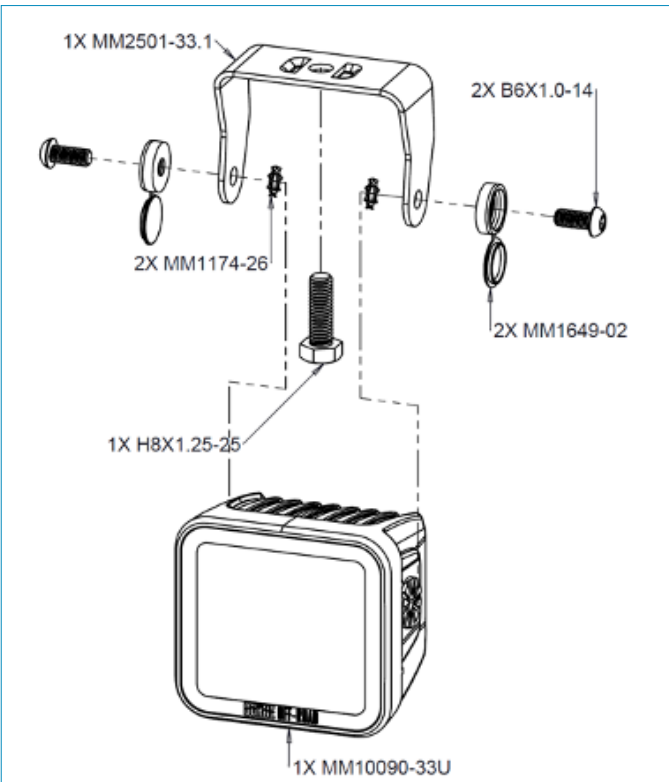

30. Install the pod light assemblies onto the passenger side bracket (MM2524-01) as shown in the below image.



31. Secure the pod light wire harnesses to the bracket as shown above using the provided zip-tie tree-clips and harness clip. Once the harnesses are secured in place, connect one of the provided adapter harnesses to the pod light harnesses. (2x MM1290-05, 1x MM10158-01, and 1x MM2501-02)

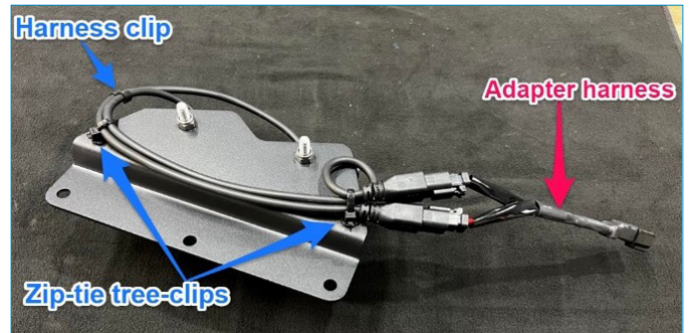

32. Repeat steps 30 and 31 to assemble the pod lights to the driver's side bracket (MM2524-02). (2x MM1290-05, 1x MM10158-01, and 1x MM2501-02)



Continued on next page

33. Connect the driver's side pod light assembly to the harness, then secure the bracket to the front bumper with three of the previously removed T40 Torx bolts.



34. Repeat step 33 for the passenger side pod light assembly. (3x T40 Torx bolts)



35. Use a level to adjust the lights as desired. Once adjusted, tighten the bolts securing the lights to the bracket.



36. Use the provided zip-ties to bundle up and secure all loose wires in place.

37. Reinstall the front fascia, then push it in place to engage all the clips.

38. Reinstall the grill, then push it in place to engage all the clips.

39. Reinstall the bolts to secure the grill to the grill support structure. (4x 10mm bolts)

40. If equipped, reconnect the electrical harness for the front camera and the fitting for the camera washer.

41. Reinstall the radiator cover. (9x pop clips)

42. If equipped, reinstall the stock bull bar. (8x T40 Torx bolts)

Continued on next page

DISPOSAL INSTRUCTIONS

- › Do not dispose of any product as unsorted municipal waste. Use separate collection facilities. Contact your local authority for information regarding the collection systems available.
- › Never improperly dispose of any coolant, oil, or other chemicals.

VIEW WARRANTY INFO



WARNING
Cancer and
Reproductive Harm
www.P65Warnings.ca.gov



- › This product can expose you to chemicals which are known to the state of California to cause cancer. For more information visit:

www.p65warnings.ca.gov